

10140

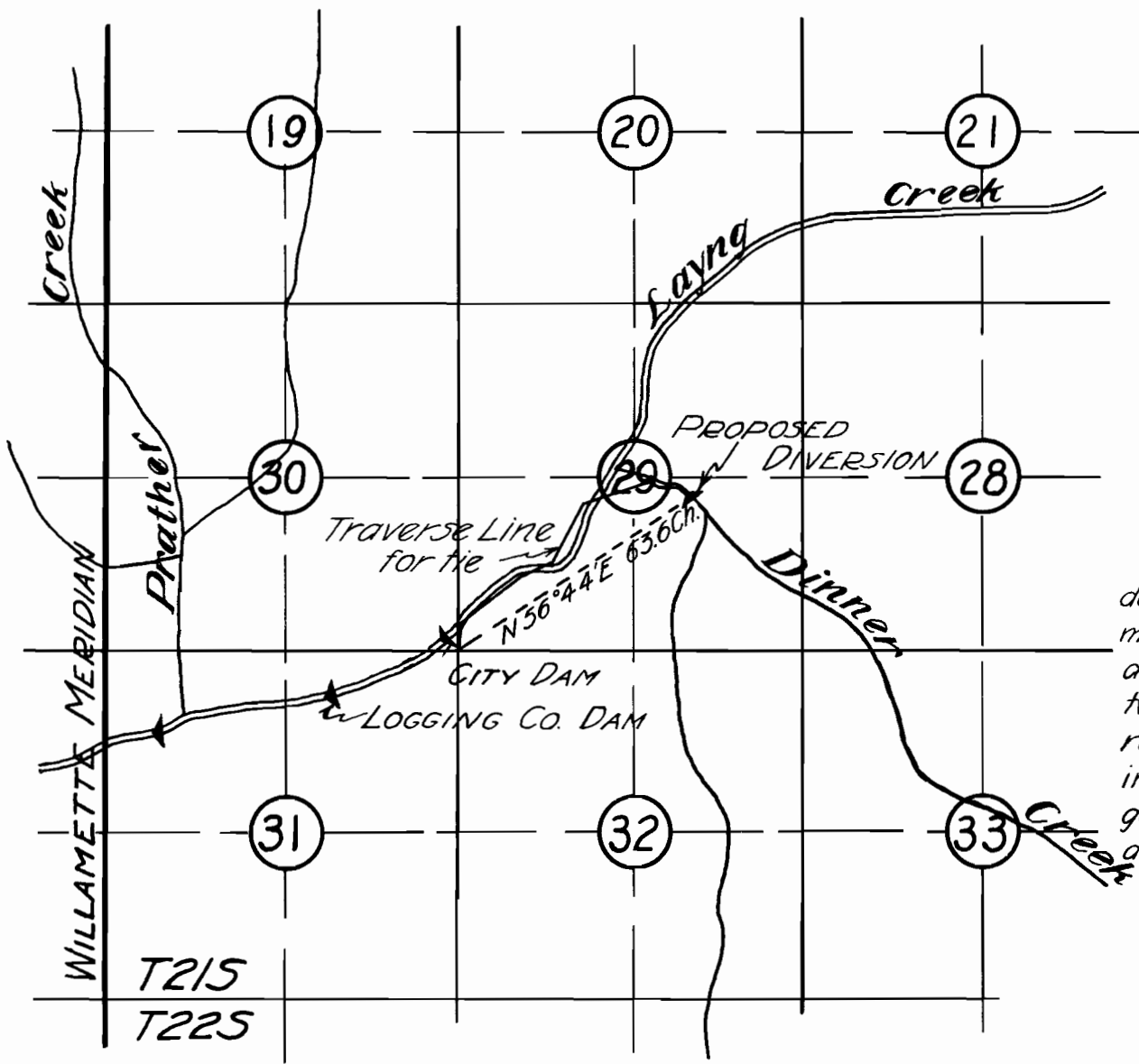

MAP SHOWING  
 LOCATION OF PROPOSED POINT  
 OF DIVERSION FROM  
 DINNER CREEK  
 FOR  
 COTTAGE GROVE WATER SUPPLY  
 Scale 2" = 1 mile April 4, 1925

I, H.S. Rogers, of Corvallis, Oregon do hereby certify that this map was made from notes taken during an actual survey made by me on March twenty eighth, 1925, and that it correctly represents the works described in the accompanying application together with the location of streams and other ditches in the immediate vicinity.

H.S. Rogers  
 Registered Professional Engineer

Oregon No. 1220

July 8, 1921  
 Date of Registration

Application No. 10140  
6822