

W. H. STEENS' POWER AND IRRIGATION SYSTEM

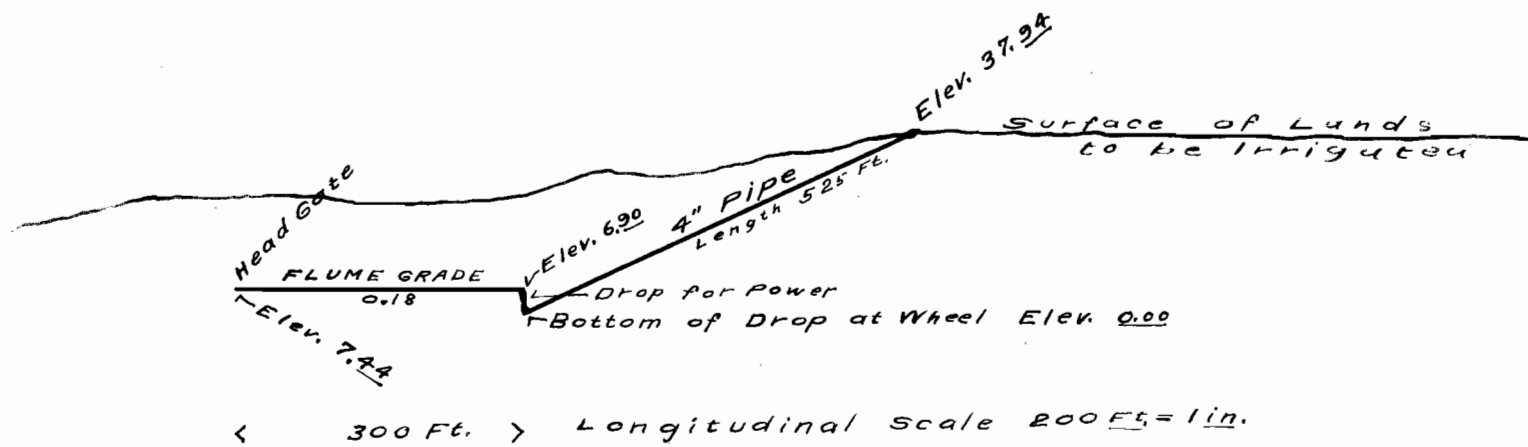

OFFICE OF THE ENGINEER  
BUREAU OF RECLAMATION  
WASHINGTON, D. C.  
MAY 13 1911  
SAINT LOUIS, MO.

Application No. 1427  
Serial No. 685

I J. W. Kimbrell of Pendleton Or. do hereby certify that this map was made from notes taken during an actual survey made by me on Feb. 6 1911, and that it correctly represents the works described in the accompanying application, together with the location of streams and other ditches in the immediate vicinity, and has written thereon the area in each smallest legal subdivision which it is proposed to irrigate.

John W. Kimbrell  
Surveyor

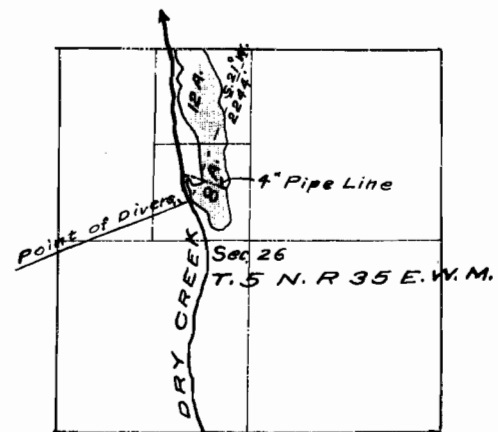

True Meridian  
Variation 21°