

10299

STATE ENGINEER  
RECEIVED

AUG 5 - 1925

SALEM, OREGON

MAP TO ACCOMPANY  
WATER APPLICATION  
of  
Thos. Young.  
Pendleton - Oregon.

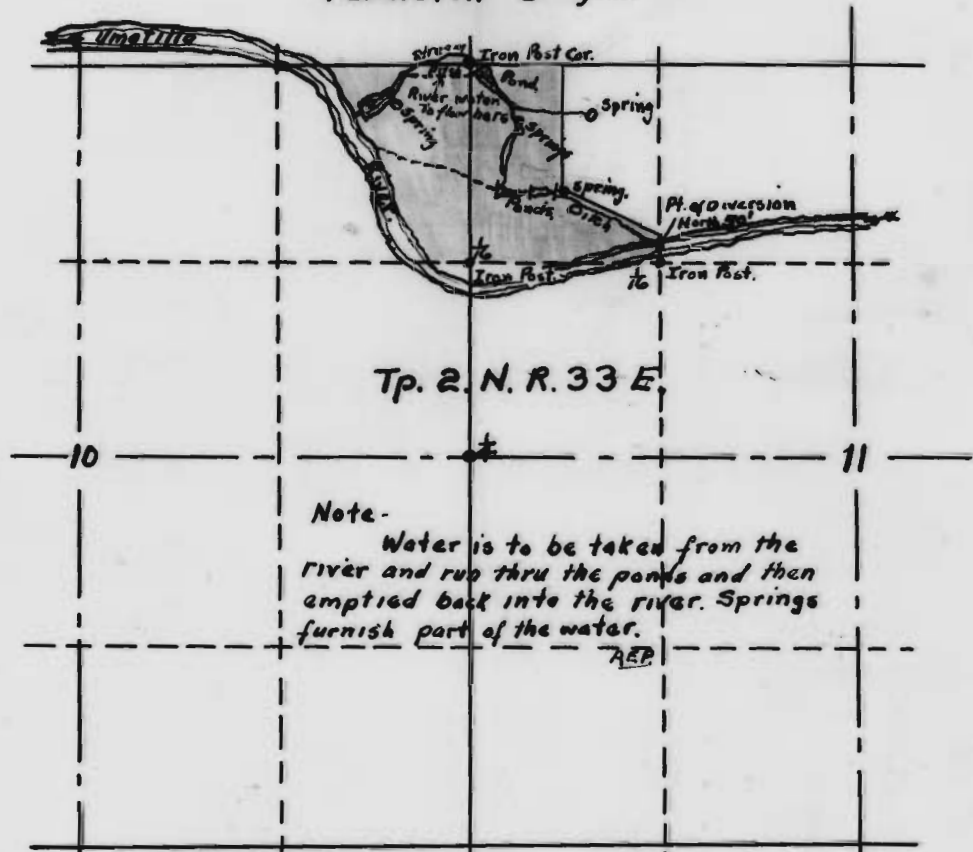

Note -  
Water is to be taken from the  
river and run thru the ponds and then  
emptied back into the river. Springs  
furnish part of the water.

AEP

Application No. 10299

Permit No. 6895