

— Map —

Accompanying Application of L. A. WHITLEY of Trail,  
Jackson County, for permit to the waters of Elk Creek  
tributary to Rogue River, Jackson County, Oregon.  
for the purpose of Irrigation, of lands as shown on plat.

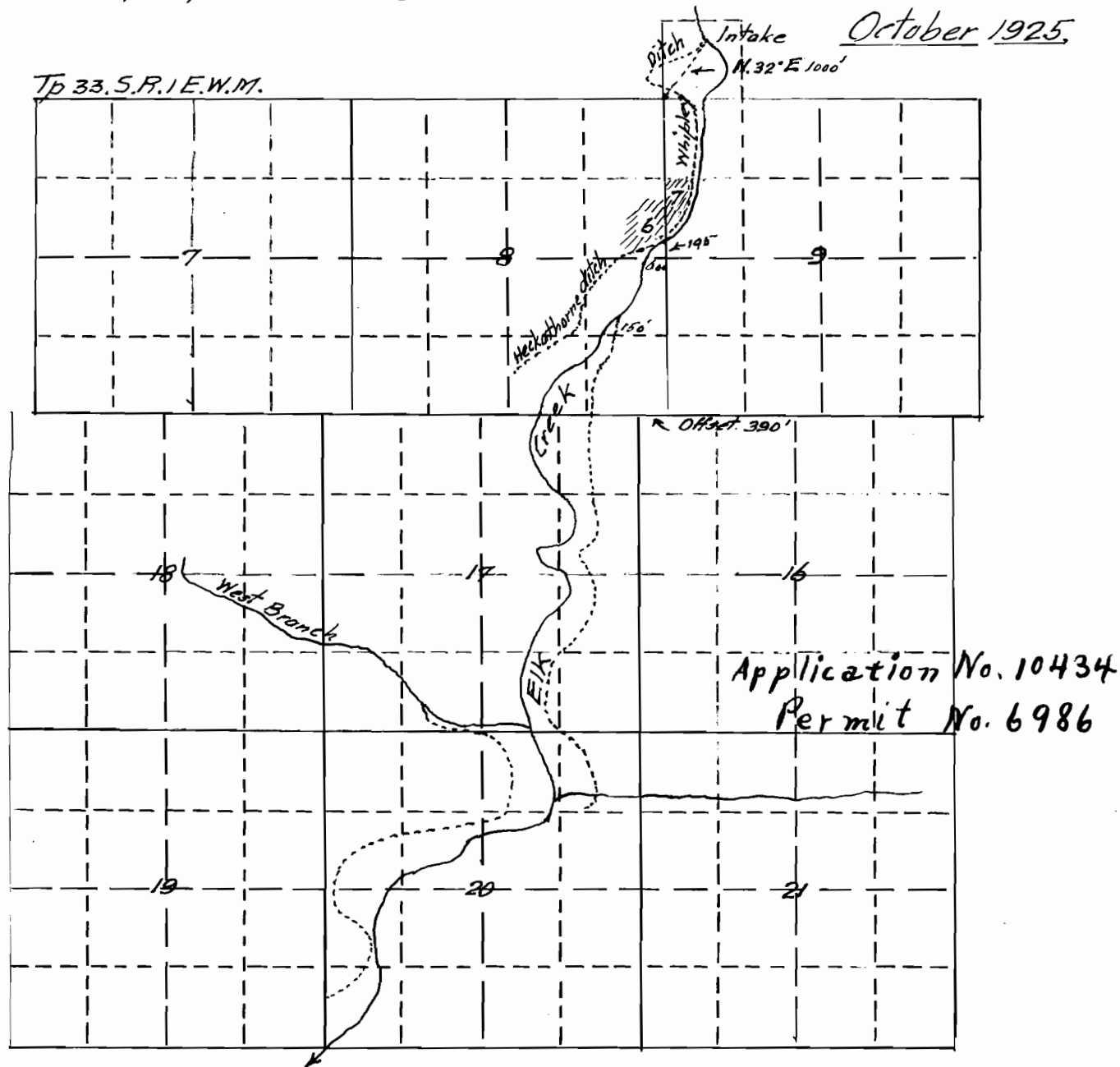

Map compiled from plat furnished by L. A. Whitley  
of his lands, and plats of Office records, the same  
showing correct location of lands to be irrigated,  
together with streams and ditches in immediate  
vicinity.

Fred. N. Cummings. C.E.