

Township 1 S.,

Range 2 E. T. M.

50401

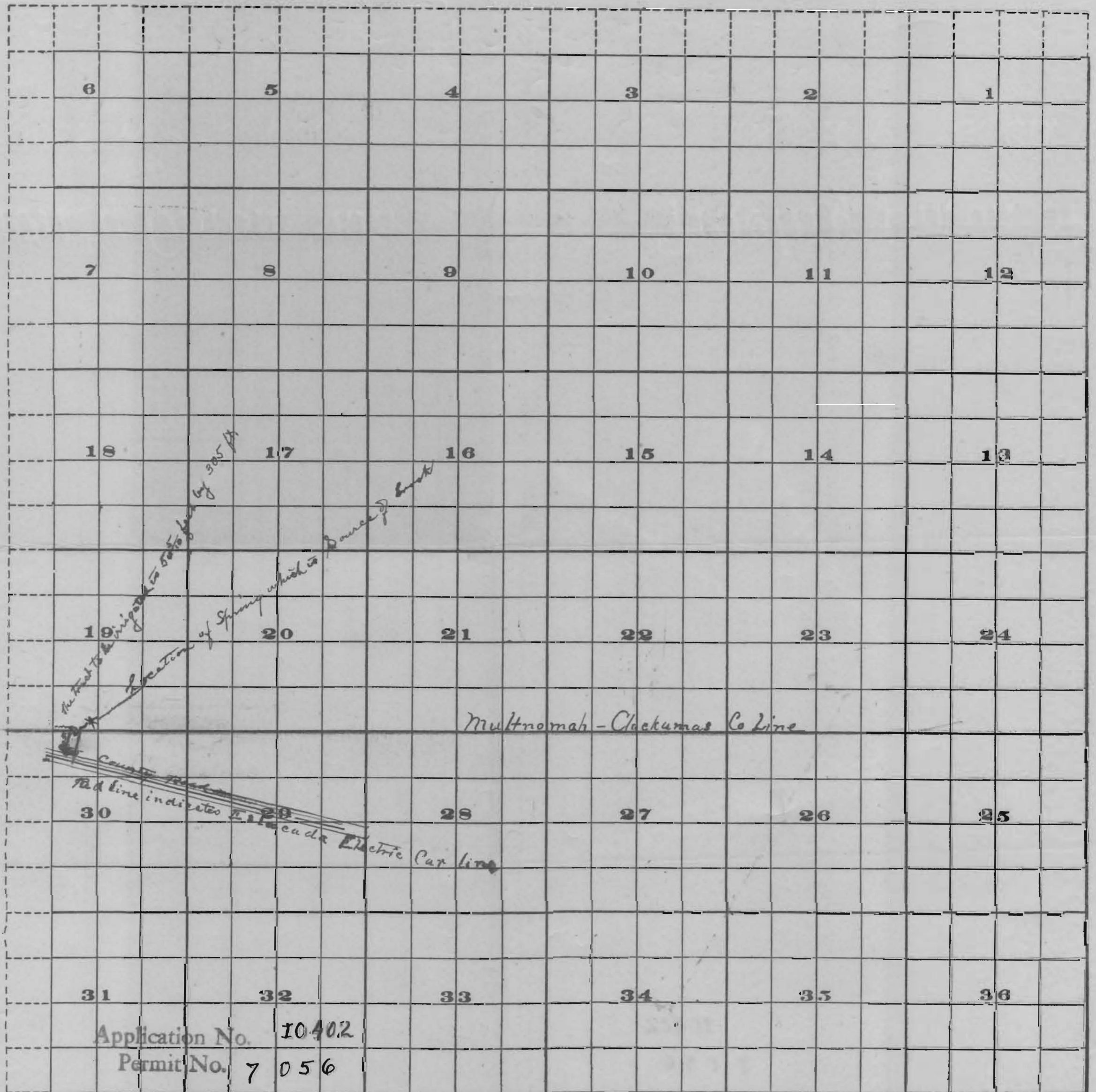

SALEM, OREGON

SEP 22 1925

STATE ENGINEER RECEIVED

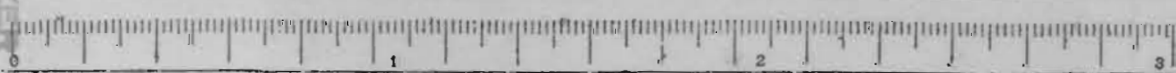

Scale of Feet.

50401

50401

Gibson's Subdivision
of the J.A. Logan Tract in Sec's 19 & 30
T.1 S. R. 2 E. W.M.

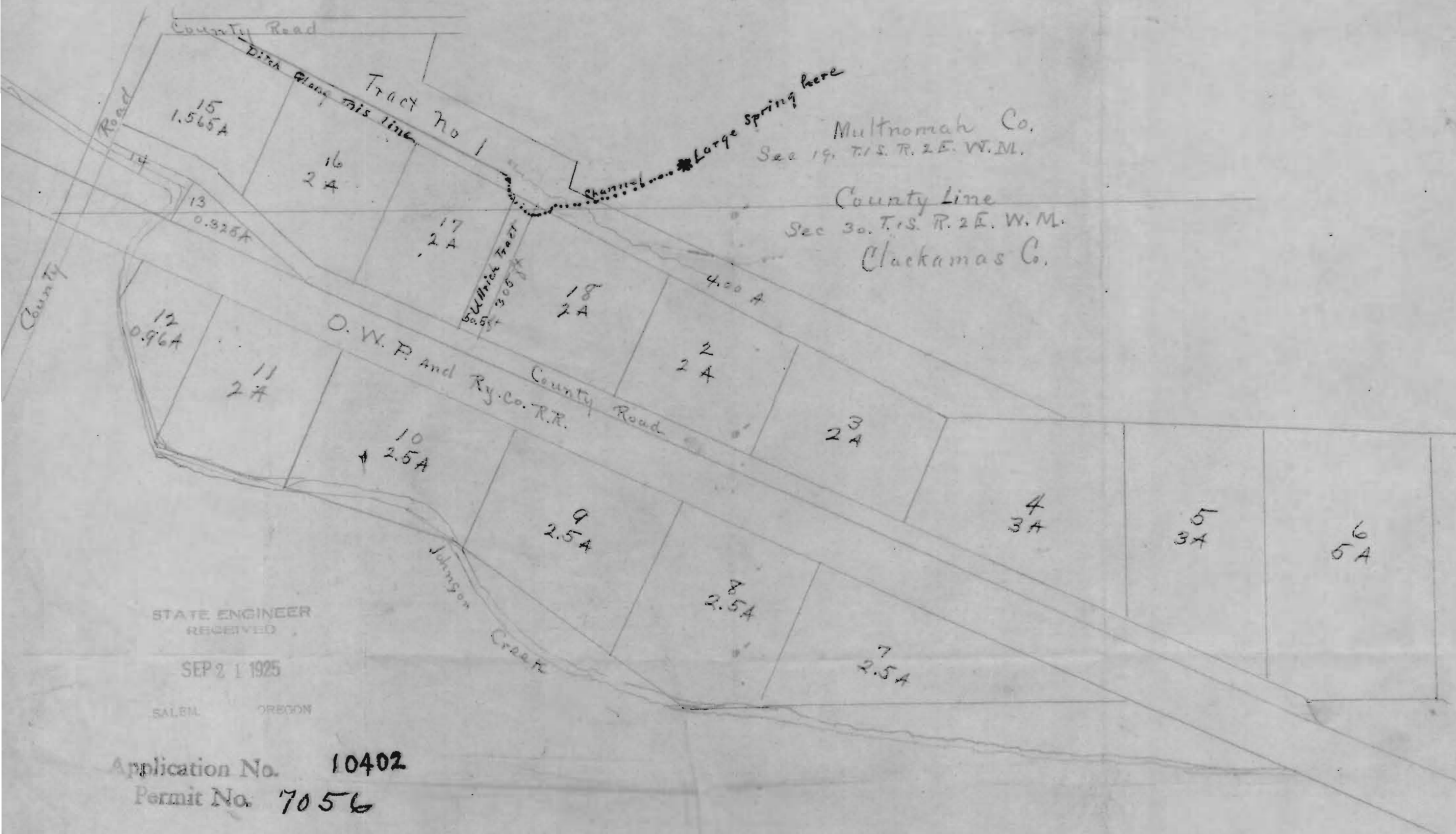

STATE ENGINEER
RECEIVED

SEP 21 1925

SALEM OREGON

Application No. 10402
Permit No. 7056