

STATE ENGINEER  
RECEIVED

MAR 13 1925

SALEM, OREGON

Sec. 33, T40 S., R. 13 W. W.M.

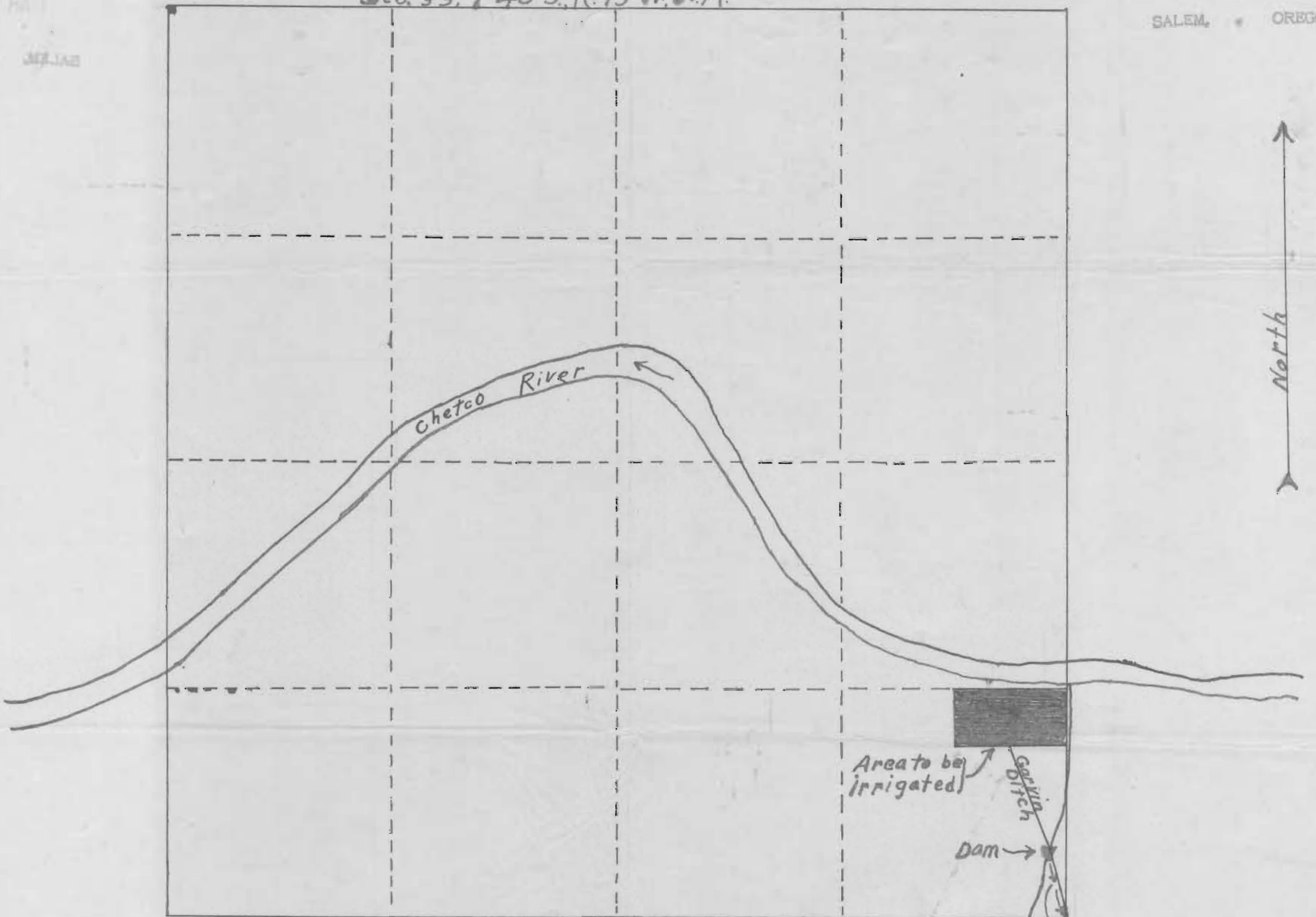

Area to be irrigated

Garvin Ditch

Dam

SLOPE 400 feet

Carey Creek

Map accompanying Application  
of D. I. Garvin for Waterright  
Permit to use the Waters  
of Carey Creek for  
Irrigation Purposes

Scale: 8 inches = 1 mile.

Application No. 10035  
Permit No. 7102

app # 10035  
Per 7102

10035

STATE ENGINEER  
RECEIVED  
MAR 13 1925  
SALEM, OREGON

10035