

MAP

OF

GELLATLY IRRIGATION SYSTEM

W.C. Galloway Dept. County Engineer

April 12, 1911.

Tp. 12 S. R. 6 W. W. M.

Scale 1" = 40 chs.

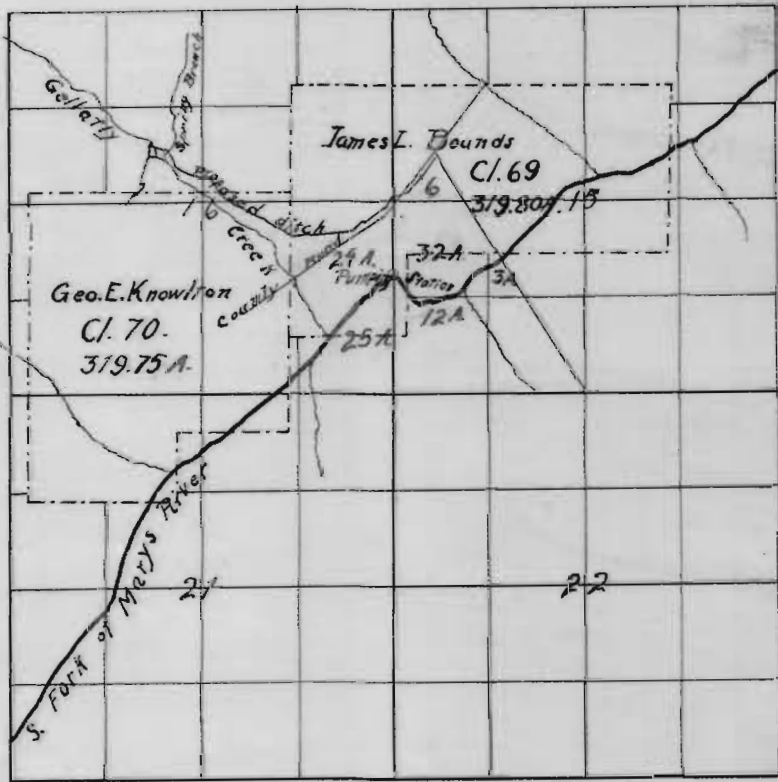

Traverse of Ditch Line

Sta. 0; Beginning at a point 833 chs. North and 25.46 chs. West of the N.E. corner of Geo. E. Knowlton D.L.C. #70 in Tp. 12 S. R. 6 W. W. M. in Benton County, Ore.

Sta.	Bearing	Distance (Ft.)	Notes
0-1	S. 26° 50' E.	219	
1	S. 16° 41' E.	90	
2	S. 61° 55' E.	128	
3	S. 58° 16' E.	46	
4	N. 89° 13' E.	94	
5	S. 54° 01' E.	36	
6	S. 31° 32' E.	63	
7	S. 47° 13' E.	122	
8	S. 48° 25' E.	126	
9	S. 69° 18' E.	70	
10	S. 32° 16' E.	74	
11	S. 20° 25' E.	64	
12	S. 52° 48' E.	88	
13	S. 82° 35' E.	40	
14	S. 32° 47' E.	48	
15	S. 39° 58' E.	73	
16	S. 53° 29' E.	188	
17	S. 76° 35' E.	175	
18	N. 88° 42' E.	101	
19	S. 63° 30' E.	108	
20	N. 78° 48' E.	84	
21	S. 62° 55' E.	117	
22	N. 82° 58' E.	181	
23	S. 78° 23' E.	104	
24	N. 84° 15' E.	285	
25	N. 85° 25' E.	268	
26	N. 50° 29' E.	140	
27	S. 87° 36' E.	54	
28	N. 58° 30' E.	374	
29	N. 28° 30' E.	122	
30	S. 65° 55' E.	41	
31	N. 60° 30' E.	225	crosses road
32	N. 38° 27' E.	234	
33	N. 36° 16' E.	483	
34	N. 74° 50' W.	187	to Gellatly Creek

Grade of ditch .10' to 100 Ft.

Water taken out at sta. 22 for power, which point is 9.55 chs. South of said D.L.C. cor.  
 Power plant being 16.30 chs. South and .72 chs. East of said D.L.C. cor.  
 Water enters Gellatly Creek 18.87 chs. South and 1.14 chs. East of said D.L.C. cor.  
 Pumping plant to be 16.60 chs. South and 21.29 chs. East of said D.L.C.  
 Water to be pumped from Marys River.  
 Grade elevation at sta. 0 100' B.M. on maple 24" dia. S. 50° W. .05 chs.

Cross section of Gellatly Creek

Scale 1" = 10'



Cross section of spring branch

Scale 1" = 10'



Certificate of Surveyor.

I W. C. Galloway, of Corvallis, Benton County, Oregon, do hereby certify that this map was made from notes taken during an actual survey made by me on the 30<sup>th</sup> and 31<sup>st</sup> days of March and 1<sup>st</sup>, 4<sup>th</sup>, 5<sup>th</sup> and 6<sup>th</sup> days of April 1911, and that it correctly represents the works described in the accompanying application, together with the location of streams and other ditches in the immediate vicinity, and has written thereon the areas within each 40 acre tract it is proposed to irrigate.

W. C. Galloway

Deputy County Eng.

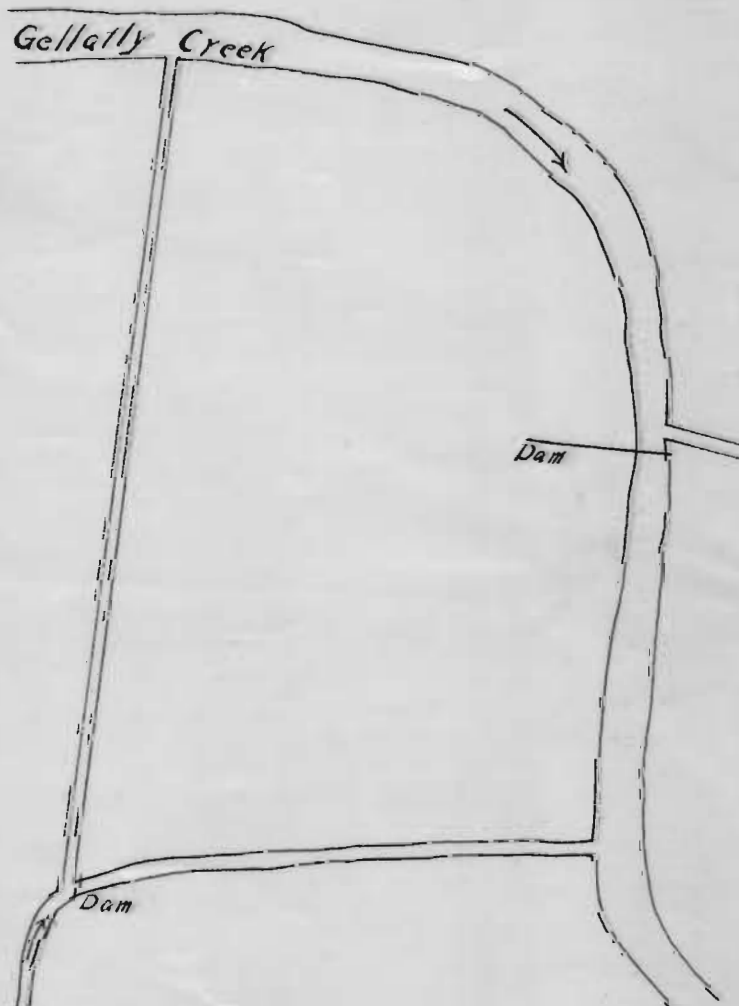

OFFICE OF STATE ENGINEER  
 RECEIVED  
 APR 14 1911  
 SALT LAKE, UTAH

Application No. 1264  
 Permit No. 711

Sketch of head of ditch line  
 scale 1" = 20'

OFFICE OF STATE ENGINEER  
 RECEIVED  
 APR 14 1911  
 SALT LAKE, UTAH