

ENGINEER
RECEIVED

DEC 22 1925

Application No 10526
Permit No. 7115

$\frac{1}{4}$ Sec. COR.
between Secs.
7 & 8

KAY KENDALL D.L.C.

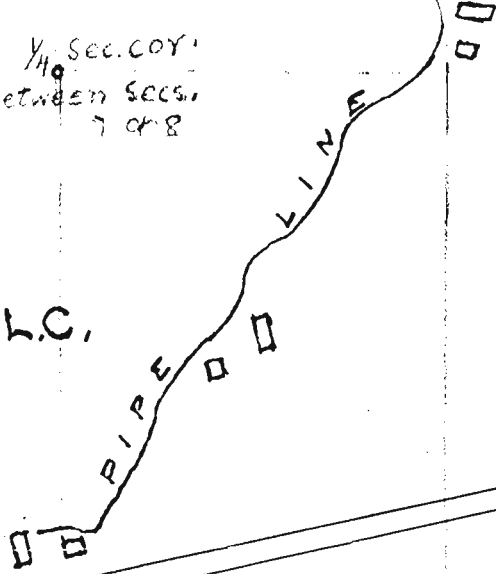

SPRING

N 22° W 2150 ft

corner
Sec. 8

SEC
8

$\frac{1}{4}$ Sec.
7 & 8
18 17

$\frac{1}{4}$ Sec.
S
corner

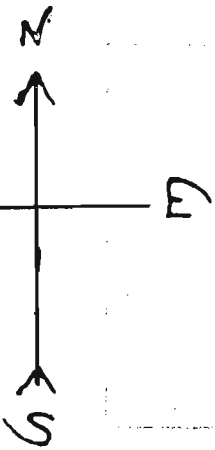

YAM HILL RIVER

SCALE 100 FT = ONE INCH

SEC
17

T. 6. S. R. 7. W.

SHOWING WIRTH WATER

10526