

FIRST ADDITION TO CHILOQUIN

center Sec. 34
304

Scale 1" = 200'

T.34 S. R. 7 E. W.M.

RIVER

Lot 5

S. P. R. R.

YAHOSKIN

CHOCKTOOT

WILLIAMSON

Diversion Point

PUMP HOUSE

ST. WATER MAIN

Water Main

N 59° 42' W 775'

N 63° 08' W 888'

S 82° 52' W 828'

N 76° 52' E 463.9'

E 1573' to initial point

West 697.8'

Initial Point

Application No. 10469
Permit No. 7146

STATE ENGINEER
RECEIVED

JUL 27 1928

SALEM, OREGON

North 290'

34 35
3 2

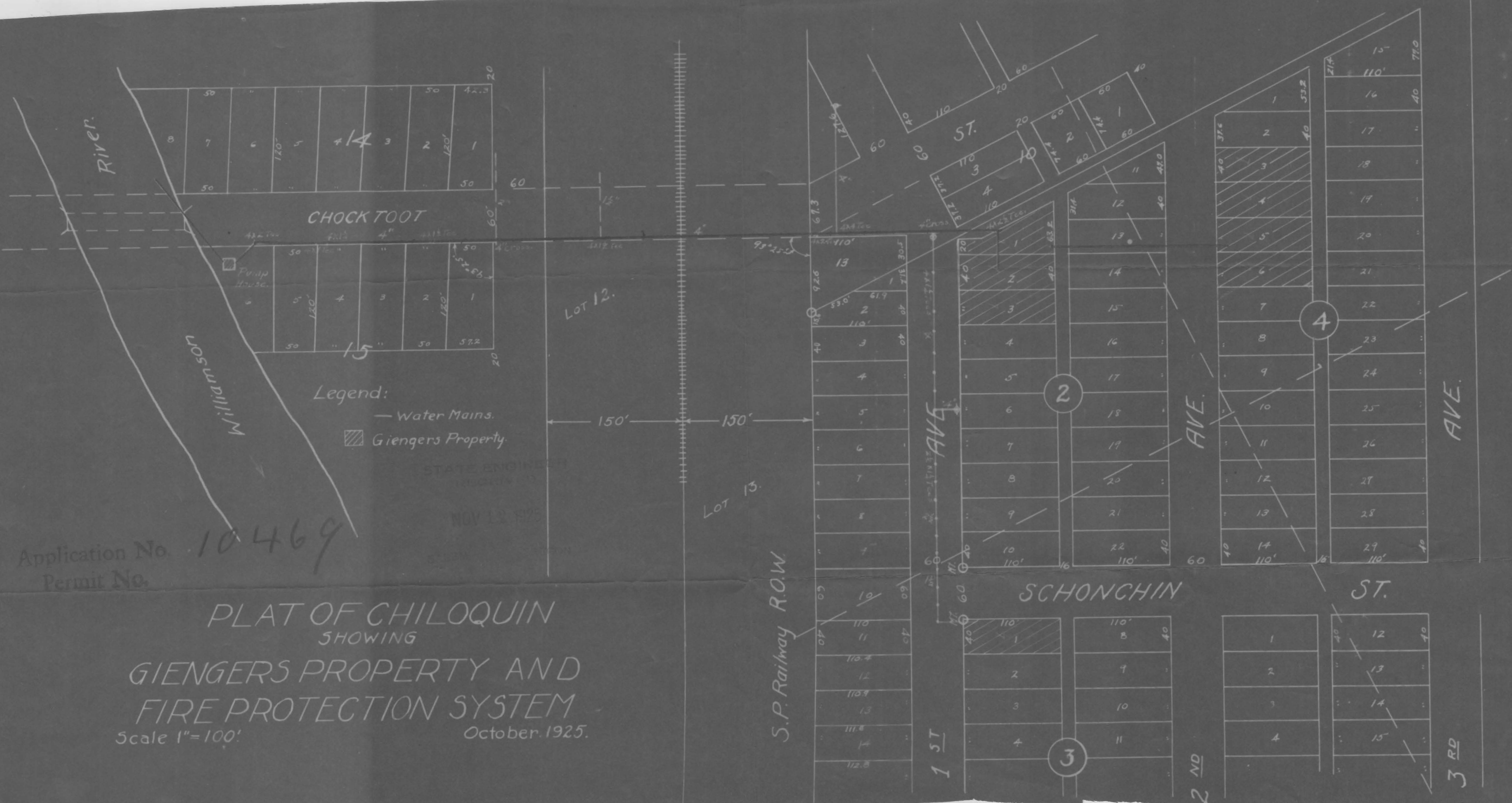

Legend:
 - Water Mains.
 ▨ Giengers Property.

STATE ENGINEER
 NOV 12 1925

Application No. 10469
 Permit No.

PLAT OF CHILOQUIN
 SHOWING
 GIENGERS PROPERTY AND
 FIRE PROTECTION SYSTEM
 Scale 1"=100'
 October, 1925.

S.P. Railway R.O.W.

1 ST

SCHONCHIN

ST.

2 RD

3 RD