

10573

STATE ENGINEER
JAN 5 1925
SALEM, OREGON

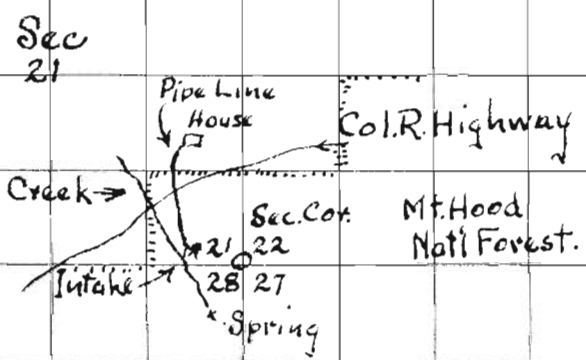

MAP SHOWING
 PROPOSED PIPE LINE FOR
 DIVERTING WATER FROM AN
 UN-NAMED SPRING-CREEK IN
 Sec. 21 - T. 2 N. - R. 7 E. W.M.
 Waldo A. Alcorn
 Surveyor
 Scale - 2 Inches = 1 Mile

Application No. 10573
 Permit No. 7157