

10790

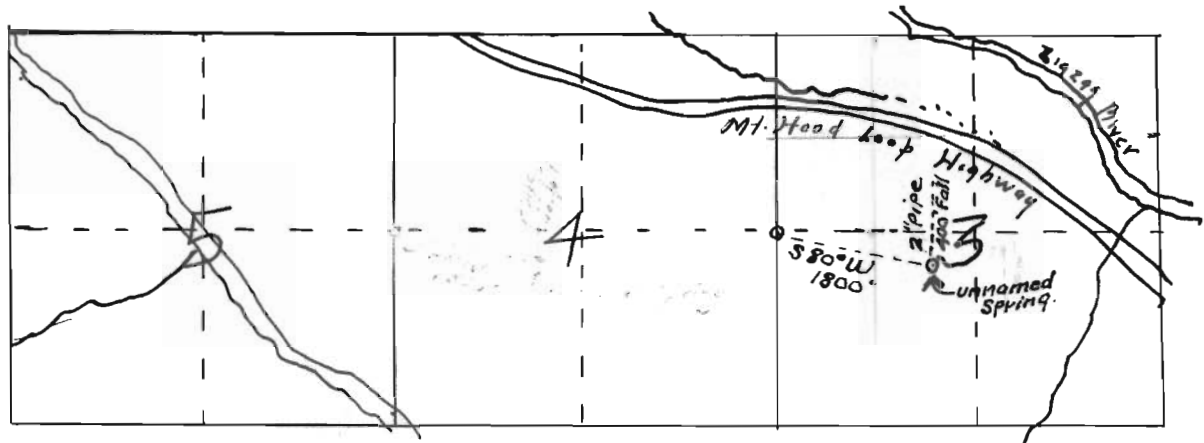

Sketch
 Showing location of Spring in Section 3.
 Twp 3. S., R. 7 E. WM.

To accompany Application of W^m J. Faubion
 Welches. Oregon

scale - 2 in. = 1 mi.

Application No. 10790
 Permit No. 7342

STATE ENGINEER
 RECEIVED

MAY 18 1926

SALEM, OREGON

10790