

Application No. 10894

Permit No. 7438

STATE ENGINEER
RECEIVED
JUL 14 1926
SALEM, OREGON

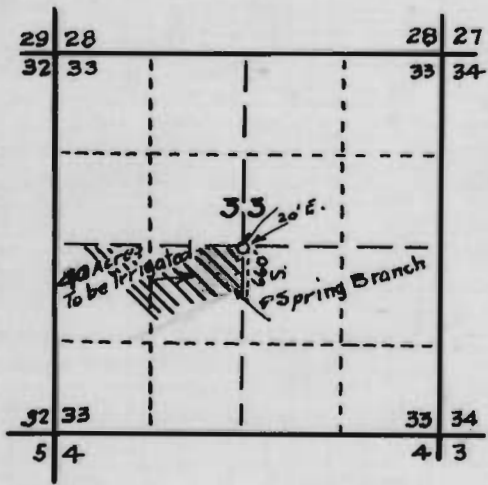
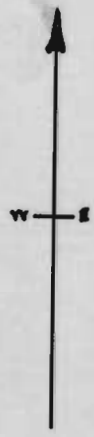

MAP OF
H.F. WELLS IRRIGATION
SYSTEM
IN
SECTION 33, TWP. 22 S, RANGE 4 W. W.M.
DOUGLAS COUNTY, OREGON.

OFFICE OF
BEN. B. IRVING
CIVIL ENGINEER AND SURVEYOR

CERTIFICATE OF SURVEYOR.

I, Ben. B. Irving of Roseburg, Oregon, do hereby certify that this map was made from notes taken during an actual survey made by me the twelfth day of July 1926 and that it correctly represents the works described in the accompanying application, together with the location of Streams and other ditches in the immediate vicinity.

Oregon No 240
Nov. 8, 1919.
Date of Registration

Ben B Irving
Registered Professional Engineer