

GLOBE

Map to accompany application for permit to appropriate the waters of an unnamed creek tributary to Wild Cat Creek in the S.E. 1/4 of Sec. 14 T. 18 S. R. 8 W. W. M., Lane Co., Oregon, by the Southern Pacific Co.

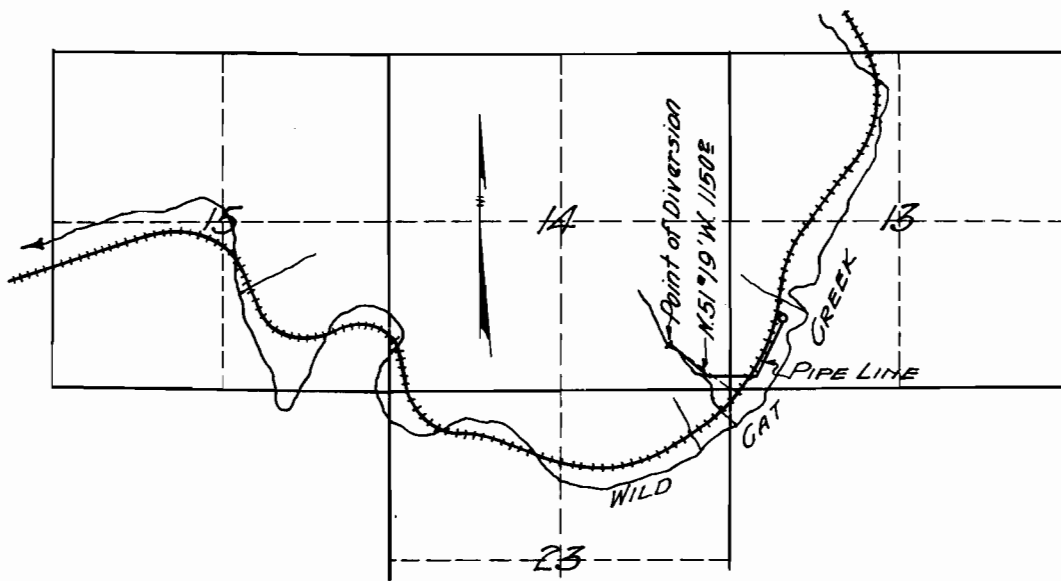

I, G. Haselton, of Portland, Oregon, do hereby certify that this map was made from notes taken during an actual survey made under my supervision on Dec. 20, 1923 and that it correctly represents the works described in the accompanying application, together with the location of streams and ditches in the immediate vicinity.

G. Haselton

Registered Engineer No. 140
State of Oregon

11194 and
6737 and 7616