

STATE ENGINEER
RECEIVED

AUG 12 1926

SALEM OREGON

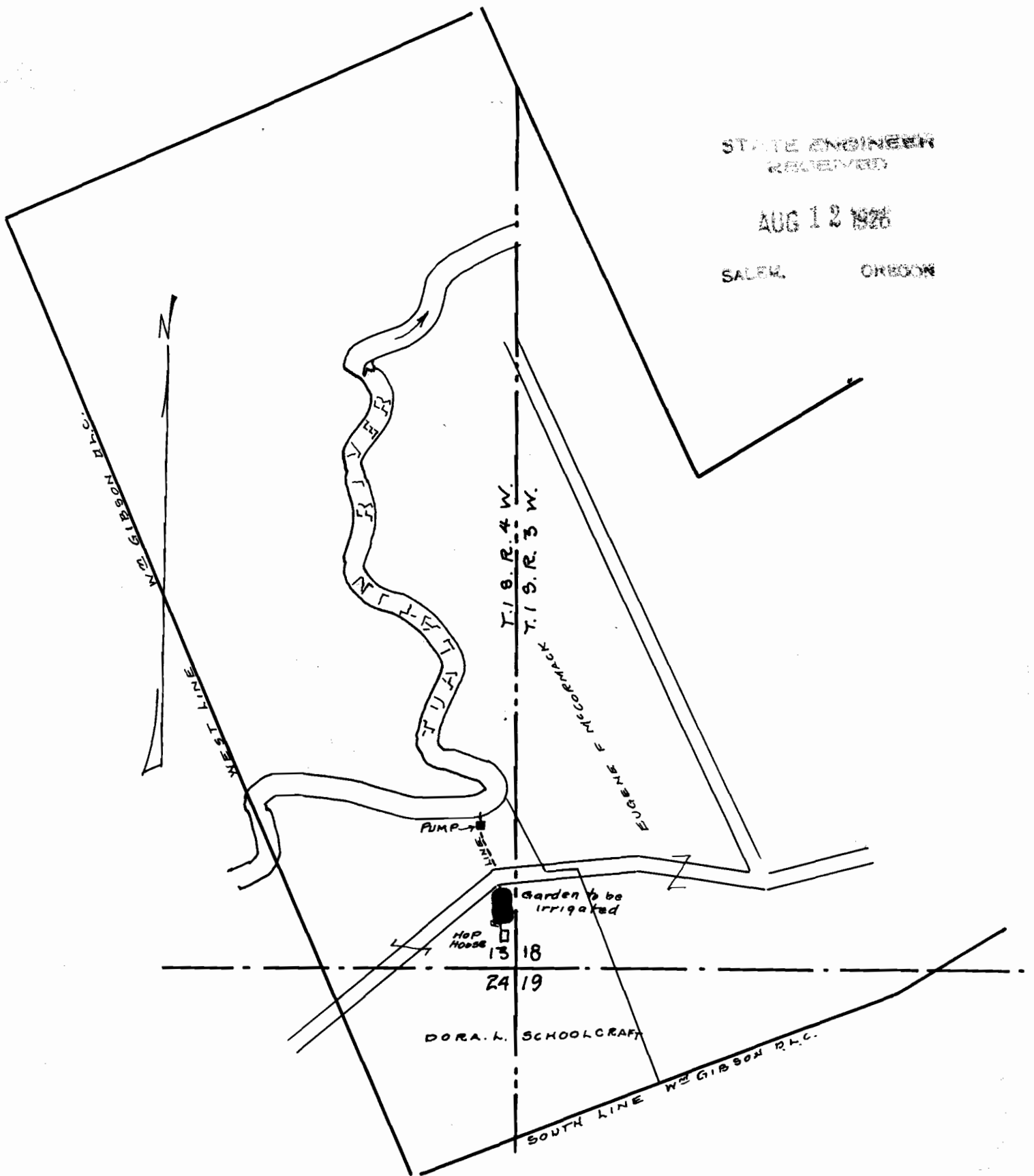

MAP
OF

Proposed location of point of diversion, area to be irrigated
and building served as described in accompanying application
Made from the records and measurements furnished by
the applicant

Scale 1" = 10 chs = 660'

By E. H. Falls
County Surveyor
Washington County

Application No. 11004
Permit No. 7634