

E. F. Hogan.

Scale 2"=1 Mile - Nov. 1926

T. 33 and 34 S., R. 7 W., W. M.

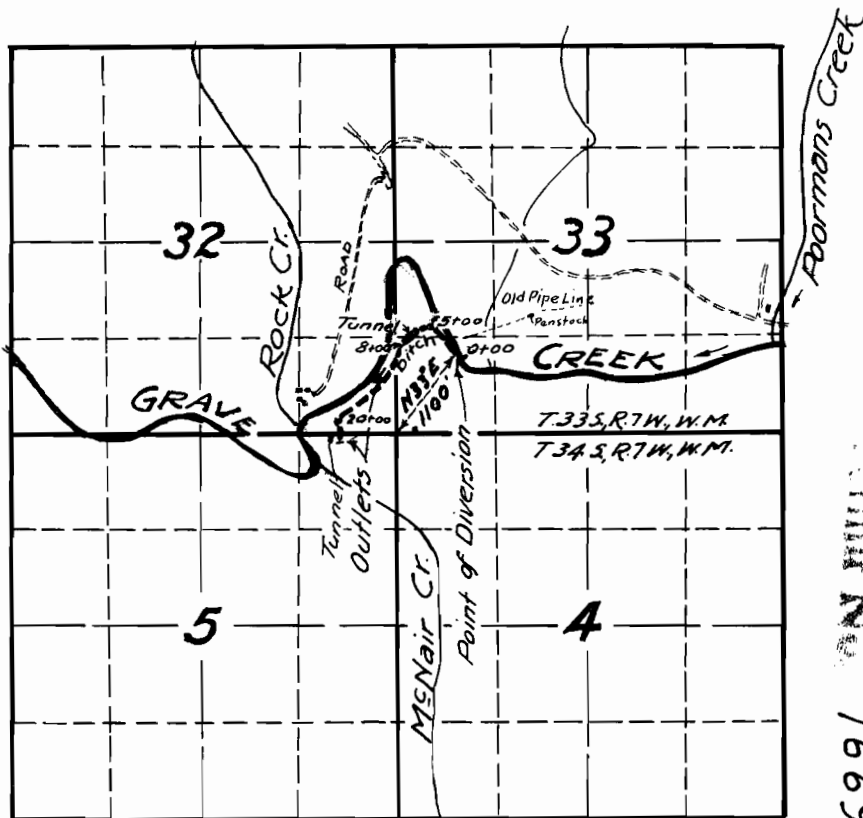

Section No. 11176
7669

I, Tom R. Pearce, of Grants Pass, Ore., do hereby certify that this map was made from notes taken during an actual survey made by me on Nov. 10, 1926 and that it correctly represents the works described in the accompanying application, together with the location of streams and ditches in the immediate vicinity.

Notes:-
From S.W. cor. 33
N 33° E 1100 ft. to Sta 0
thence N 25° W 500 ft. to Sta. 5100
S 70° W 300 ft. to Sta. B.
S 35° W 1200 ft. to Sta. 20.
S 0° 400 ft. to Sta 24

Tom R. Pearce
Registered Engineer # 838.
State of Oregon.