

I, F. P. Kurtz, of Siskiyou, Oregon, do hereby certify that this map was made from notes taken during an actual survey made under my immediate supervision on July 19, 1917, and that it correctly represents the works described in the accompanying application, together with the location of streams and other ditches in the immediate vicinity, and has written thereon the area in each smallest legal subdivision which it is proposed to irrigate.

Francis P. Kurtz
SURVEYOR.

Map Showing
 Points of diversion of water to be
 used in road construction
 on Siskiyou Mountain.
 Jackson Co. Oregon.
 Scale - 2" = 1 mi.

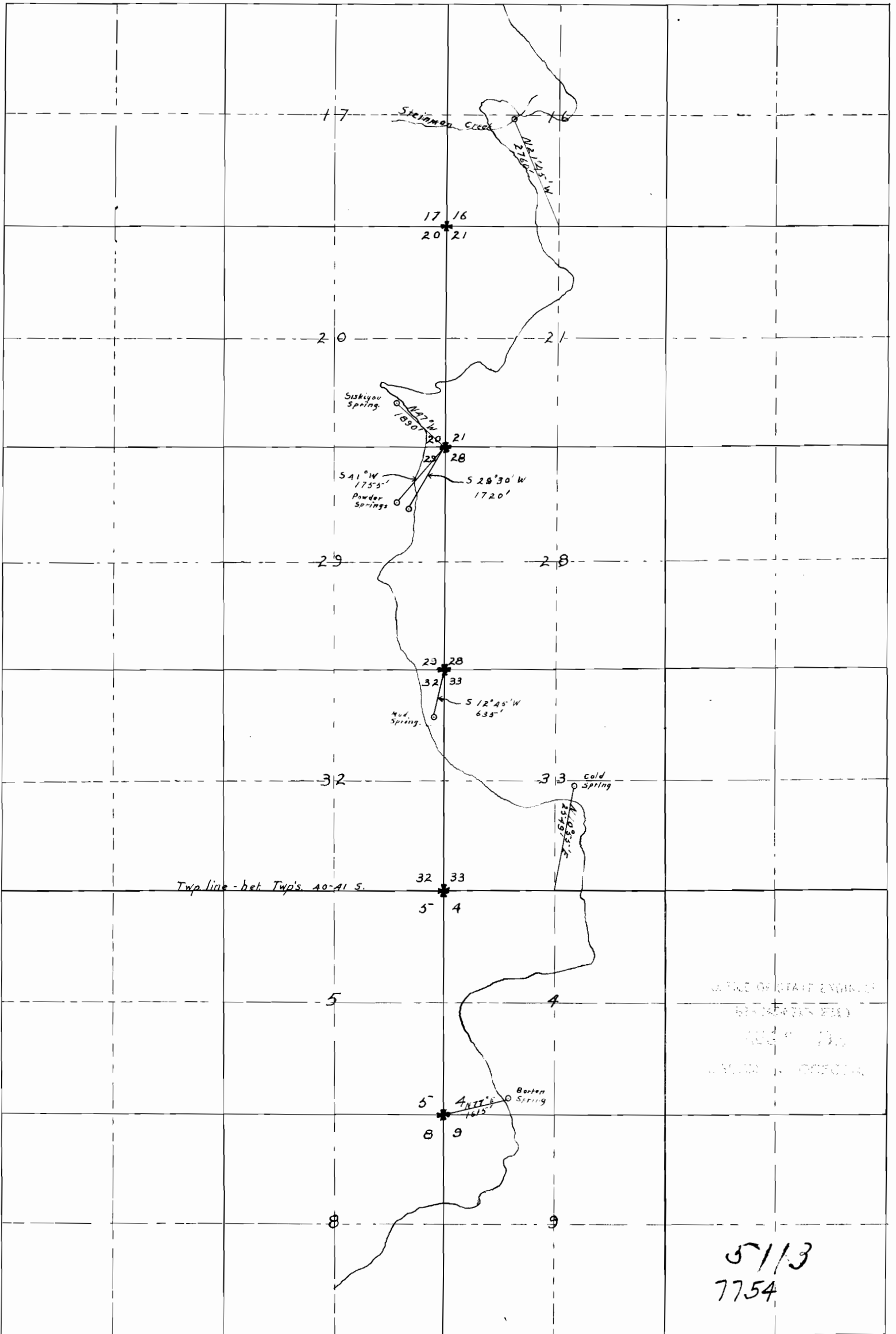

I, T. M. Davis, of Siskiyou, Oregon. do hereby certify that this map was made from notes taken during an actual survey made under my immediate supervision, on July 28th, 1916, and that it correctly represents the works described in the accompanying application, together with the location of streams and other ditches in the immediate vicinity.

T. M. Davis
 Surveyor.