

T 7 S. R 48 E, W. 11. BAKER CO., ORE.

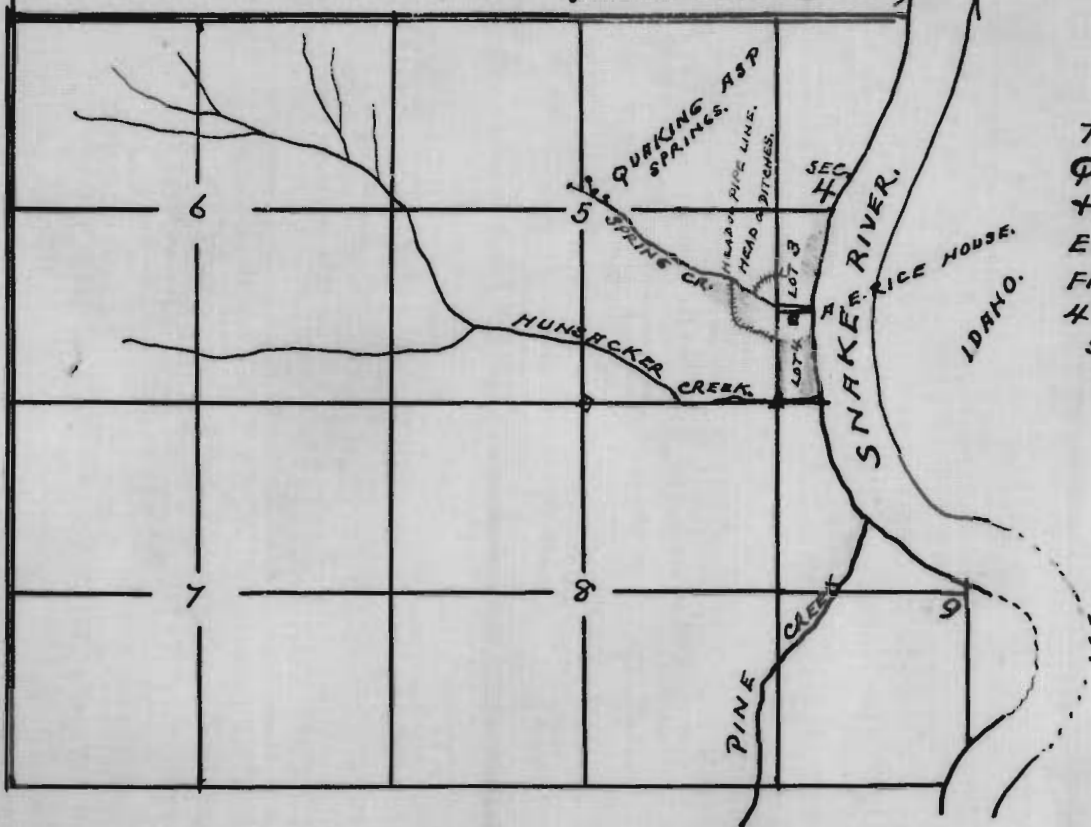

SKETCH

SHOWING
 THE LOCATION OF THE
 QUAKING ASP SPRINGS
 & THE LAND TO BE IRRIGATED
 FROM THE WATERS THERE-
 FROM, IN SECS. 4 & 5, T 7 S. R
 48 E, W. 11., BAKER CO., ORE.
 SCALE, ONE INCH = 40 CHS
 DRAWN JAN. 4, 1927

By *Ira L. Hoffman*
 County Surveyor

CERTIFICATE.

I, IRA L. HOFFMAN OF BAKER ORE., DO HEREBY
 CERTIFY THAT THIS MAP WAS MADE FROM DATA
 TAKEN FROM THE H.L. SENDER MAP & SKETCH
 SUPPLIED BY THE APPLICANT AND THAT IT CORRECT-
 LY REPRESENTS THE DATA SHOWN THEREON.

Ira L. Hoffman
 R.F.E. # 90, NOV. 8, 1919.

Application No. 11384
 Permit No. 7844