

MAP SHOWING WATER FILING OF J.C. SOUTH
 Tp 11 S; Rg 12 E of W.M. Scale 1 inch = 1000'

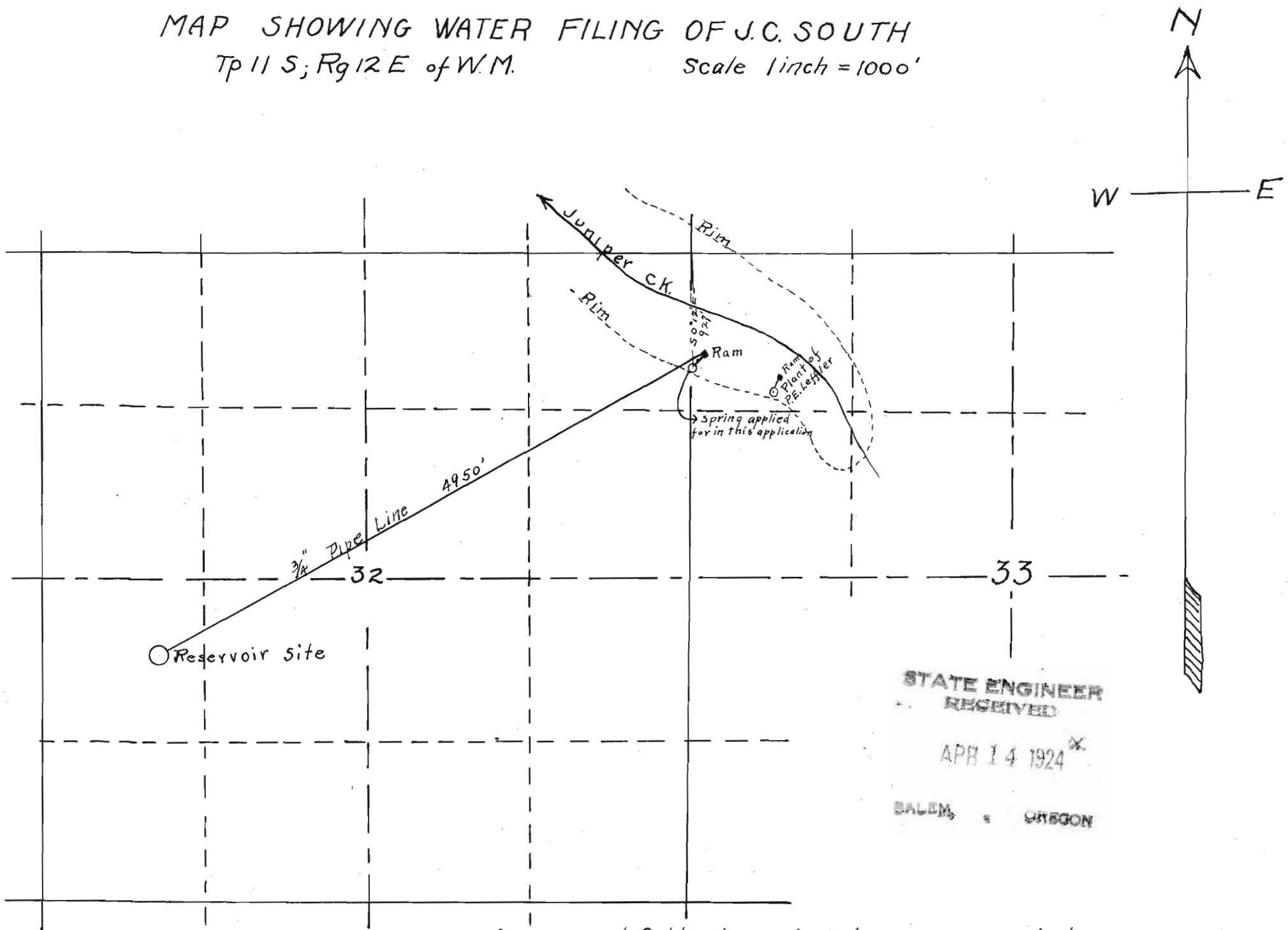

STATE ENGINEER
 RECEIVED
 APR 14 1924
 SALEM, OREGON

I, Raymond G. Heider of Madras Oregon do hereby certify that this map was made from notes taken during an actual survey made by me on April 6, 1924 and that it correctly represents the works described in the accompanying application, together with the location of streams and other ditches in the immediate vicinity.

Raymond G. Heider
 County Surveyor.

Application No. 9459
 Permit No. 6327

9459