

# MAP

SHOWING

VAN PATTEN LAKE RESERVOIR, located in Township 7 S. R. 37 E. W.M. on unsurveyed land in Baker County Oregon. Drawn to accompany the application of James Dalton and J.T. York for a permit to store and appropriate water for irrigation purposes.

C. M. Foster

Surveyor.

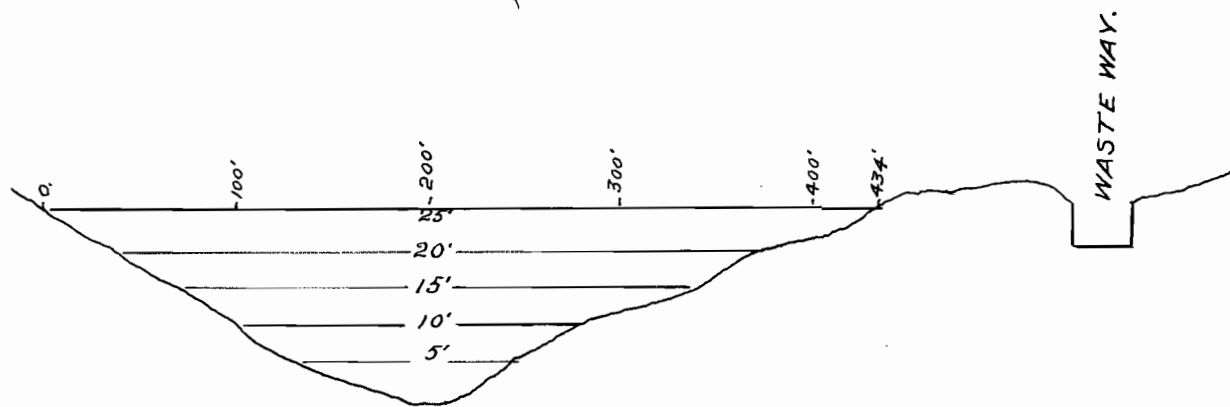
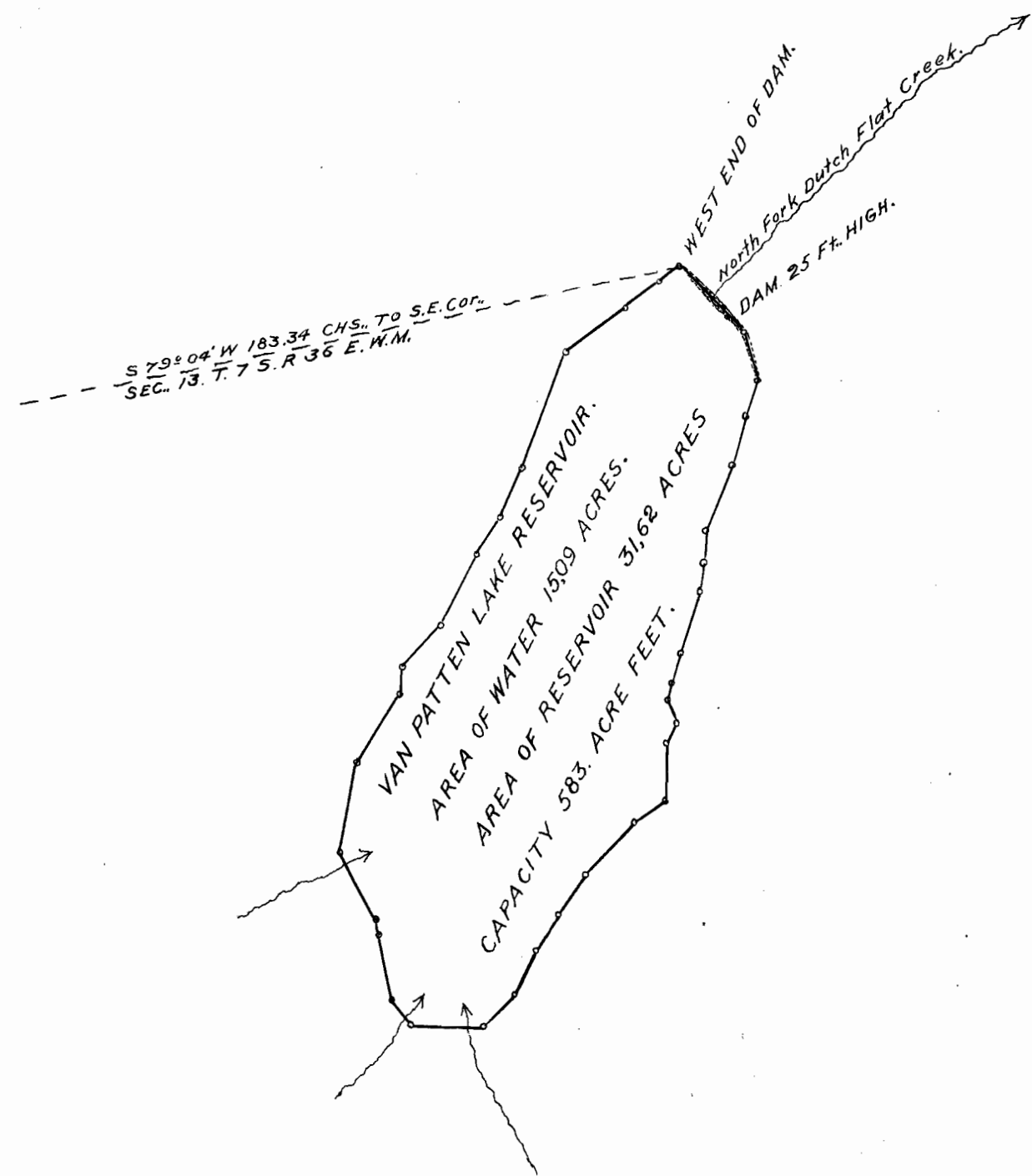

PROFILE OF DAM.

Horizontal Scale 100 Ft. = One Inch.  
Vertical Scale 25 Ft. = One Inch.

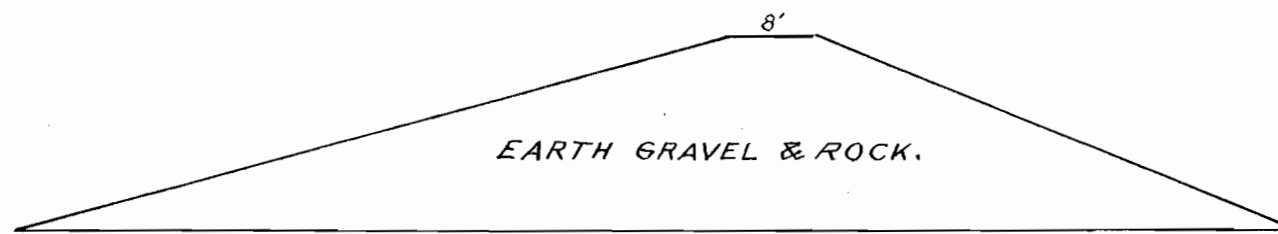

CROSS SECTION OF DAM.

Horizontal Scale 100 Ft. = ONE INCH.  
Vertical Scale 25 Ft. = ONE INCH.

## CERTIFICATE OF SURVEYOR.

I, C.M. Foster of Baker Oregon, do hereby certify, that this map was made from notes taken during an actual survey made by me on the 11<sup>th</sup>, 12<sup>th</sup>, 13<sup>th</sup> & 14<sup>th</sup> days of August 1911, and that it correctly represents the works described in the application of James Dalton and J.T. York, heretofore made; together with the location of streams and other ditches in the immediate vicinity. This map is made to amend and make definite the map heretofore filed with said application, so far as the same relates to the reservoir site of Van Patten Lake.

C. M. Foster

Surveyor.

1567  
789

FILED  
AUG 30 1911  
SALEM, OREGON