

22 23
27 26 T. 2 N. R. 10 E. Y. M.

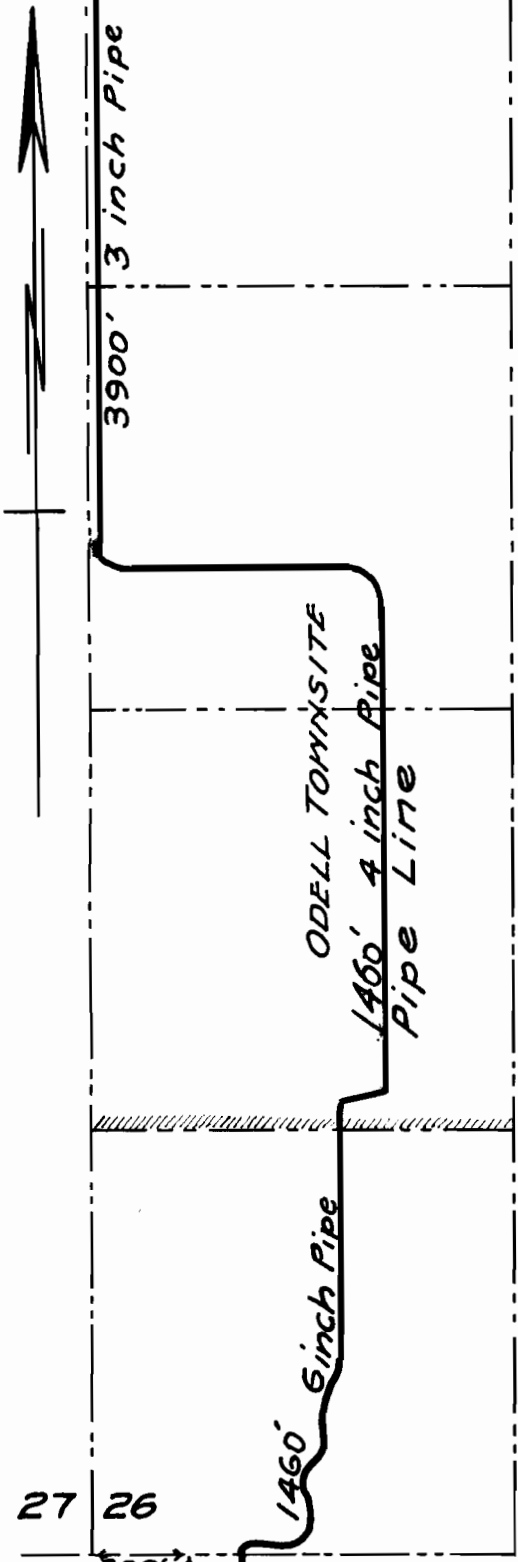

MAP

Accompanying application for a permit to appropriate water for domestic purposes by Aubrey Davis, M.O. Mark and Glenn Allen

In Section 35, T. 2 N., R. 10 E. Y. M.

CERTIFICATE OF SURVEYOR

I, C.M. Hurlburt, of Hood River, Oregon, do hereby certify that this map was made from notes taken during an actual survey made by me on the 5th day of Feb. 1927, and that it correctly represents the works described in the accompanying application.

Scale: 1 in. = 600 ft.
Feb. 11, 1927.

C. M. Hurlburt
Co. Engr.
Engr's License #766

27 26
34 35
Spring Intake
DAVIS, owner

Application for
Permit No.