

T. 12 S. R. 43 E. W.M.

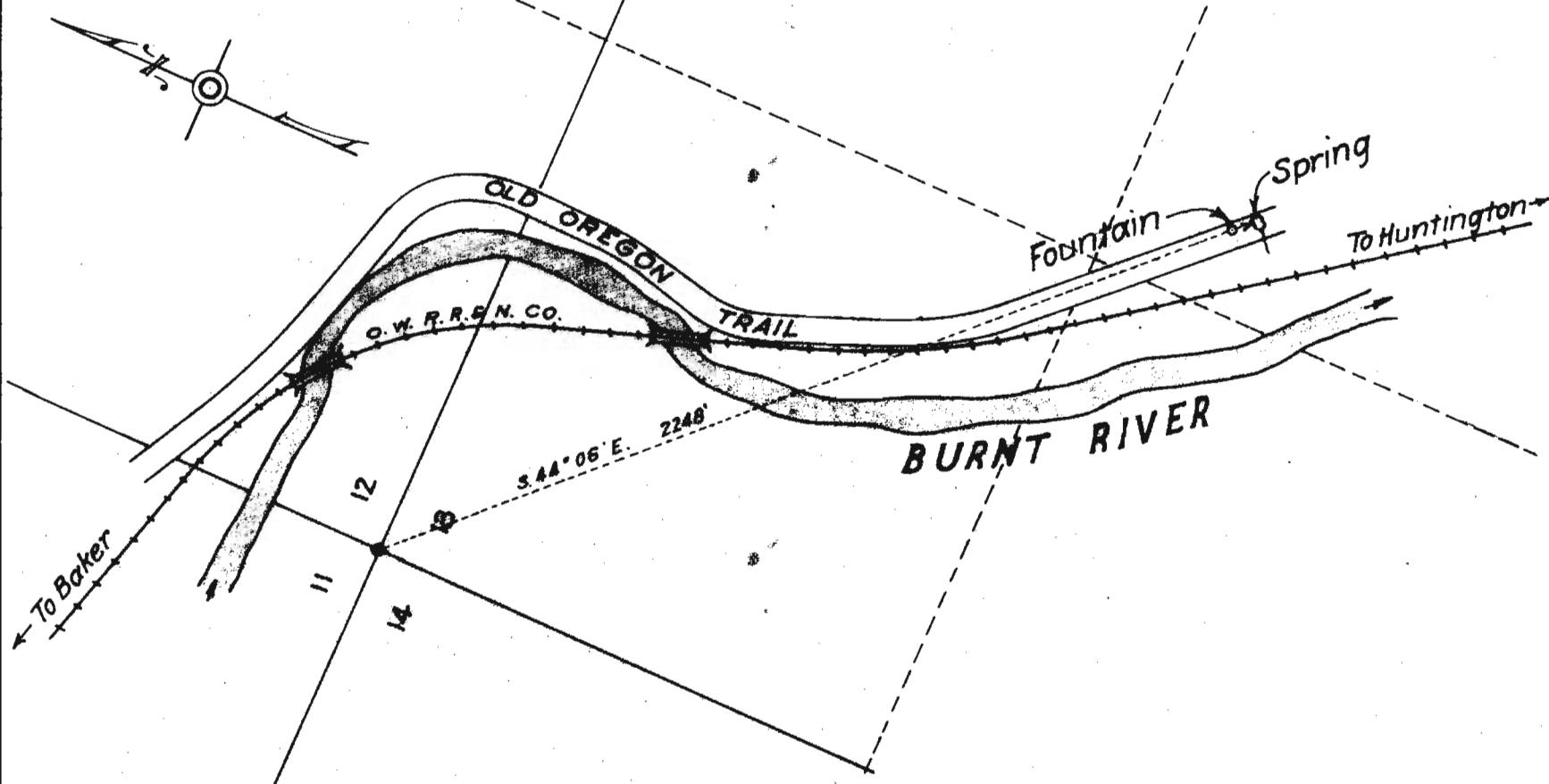

OREGON STATE HIGHWAY DEPARTMENT

Sketch Map to Accompany
Application for Permit to appropriate
the water from

RATTLESNAKE SPRINGS

BAKER COUNTY

Application No.
Permit No.

11758
8211

Scale 1 in = 400 ft.

Oct. 1927.