

Township No. 6. South Range 38. E. W. M. Ore.

Township No. 6. South Range 39. E. W. M. Ore.

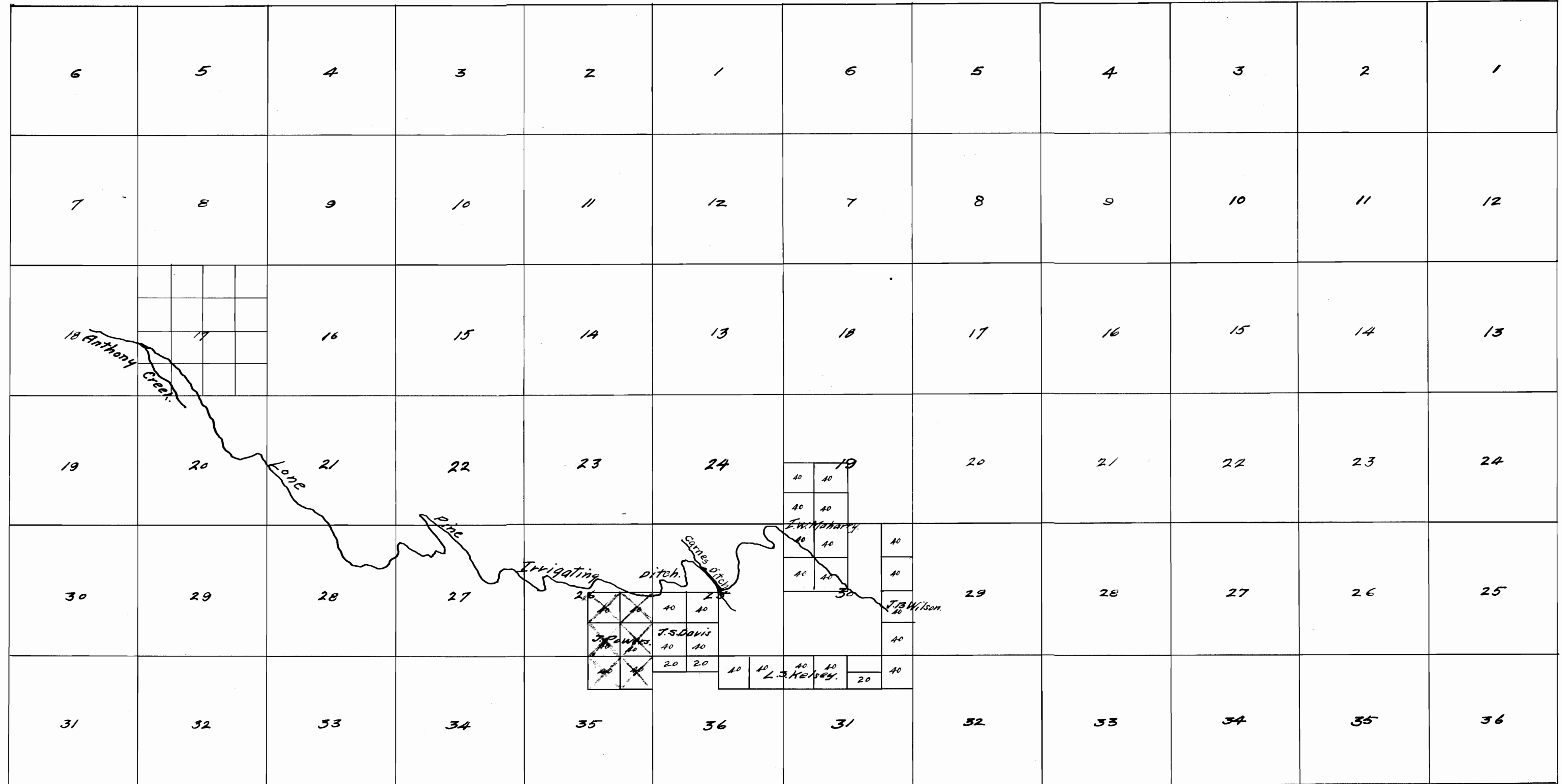

I, R.C. Shattuck, of Baker, Ore. do hereby certify that this map was made from notes taken during an actual survey made by me on May 5th & 6th 1911, and that it correctly represents the works described in the accompanying application, together with the location of streams and other ditches in the immediate vicinity, and has written thereon the area in each smallest legal subdivision which it is proposed to irrigate.
R.C. Shattuck
 Surveyor.

OFFICE OF STATE ENGINEERS
 RECEIVED
 JUN 26 1911
 BAKER, OREGON

Application No. 1512
 Permit No. 828

Map of
 Lone Pine Irrigation Ditch
 Lone Pine Irrigation Ditch Co. Inc.
 North Powder Oregon.
 Scale 2 inches = 1 mile
 R.C. Shattuck
 Surveyor.