

SECTION

TOWNSHIP 35, RANGE 3E, W. M.

North

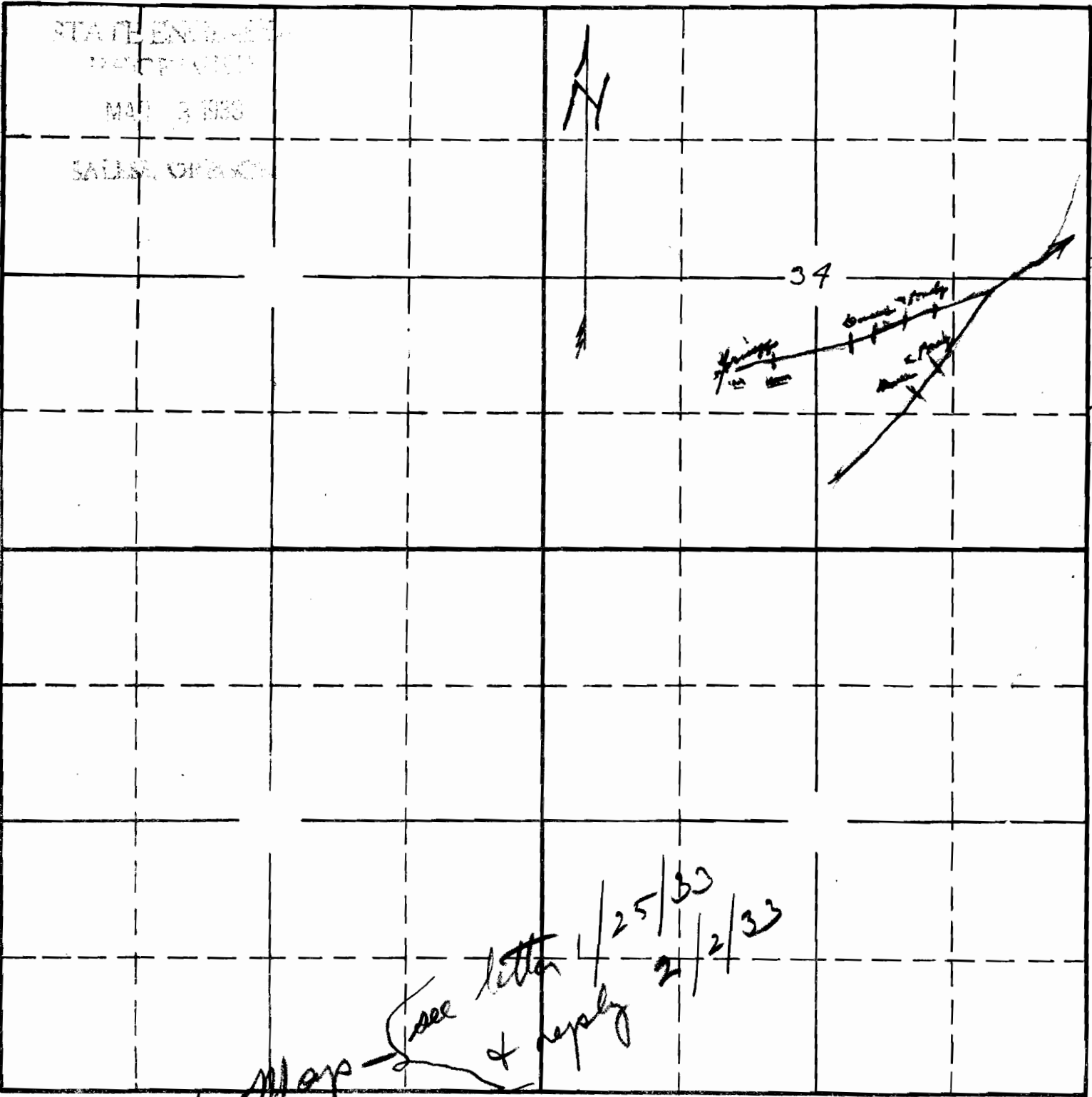

Corrected
 Record 3/3/33

See letter 1/25/33
 & reply 2/2/33

South

APPLICATION No. 11942
 PERMIT No.

East 1/2 of SE 1/4 Sec 34 T4 E 5 R 3 E 7 N M.

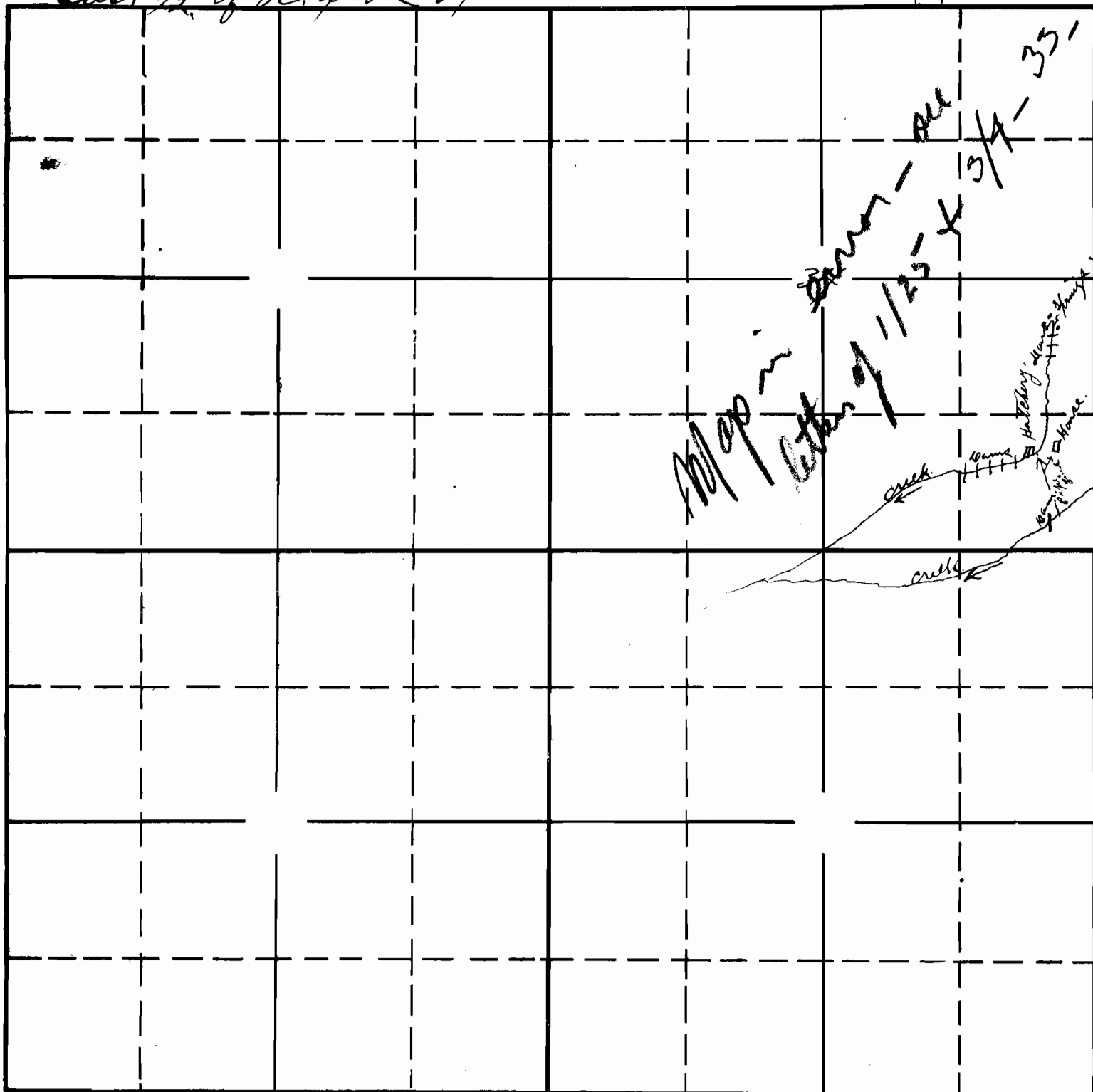

Application No. _____
Permit No. _____

1142
8430

R. _____

Tp. _____

Sec. _____