

# SECTION 4

T 1 S R 1 E W. M.

1" = 100'

N

AMENDED MAP ACCOMPANYING AMENDED APPLICATION OF A. L. VEAZIE TO APPROPRIATE WATERS OF SMALL SPRINGS SITUATED ON LOT 4, 6 & 7, BLOCK 2, SEVENTH STREET TERRACES, PORTLAND, OREGON.

(Lands to be irrigated are enclosed by hatching).

Springs covered by said application are the following:  
(1) Caruthers Spring, located in the SW corner of Lot 6 Block 2; (2) Barrett Spring, being located in or near the SW corner of said Lot 7 Block 2, or in the street immediately west thereof; (3) an unnamed spring arising near the south line of said Lot 4; and all other springs located on said Lots 6 and 7.

SEVENTH ST  
TERRACES

SHEFFIELD AVE.



HOFMANN AVE.

PIPE A

PIPE B

PIPE C

PIPE D

PIPE E

PIPE F

PIPE G

PIPE H

PIPE I

PIPE J

PIPE K

PIPE L

PIPE M

PIPE N

PIPE O

PIPE P

PIPE Q

PIPE R

PIPE S

PIPE T

PIPE U

PIPE V

PIPE W

PIPE X

PIPE Y

PIPE Z

PIPE AA

PIPE AB

PIPE AC

PIPE AD

PIPE AE

PIPE AF

PIPE AG

PIPE AH

PIPE AI

PIPE AJ

PIPE AK

PIPE AL

PIPE AM

PIPE AN

PIPE AO

PIPE AP

PIPE AQ

PIPE AR

PIPE AS

PIPE AT

PIPE AU

PIPE AV

PIPE AW

PIPE AX

PIPE AY

PIPE AZ

PIPE BA

PIPE BB

PIPE BC

PIPE BD

PIPE BE

PIPE BF

PIPE BG

PIPE BH

PIPE BI

PIPE BJ

PIPE BK

PIPE BL

PIPE BM

PIPE BN

PIPE BO

PIPE BP

PIPE BQ

PIPE BR

PIPE BS

PIPE BT

PIPE BU

PIPE BV

PIPE BW

PIPE BX

PIPE BY

PIPE BZ

PIPE CA

PIPE CB

PIPE CC

PIPE CD

PIPE CE

PIPE CF

PIPE CG

PIPE CH

PIPE CI

PIPE CJ

PIPE CK

PIPE CL

PIPE CM

PIPE CN

PIPE CO

PIPE CP

PIPE CQ

PIPE CR

PIPE CS

PIPE CT

PIPE CU

PIPE CV

PIPE CW

PIPE CX

PIPE CY

PIPE CZ

PIPE DA

PIPE DB

PIPE DC

PIPE DD

PIPE DE

PIPE DF

PIPE DG

PIPE DH

PIPE DI

PIPE DJ

PIPE DK

PIPE DL

PIPE DM

PIPE DN

PIPE DO

PIPE DP

PIPE DQ

PIPE DR

PIPE DS

PIPE DT

PIPE DU

PIPE DV

PIPE DW

PIPE DX

PIPE DY

PIPE DZ

PIPE EA

PIPE EB

PIPE EC

PIPE ED

PIPE EE

PIPE EF

PIPE EG

PIPE EH

PIPE EI

PIPE EJ

PIPE EK

PIPE EL

PIPE EM

PIPE EN

PIPE EO

PIPE EP

PIPE EQ

PIPE ER

PIPE ES

PIPE ET

PIPE EU

PIPE EV

PIPE EW

PIPE EX

PIPE EY

PIPE EZ

PIPE FA

PIPE FB

PIPE FC

PIPE FD

PIPE FE

PIPE FF

PIPE FG

PIPE FH

PIPE FI

PIPE FJ

PIPE FK

PIPE FL

PIPE FM

PIPE FN

PIPE FO

PIPE FP

PIPE FQ

PIPE FR

PIPE FS

PIPE FT

PIPE FU

PIPE FV

PIPE FW

PIPE FX

PIPE FY

PIPE FZ

PIPE GA

PIPE GB

PIPE GC

PIPE GD

PIPE GE

PIPE GF

PIPE GG

PIPE GH

PIPE GI

PIPE GJ

PIPE GK

PIPE GL

PIPE GM

PIPE GN

PIPE GO

PIPE GP

PIPE GQ

PIPE GR

PIPE GS

PIPE GT

PIPE GU

PIPE GV

PIPE GW

PIPE GX

PIPE GY

PIPE GZ

PIPE HA

PIPE HB

PIPE HC

PIPE HD

PIPE HE

PIPE HF

PIPE HG

PIPE HH

PIPE HI

PIPE HJ

PIPE HK

PIPE HL

PIPE HM

PIPE HN

PIPE HO

PIPE HP

PIPE HQ

PIPE HR

PIPE HS

PIPE HT

PIPE HU

PIPE HV

PIPE HW

PIPE HX

PIPE HY

PIPE HZ

PIPE IA

PIPE IB

PIPE IC

PIPE ID

PIPE IE

PIPE IF

PIPE IG

PIPE IH

PIPE II

PIPE IJ

PIPE IK

PIPE IL

PIPE IM

PIPE IN

PIPE IO

PIPE IP

PIPE IQ

PIPE IR

PIPE IS

PIPE IT

PIPE IU

PIPE IV

PIPE IW

PIPE IX

PIPE IY

PIPE IZ

PIPE JA

PIPE JB

PIPE JC

PIPE JD

PIPE JE

PIPE JF

PIPE JG

PIPE JH

PIPE JI

PIPE JJ

PIPE JK

PIPE JL

PIPE JM

PIPE JN

PIPE JO

PIPE JP

PIPE JQ

PIPE JR

PIPE JS

PIPE JT

PIPE JU

PIPE JV

PIPE JW

PIPE JX

PIPE JY

PIPE JZ

PIPE KA

PIPE KB

PIPE KC

PIPE KD

PIPE KE

PIPE KF

PIPE KG

PIPE KH

PIPE KI

PIPE KJ

PIPE KK

PIPE KL

PIPE KM

PIPE KN

PIPE KO

PIPE KP

PIPE KQ

PIPE KR

PIPE KS

PIPE KT

PIPE KU

PIPE KV

PIPE KW

PIPE KX

PIPE KY

PIPE KZ

PIPE LA

PIPE LB

PIPE LC

PIPE LD

PIPE LE

PIPE LF

PIPE LG

PIPE LH

PIPE LI

PIPE LJ

PIPE LK

PIPE LL

PIPE LM

PIPE LN

PIPE LO

PIPE LP

PIPE LQ

PIPE LR

PIPE LS

PIPE LT

PIPE LU

PIPE LV

PIPE LW

SECTION 4

T I S R I E W . M .

1" = 100'



FINAL PROOF ON  
MAP ACCOMPANYING/APPLICATION OF  
A. L. VEAZIE TO APPROPRIATE WATERS  
OF SMALL SPRINGS SITUATED ON LOT  
6, BLOCK 2, SEVENTH STREET TER-  
RACES, PORTLAND, OREGON.

(Lands ~~not~~ irrigated are en-  
closed by hatching.)

SEVENTH - ST.  
TERRACES

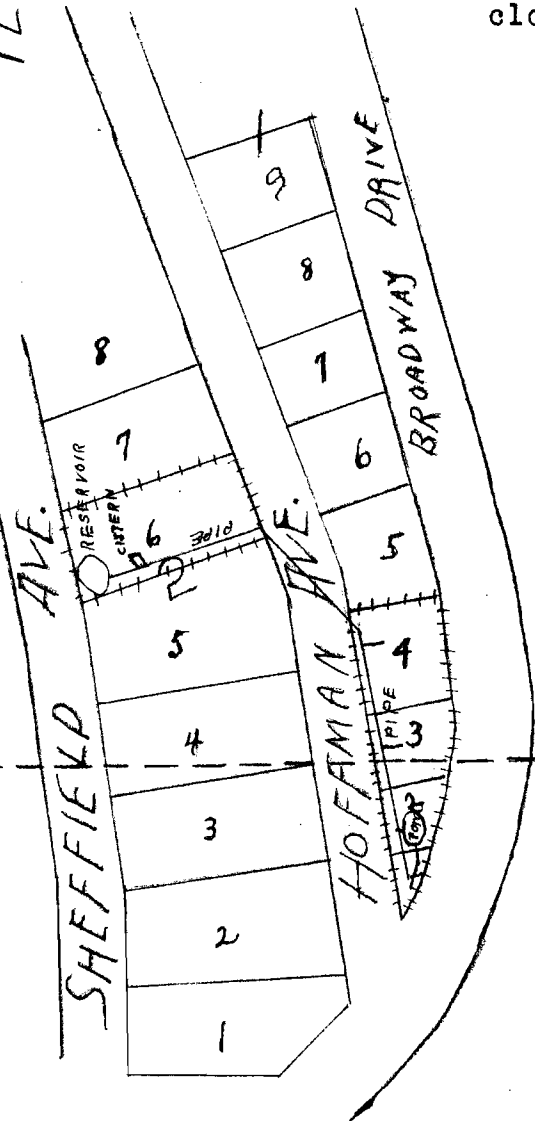

4

3

9

10

Application No. 12044  
Permit No. 8448