

—MAP.—

Accompanying application of W. H. CASNER of
Rogue River, Jackson County, Oregon, for permit
to the waters of Collins Gulch tributary to Pleasant
Creek, Jackson County, Oregon, for purpose of Irrigation.

—July 1928—

T34 S.R. 4. W.W.M.

NE⁴ NE⁴ Sec 21

W. H. Casner.

NW⁴ NW⁴ Sec 22

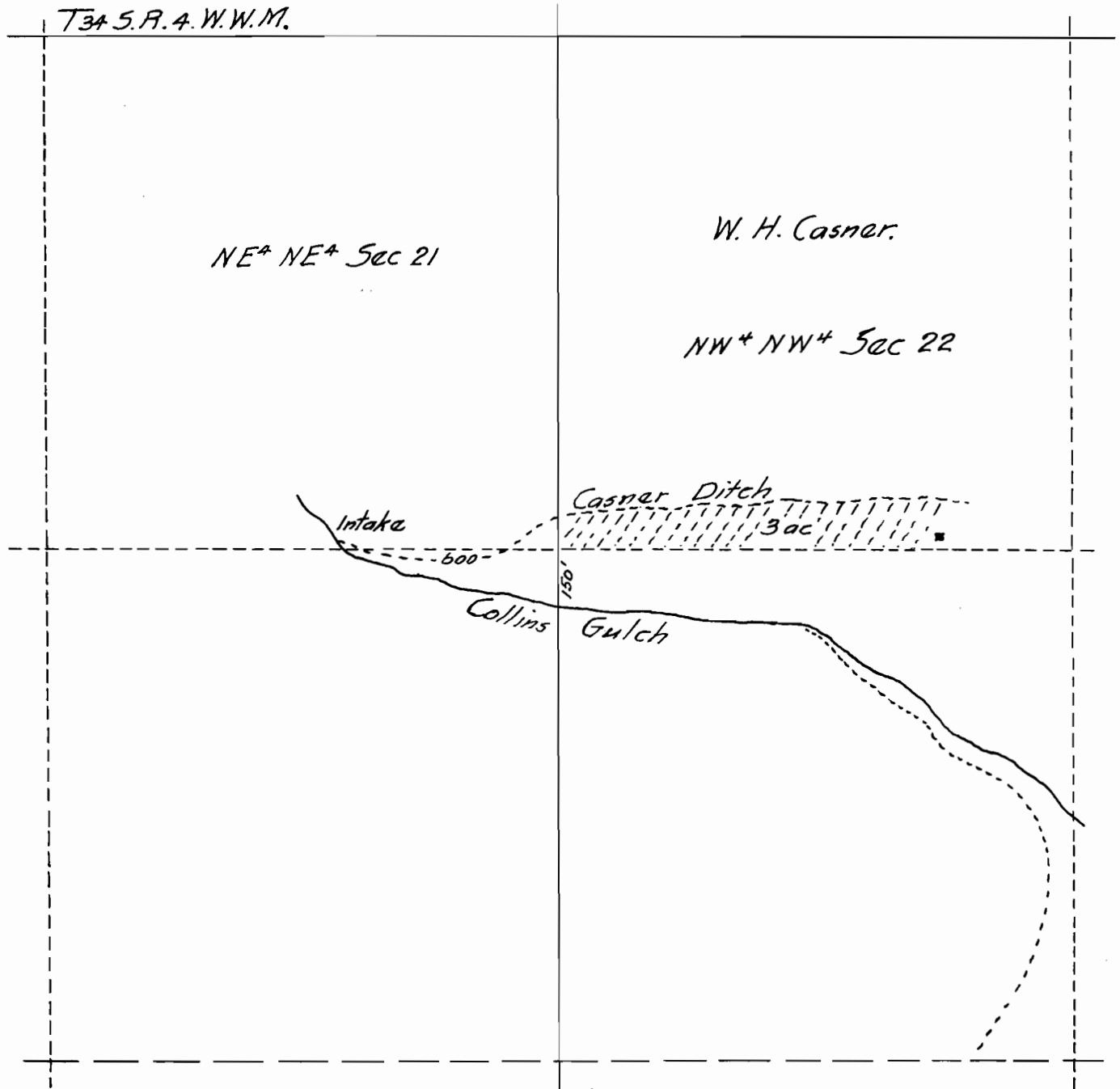

Map made from measurements made by W. H. Casner
Showing correct location of lands to be irrigated together
with streams and ditches in immediate vicinity.
Compiled by.

—Fred. N. Cummings, C.E.—

Application No 13900

Section No. 2561