

MAP

Accompanying application of John Carter of Jacksonville  
Jackson Co. Oregon for permit to the waters of Spring  
tributary to Forrest Creek tri to Big Applegate Jackson  
Co. Oregon. for Domestic purposes

Aug 1<sup>st</sup> 1928.

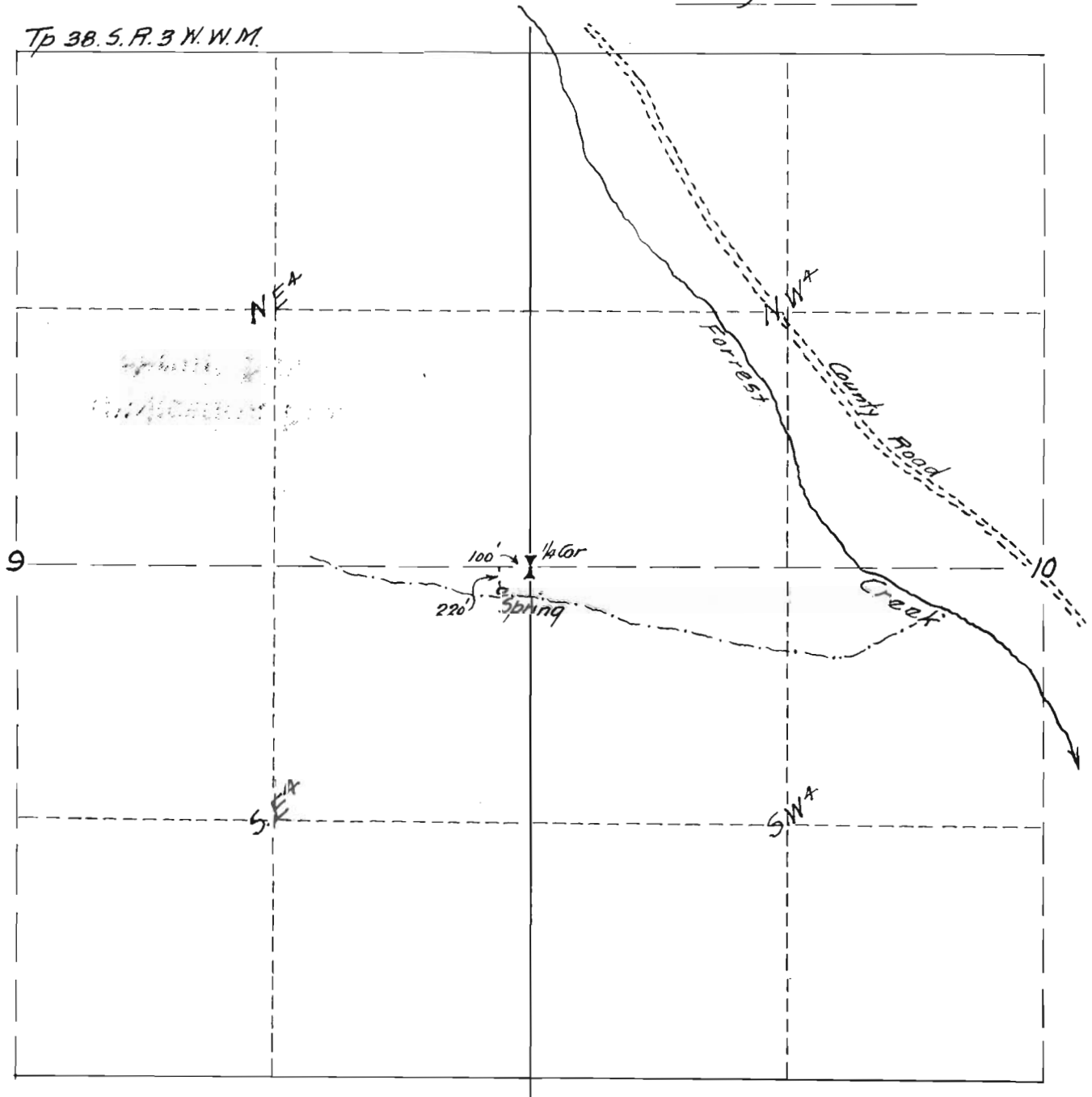

Map made from measurements taken in the field correctly  
showing location of Spring with reference to  $\frac{1}{4}$  Corner  
between Sections 9 and 10 Tp 38. S R 3 W. W. M. compiled by  
Fred. N. Cummings. C.E.

Application No. 2252

Permit No. 8630