

- MAP -

Accompanying final proof papers of Gus Newbury of  
Medford, Jackson County, Oregon.

- Oct. 1929 -

Tp. 39S. R. 3 W. W. M.

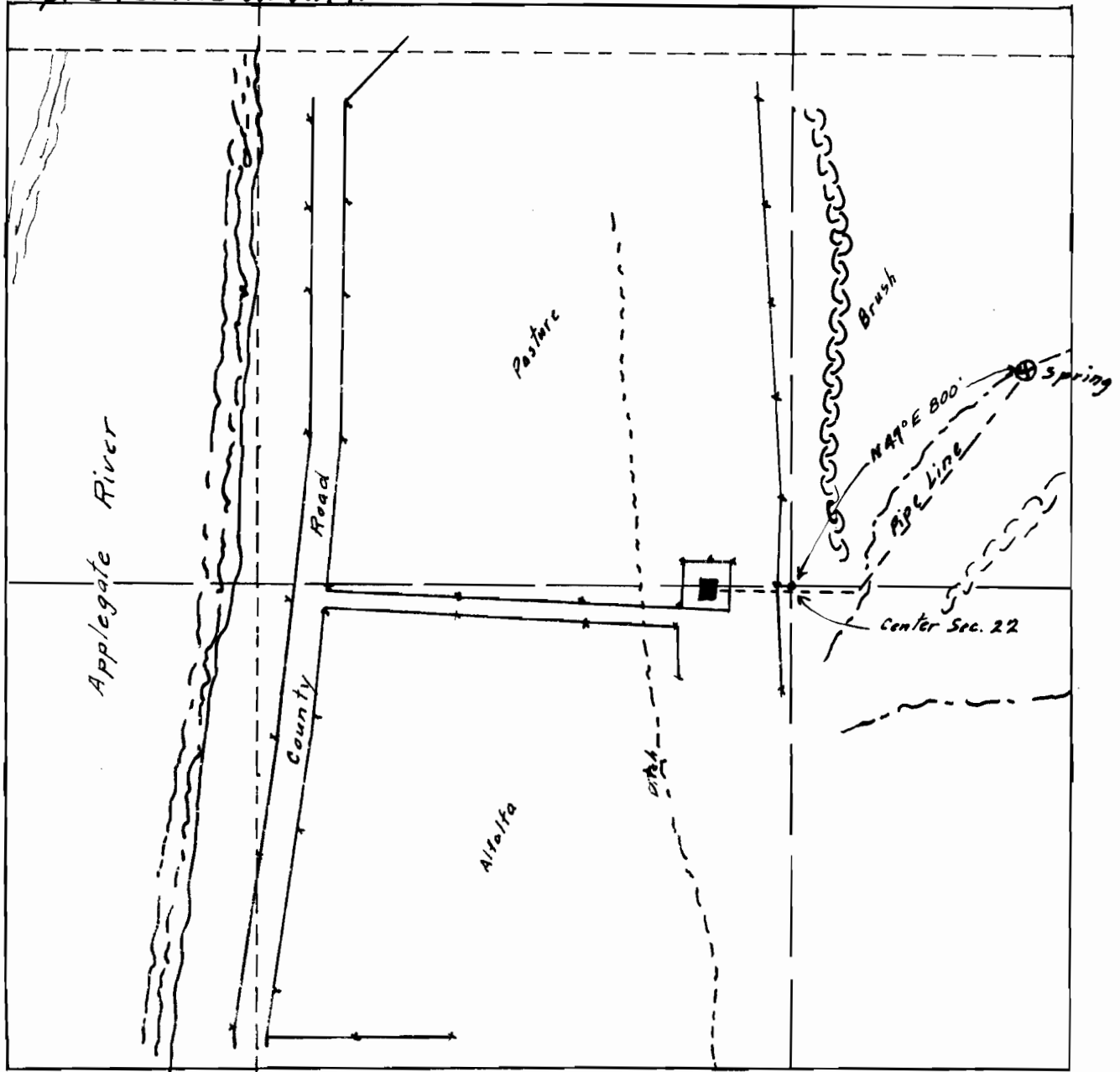

Map made from survey by Water Masters Office correctly  
showing location of spring and place of use together with streams  
and ditches in immediate vicinity. Compiled by

- Wilbur M. Darby Asst. Water Master -

12712

W

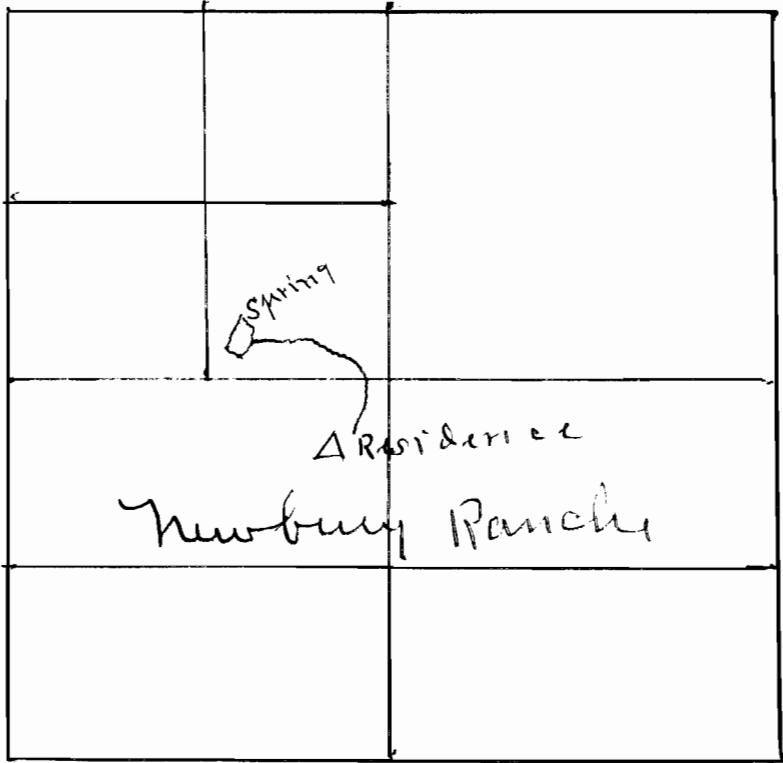

07

N.

W.

Application No. 12432  
 Permit No. 18773