

T-5849

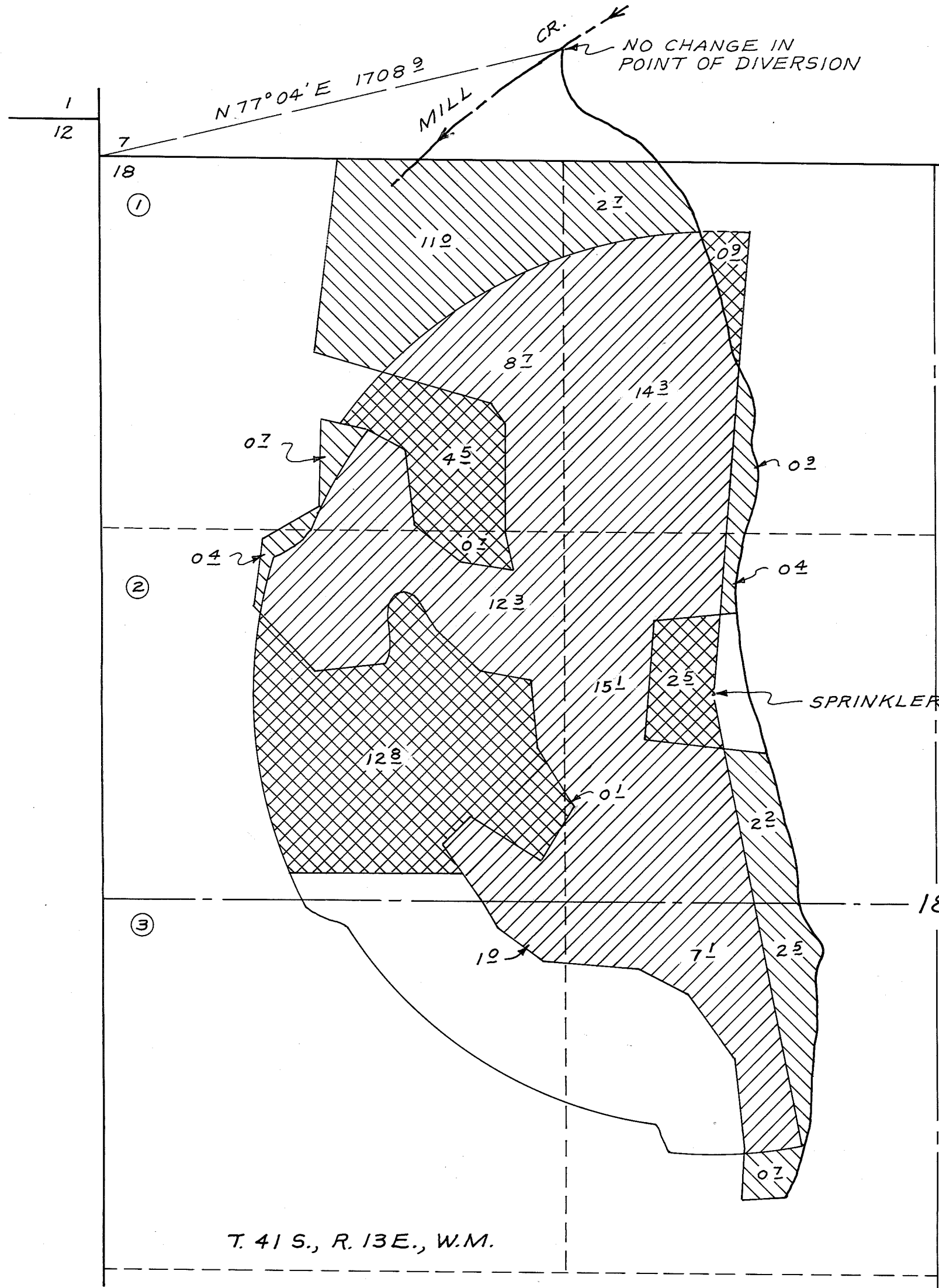

T. 41 S., R. 13 E., W.M.

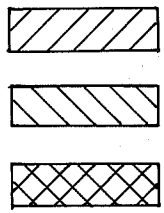

LANDS TO CONTINUE TO BE IRRIGATED UNDER WATER RIGHT CERTIFICATE NO. 3321 & CERT. NO. 2751 = 58.5 ACRES

LANDS COVERED BY CERTIFICATE NO. 3321 & CERT. NO. 2751 TO BE TRANSFERRED TO NEW PLACE OF USE = 21.5 ACRES

NEW PLACE OF USE FOR TRANSFERRED WATER RIGHTS = 21.5 ACRES



MAP SHOWING WATER RIGHT TRANSFER FOR LOVENESS FARMS

IN SECTION 18, T. 41 S., R. 13 E., W.M. KLAMATH COUNTY, OREGON  
 Scale: 1" = 400'  
 Prepared under direction of WILLIAM L. WALES Consulting Engineer  
 4512 Clinton Ave. Klamath Falls, Or.  
 July, 1986