

MAP

Accompanying application of SYLVESTER KENNEDY of Central Point, Jackson County, for permit to appropriate the waters of Spring tributary to Kanes Creek tributary to Rogue River, Jackson County Oregon, for Domestic use.

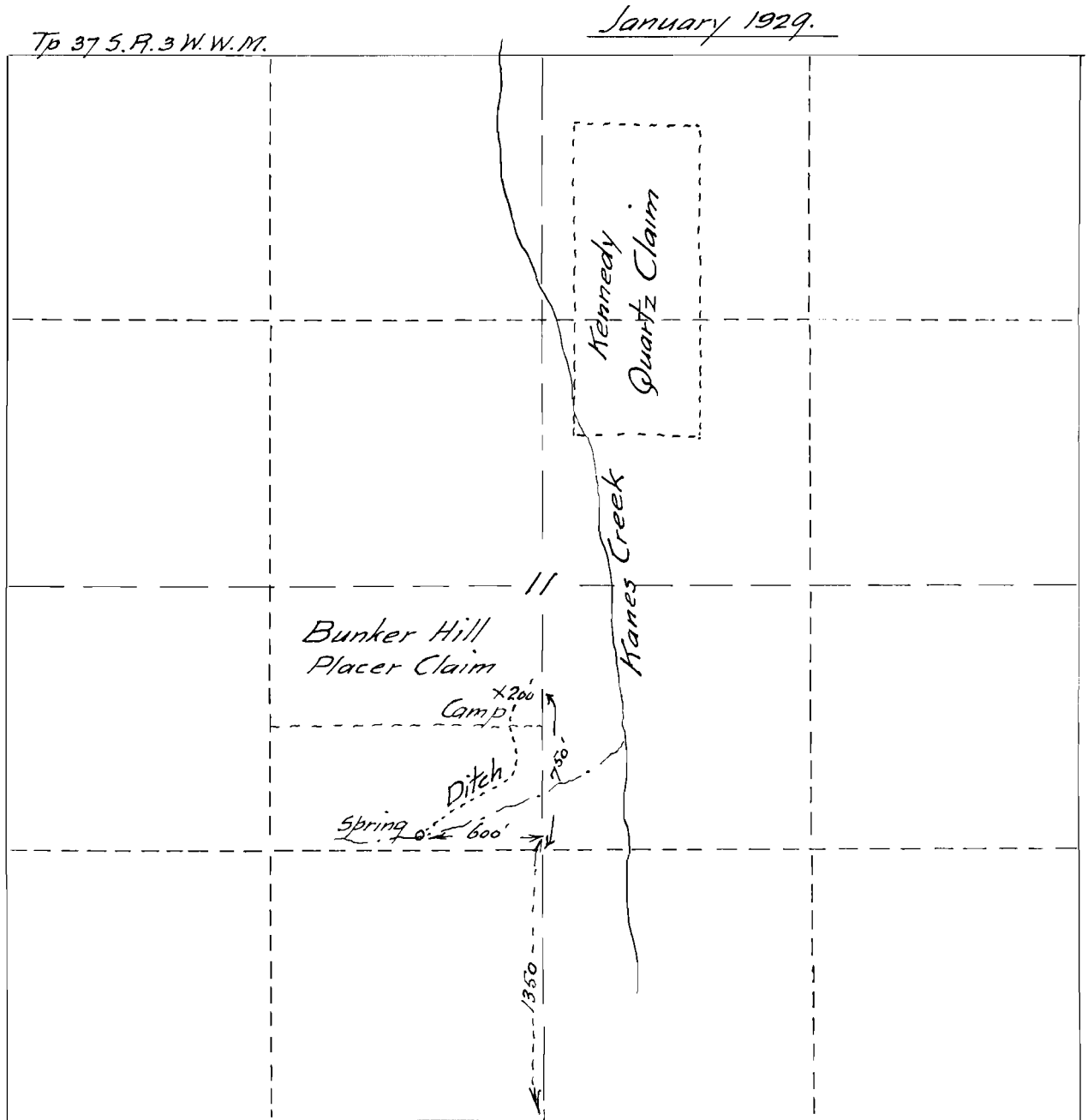

Map made from measurements taken by Mr Kennedy showing location of Spring and place of use; compiled by

Fred N. Cummings C.E.

Application No. 1117

Permit No. 1117