

HIGHLAND IRRIGATION DITCH

-1N-

SEC^s. 13, 14, 22, & 23. T.P. 32. S.R. 5.W.

SCALE 2" = 1 MILE

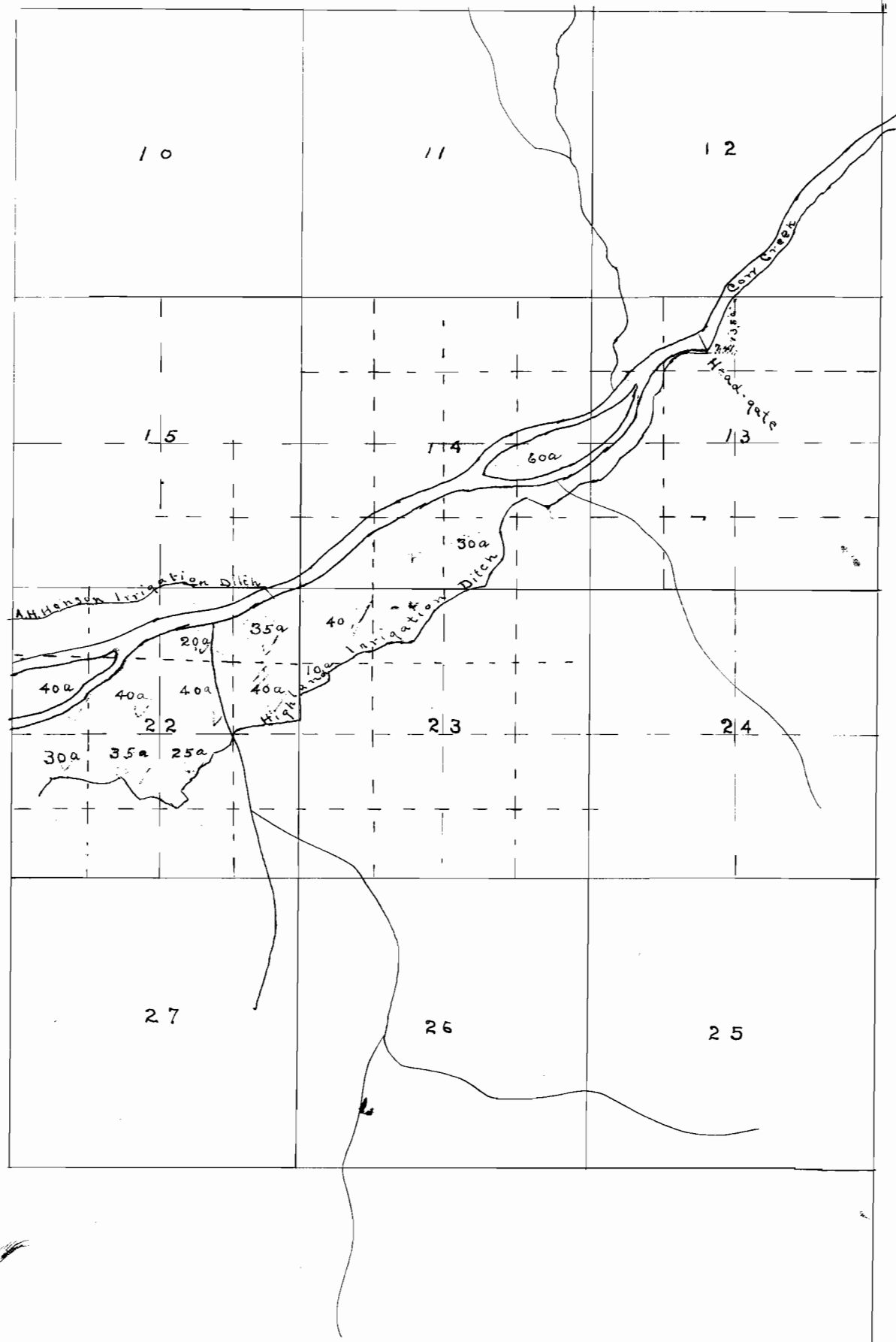

I, Frank Cain, of Riddle do hereby certify that this map was made from notes taken during an actual survey made by me on Nov. 22, 1909 and that it correctly represents the works described in the accompanying application, together with the location of streams and other ditches in the immediate vicinity, and has written thereon the area in each smallest legal subdivision which it is proposed to irrigate.

Frank Cain
Surveyor.

Application # 524, 1565
Permit # 245, 890