

Proposed  
Gray Ditch  
Benton County, Ore.  
Tp. 12 S. R. 6 W.  
Scale 1" = 40 chs.

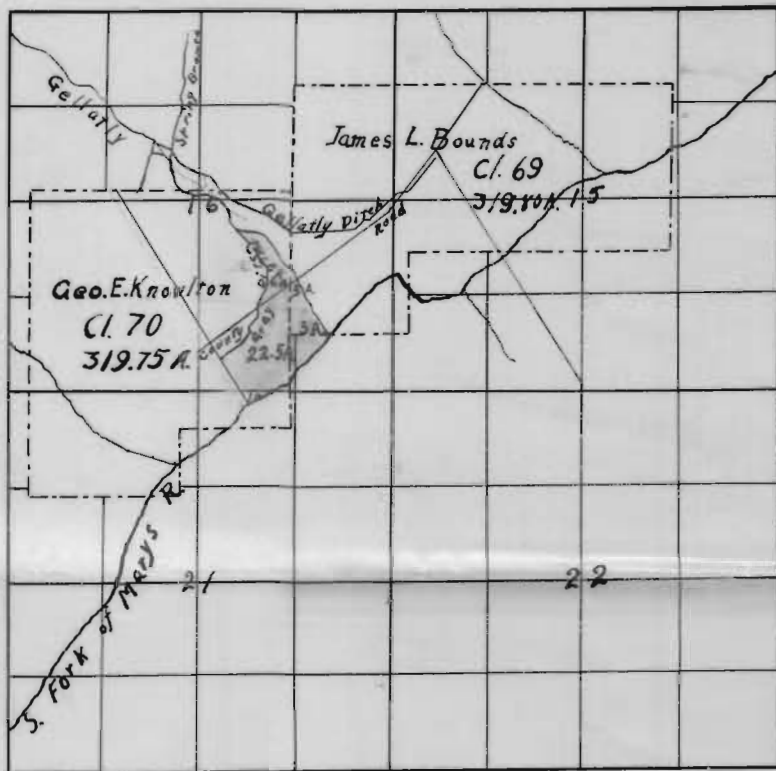

Traverse of Ditch Line  
Beginning at a point 8.47 chs. S. and 13.15 chs. W. of the N. E. cor. of Geo. E. Knowlton D.L.C. #70 in Tp. 12 S. R. 6 W. of Will. Mer. in Benton County, Oregon.

Sta.	Bearing	Distance
0-1	S. 59° 46' E.	254 Ft.
" 2	N. 80° 34' E.	57 "
" 3	S. 59° 52' E.	41 "
" 4	S. 31° 2' E.	42 "
" 5	S. 15° 20' E.	110 "
" 6	S. 37° 49' E.	222 "
" 7	S. 27° 33' E.	185 "
" 8	S. 11° 11' E.	73 "
" 9	S. 10° 20' W.	259 "
" 10	S. 20° 39' W.	157 " - 28' to road
" 11	S. 10° 9' E.	60 " - 15 to S fence
" 12	S. 22° W.	189 "
" 13	S. 42° 20' W.	111 "
" 14	S. 4° 26' E.	61 "
" 15	S. 39° 35' W.	221 "
"	S. 50° W.	95 "

Grade of ditch 1 ft. in 100 ft.  
Datum Assumed, Elev. 100 ft.  
B.M. Fir 3" in dia. S. 5° E. 5.6 ft.  
from sta. 0.

Sketch of head of ditch.  
Water taken out at bed  
of creek.

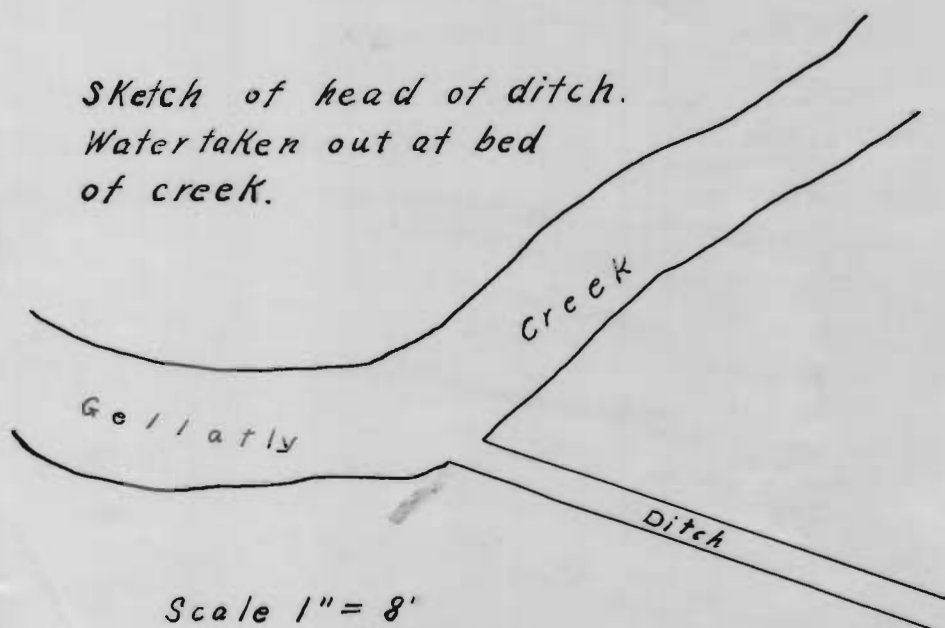

Scale 1" = 8'

Certificate of Surveyor.

I, W.C. Galloway of Corvallis do hereby certify that this map was made from notes taken during an actual survey made by me on Sept. 9th. and 11th, 1911, and that it correctly represents the works described in the accompanying application, together with the location of streams and other ditches in the immediate vicinity, and has written thereon the area in each smallest legal subdivision which it is proposed to irrigate.

W.C. Galloway  
Deputy Co. Eng.

OFFICE OF STATE ENGINEER  
RECEIVED  
SEP 23 1911  
SALEM, OREGON

Application No. 1688  
Permit No. 892