

T 9 S. R 45 E, W.M.

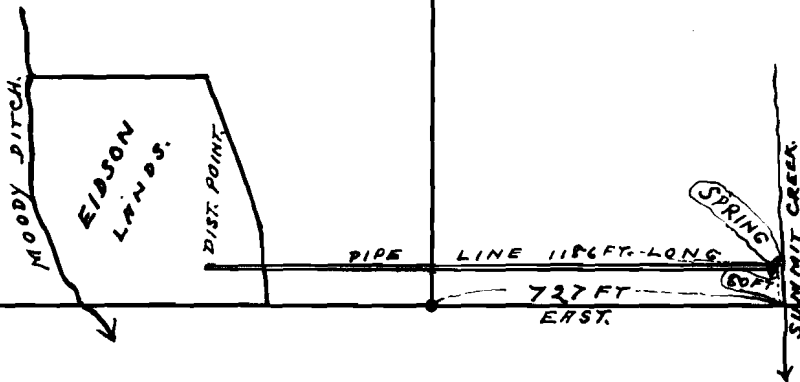

SKETCH

SHOWING

THE LOCATION OF THE EIDSON LANDS & PIPE LINE AND SPRING FROM WHICH THEY PROPOSE TO TAKE WATER FOR DOMESTIC USE, IN SEC. 10, T 9 S. R 45 E, W. M., BAKER CO., ORE.

SCALE, ONE INCH = 400 FT.

DRAWN BY

Ira L. Hoffman
County Surveyor

MARCH 19, 1929.

CERTIFICATE.

I, IRA L. HOFFMAN OF BAKER, ORE, DO HEREBY CERTIFY THAT THIS MAP WAS MADE FROM DATA FURNISHED BY THE APPLICANTS AND THAT IT CORRECTLY REPRESENTS THE SAID DATA. SHOWN THEREON.

REG. PROF. ENGINEER,
#90, ORE., NOV. 8, 1919.

Ira L. Hoffman
County Surveyor

12618

8388

RECORDED 1929