

North East Corner of the North West  $\frac{1}{4}$  of the North West  $\frac{1}{4}$  of  
Section 35 Township 6 South Range 11 West Lincoln County

This property is owned by Dan Rees, Otis, Oregon.

Dean

Application No. 18792

West Permit No. 9145

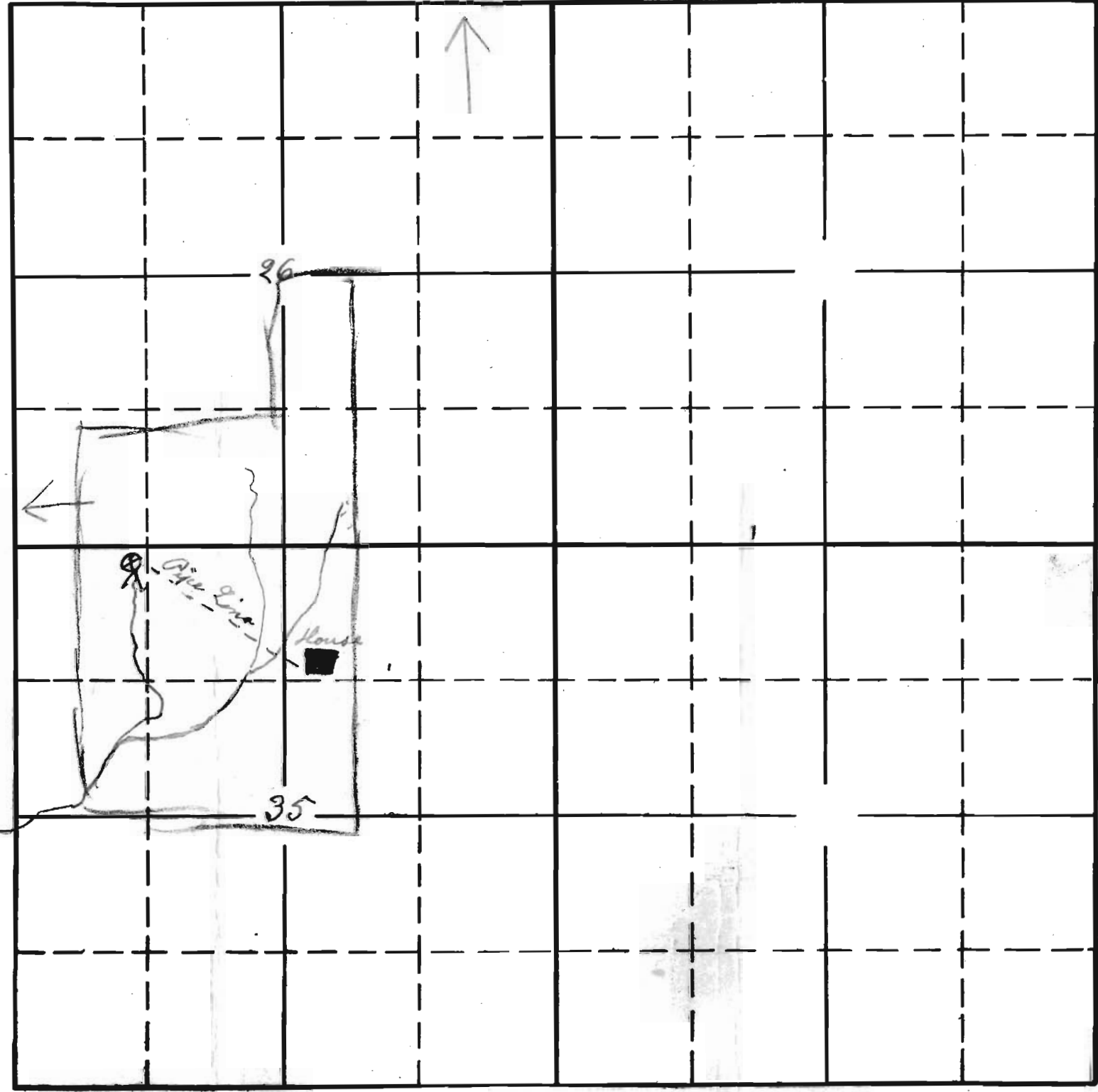

Sec. 35

Tp. 6 S.

R. 11 W.

West of the Willamette Meridian