

Map of the TAKILMA Ditch.

OFFICE OF STATE ENGINEER
RECEIVED
OCT 21 1911
SALEM, OREGON

Application No. 1791
Permit No. 929

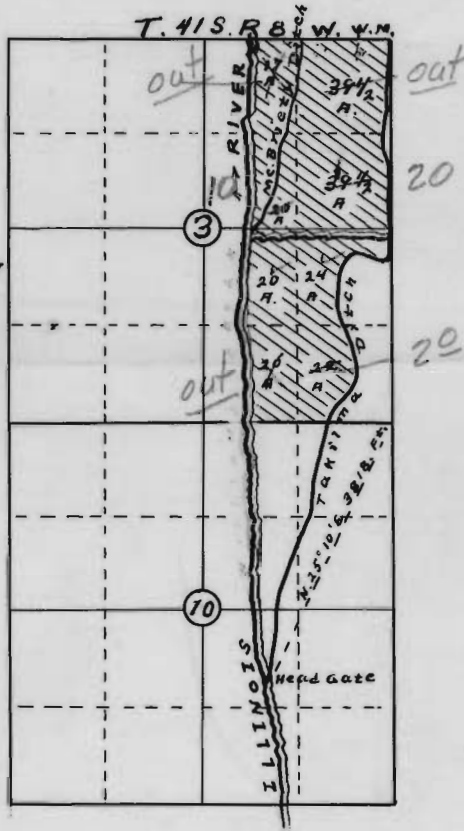

I, Horace C. Hall, of Grants Pass, Oregon, do hereby certify that this map was made from notes taken during an actual survey made by me on Sept. 26-28, 1911, and that it correctly represents the works described in the accompanying application, together with the location of streams and other ditches in the immediate vicinity and has written thereon the area in each smallest legal subdivision which it is proposed to irrigate.

Horace C. Hall
Surveyor.