

1793

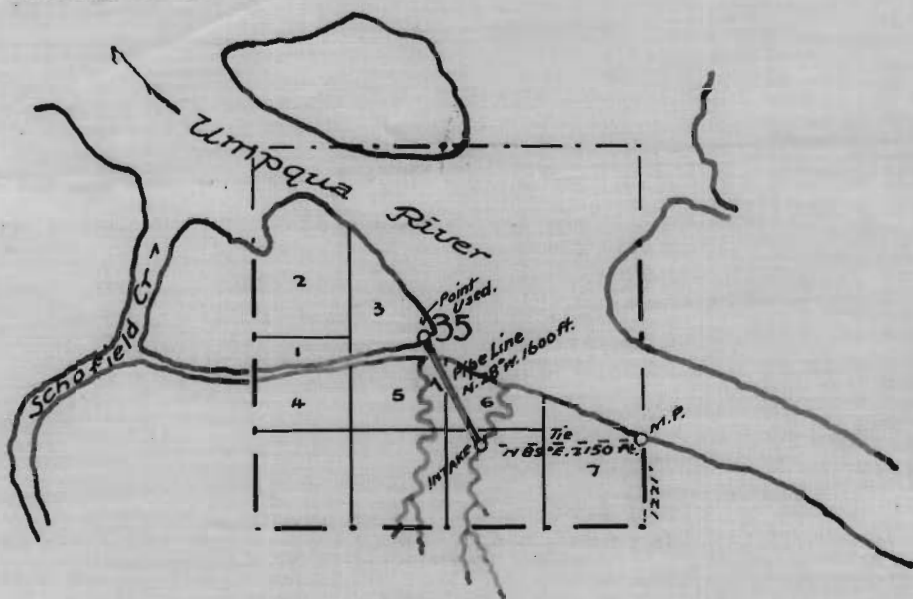

scale - 2" = 1-mile

Map showing proposed Water Appropriation
 in Section 35, Township 21 S., Range 12 West
 of Wil. Mer., Douglas Co., Oregon -

To accompany Application for Permit -
 to Hon. State Engineer -

Application No. 1793
 Permit No. 931

Survey by E.L. Robinson.
 - 1912-1911 -

OFFICE OF STATE ENGINEER
 RECEIVED
 OCT 21 1911
 SALEM, OREGON

1793