

North

Sec. 36

330' West
455' North

SE 1/4,
266 1/4
BWS 6,

TP. 55

R. 6 W

NW 1/4

NE 1/4

OUTLET
BRIDGE

PORTLAND TILLA MOOK - HIGHWAY

YAMHILL RIVER

POINT
OF
DIVERSION

330'

455'

Application No. 13071
Permit No. 9316

SW 1/4

SE 1/4

SECTION

36

TOWNSHIP 5-S, RANGE 6 W, W. M.

North

West

East

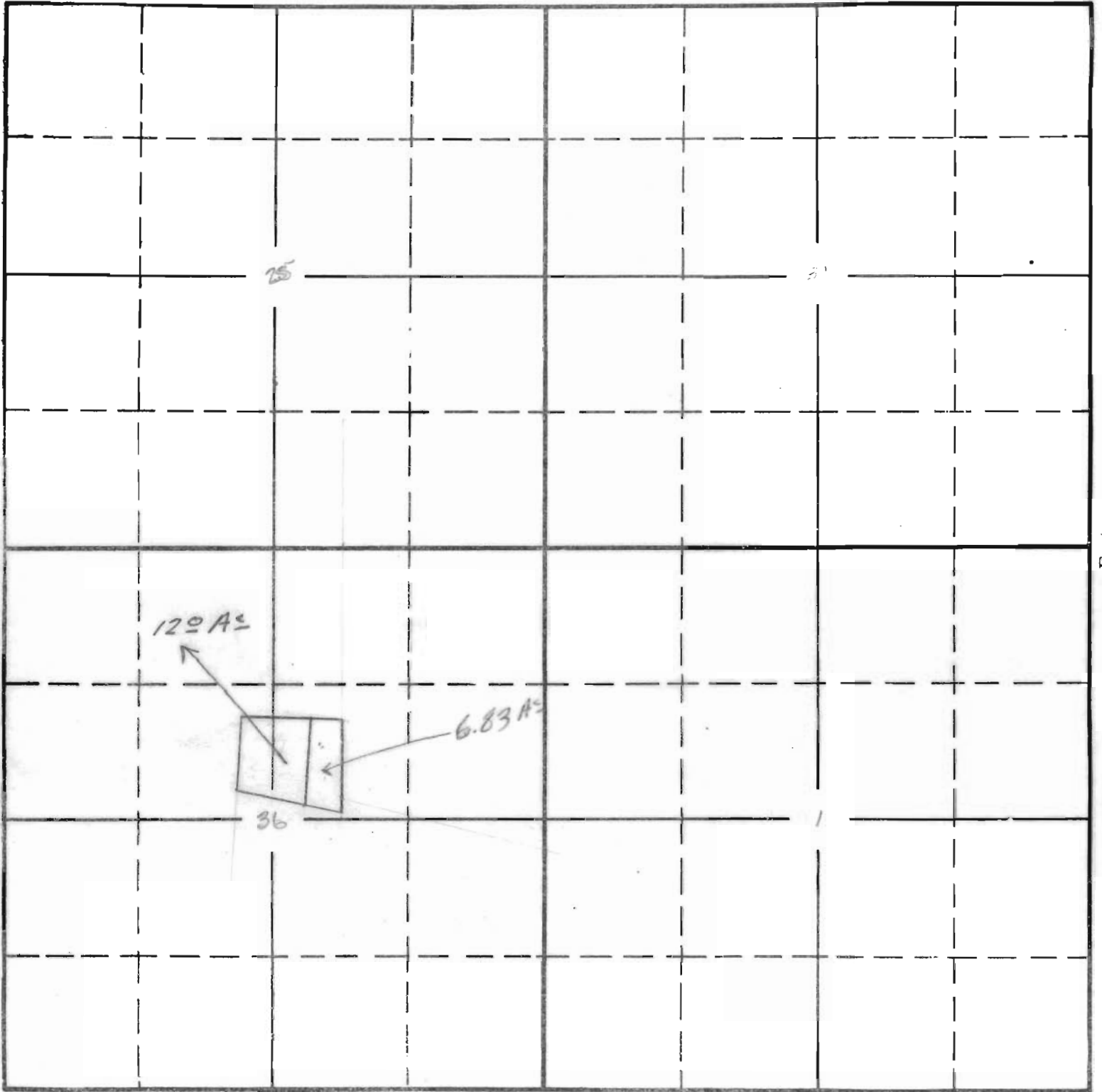

South

APPLICATION No.

9316

PERMIT No.

13071