

THE WILLOW VALLEY IRRIGATION DISTRICT.

Map accompany application for permit to appropriate water.
Scale 1" = 2000'

May 1920.

Application No. R-7397
Permit No. R-625

Application No. 7398
Permit No. 9416

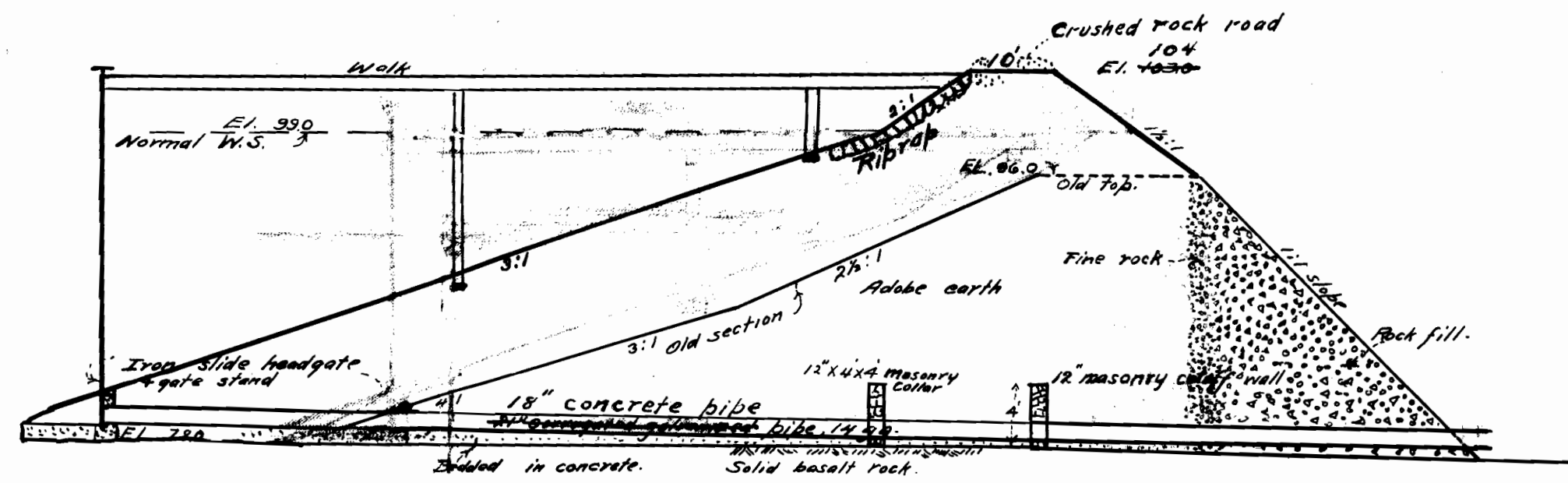
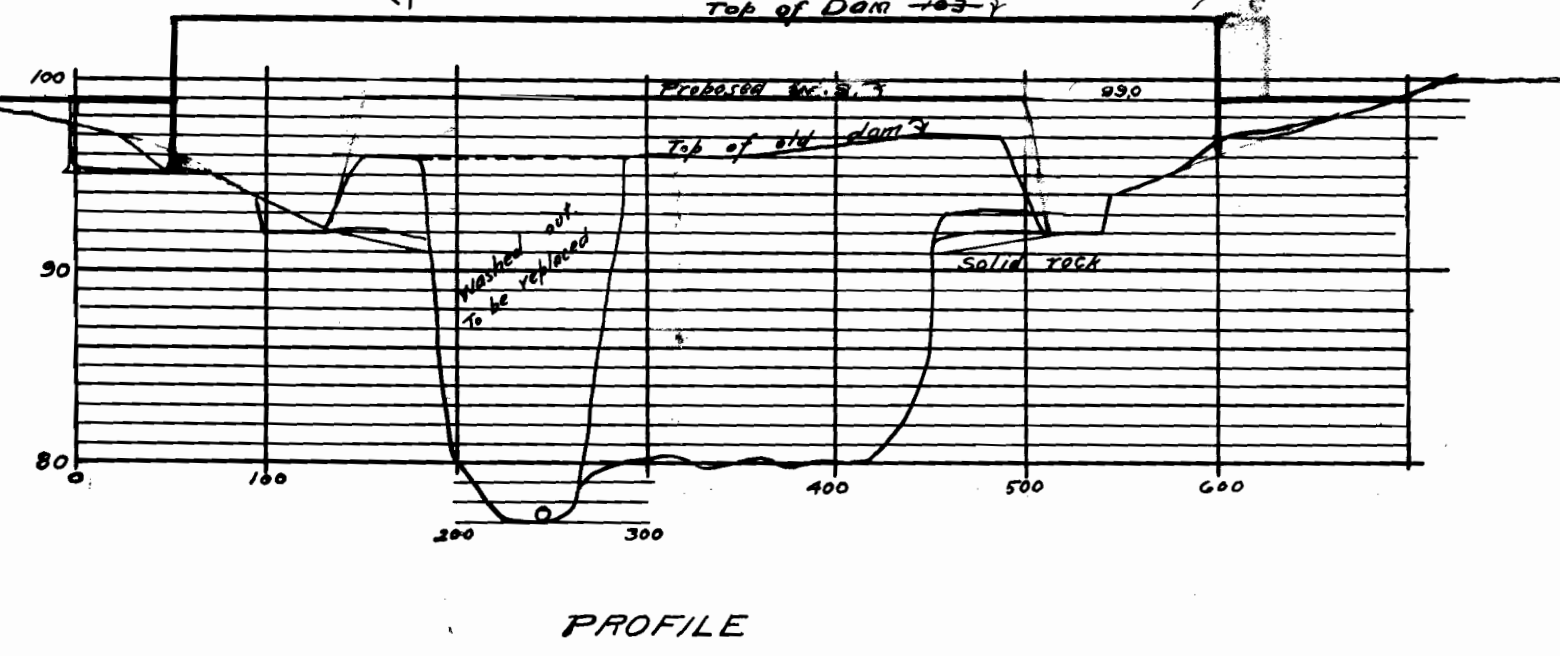
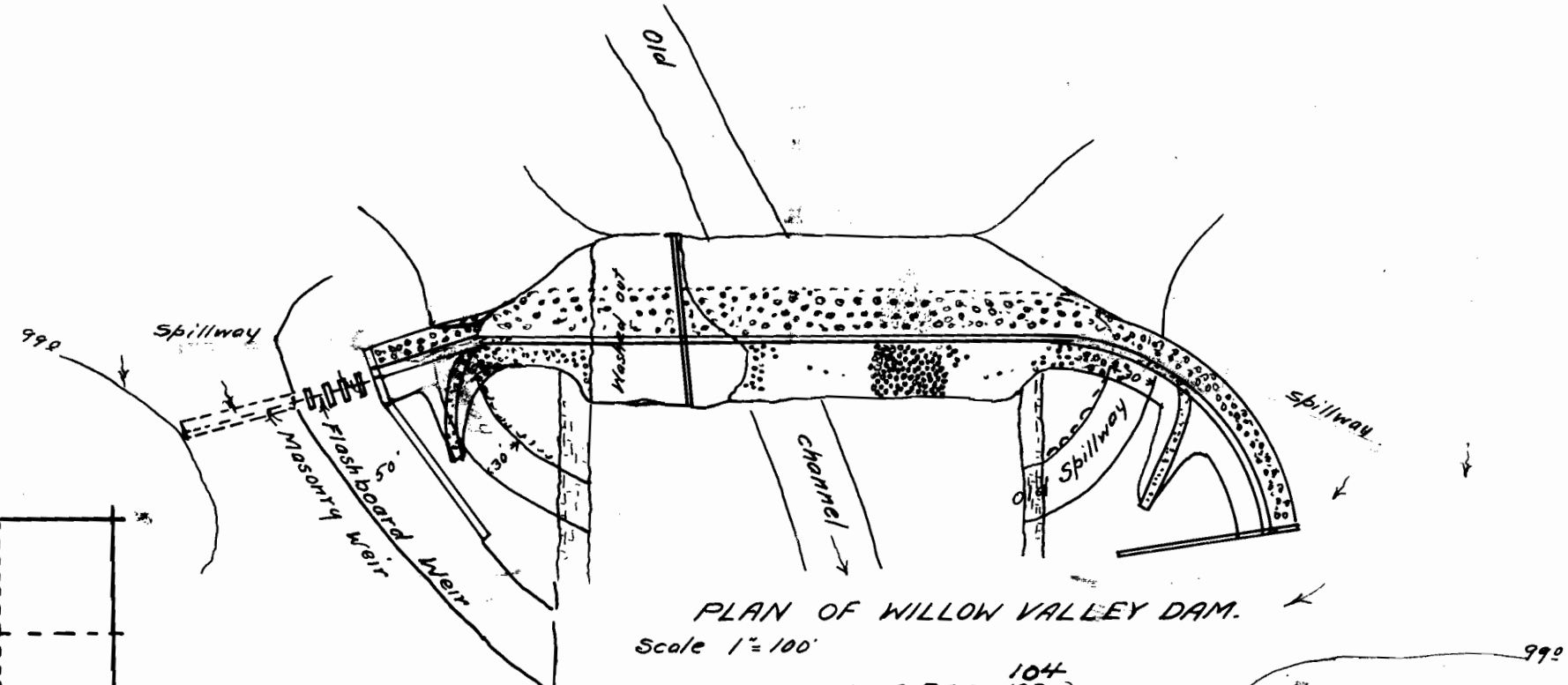
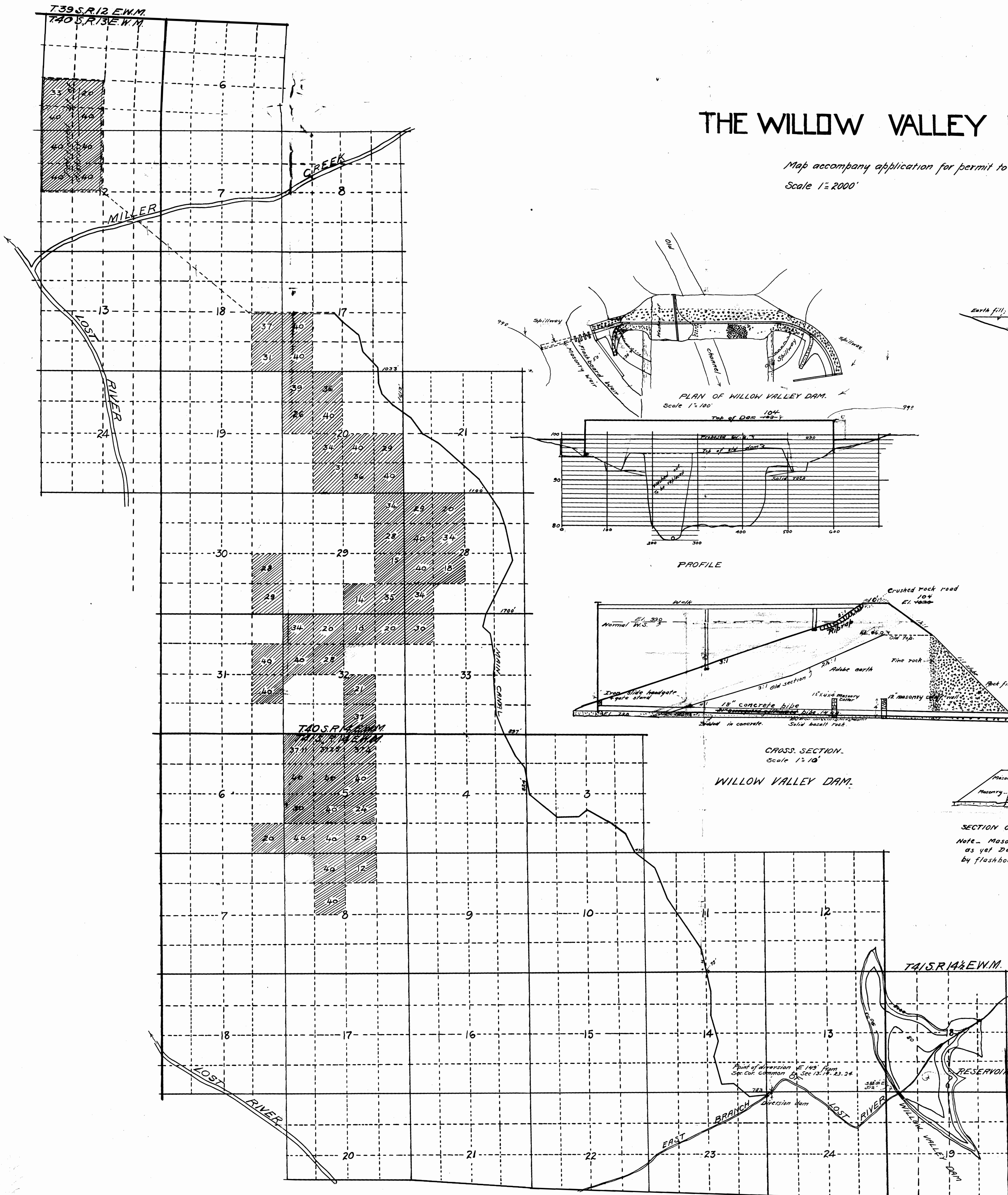

WILLOW VALLEY DAM.

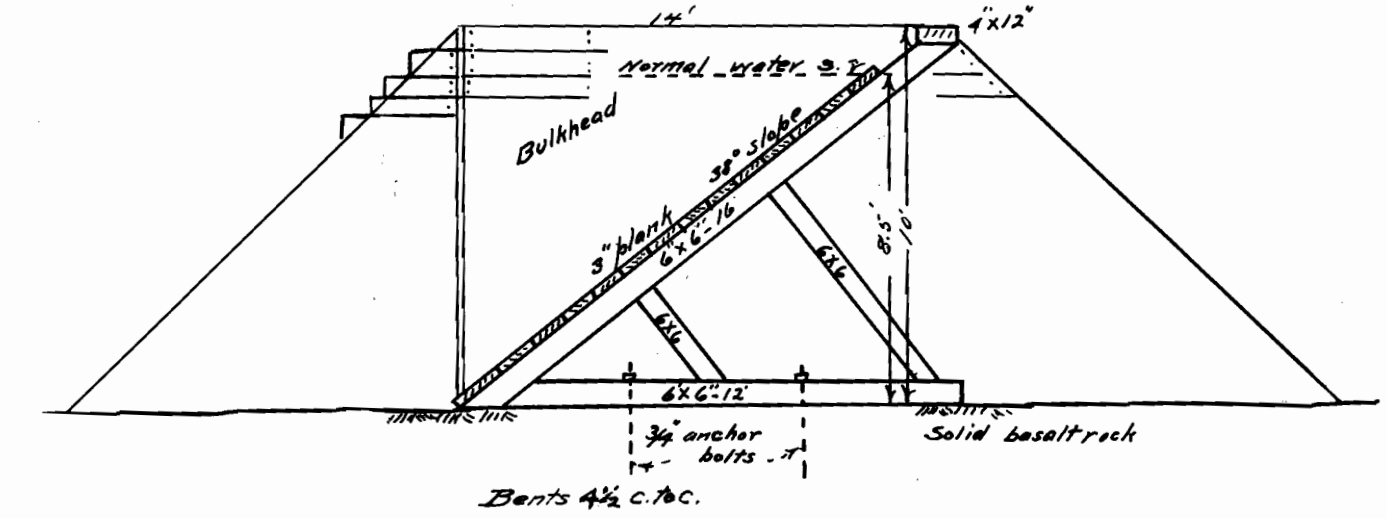
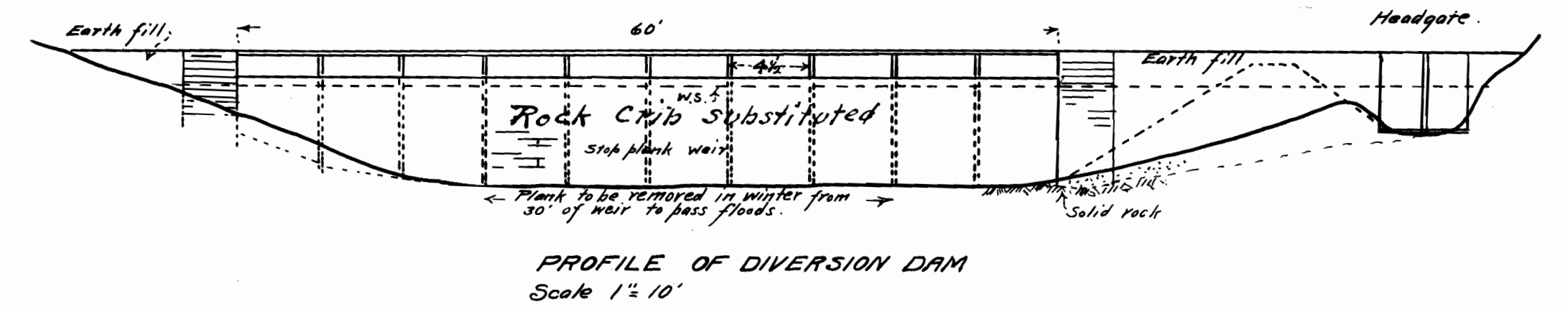

DIVERSION DAM.

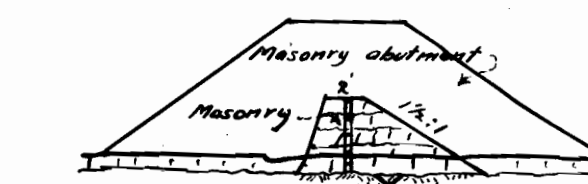

Note - Masonry weir not constructed as yet Dec. 1919. To be broken by flashboard weir.

Application No. 7397
Reservoir Permit No.
Application No. 7398

CERTIFICATE OF SURVEYOR

I, John C. Cleghorn, do hereby certify that this map was made from a map made from actual surveys made for R.F. Tuttle and Wm. Duncan under the supervision of E.B. Henry on Aug. 15, 1910 to Oct. 15, 1910 and so certified and sworn to by him on said map, and from a map made by C.T. Darley from notes taken during a survey said to have been made by him on April 22+30, 1918, and the plans for the dams were made from notes taken during an actual survey of the sites made by me on May 18, 1920, that I believe that this map correctly represents the streams and ditches in the immediate vicinity.

Klamath Falls, Ore.
May 27, 1920.

John C. Cleghorn

John C. Cleghorn

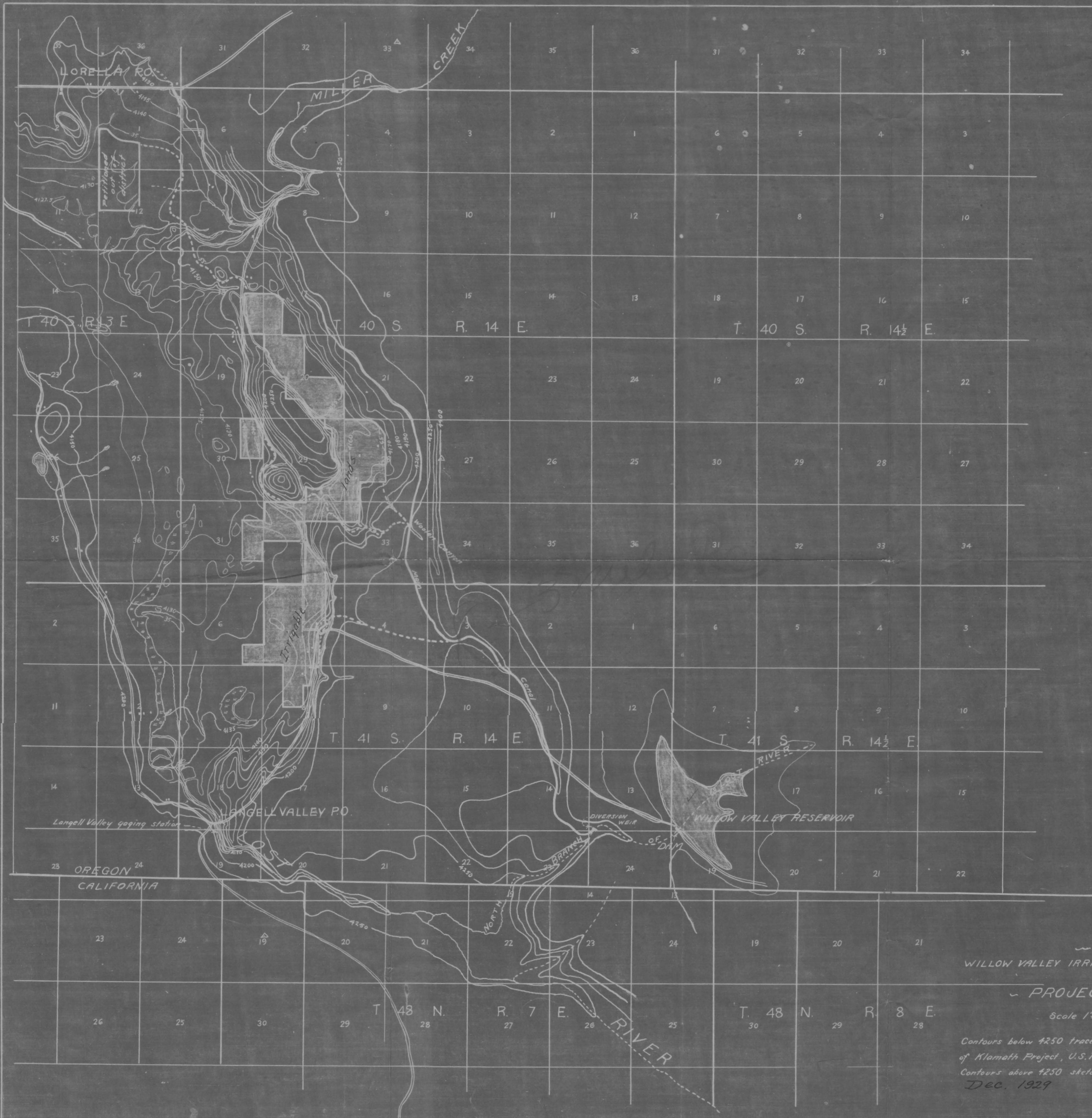

Application No. R-774
 Permit No. R-625

Application No. 7398
 Permit No. 946

WILLOW VALLEY IRRIGATION DISTRICT

PROJECT MAP

Scale 1" = 400'

Contours below 4250 traced from project map
 of Klamath Project, U.S. Reclamation Service -
 Contours above 4250 sketched by me.
 Dec. 1929

