

Sec. 5

Tr. 35

R. 3E

T. 2 S.
T. 3 S.

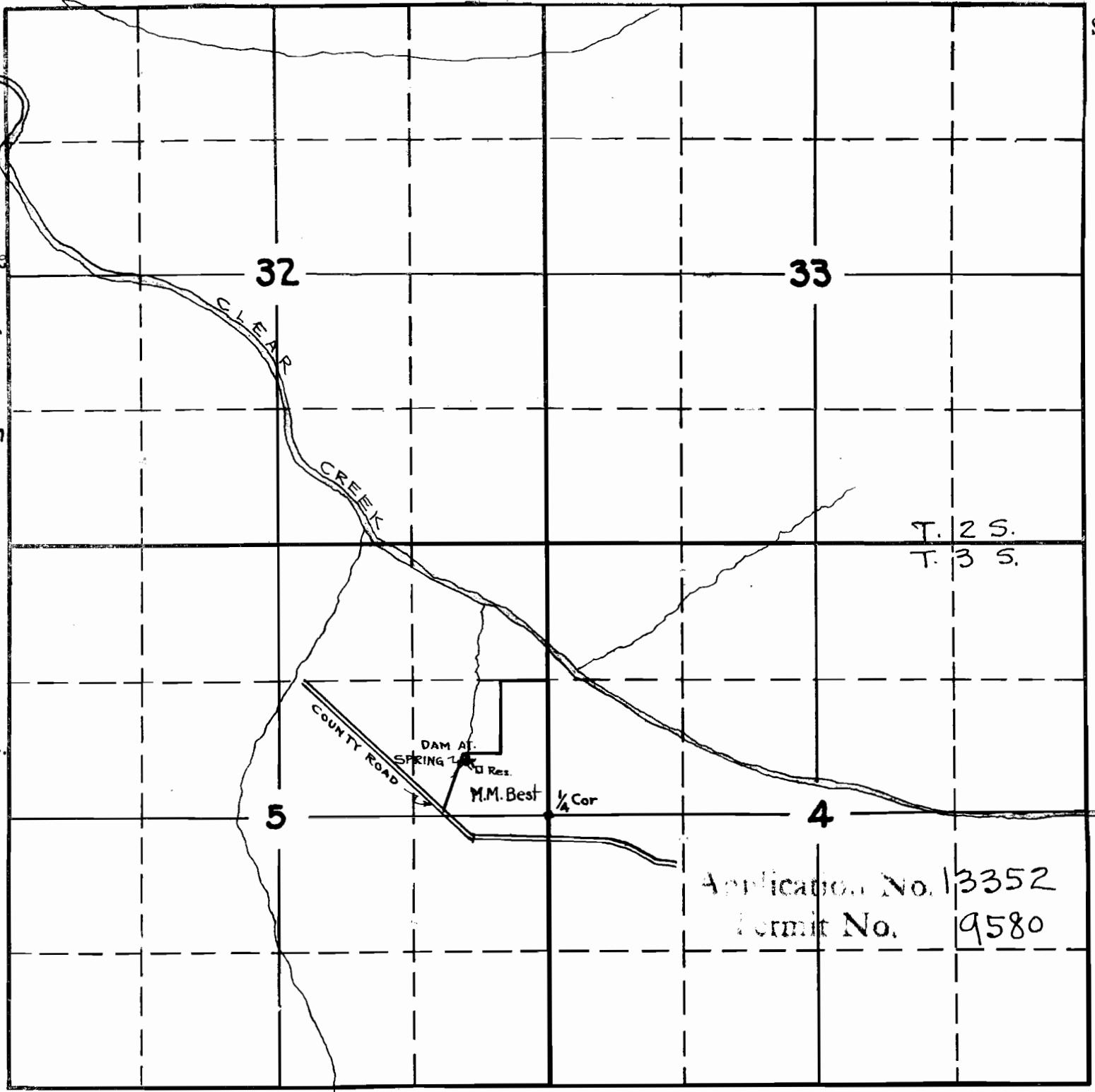

Map

To accompany application of Minnie M. Best for permit to appropriate water from un-named Spring Situated in the SE⁴ of the NE⁴ of Section 5 T. 35. R. 3E of the W.M. Clackamas County Oregon.

The location of the Spring is 8 chains North and 12.50 Chs. West of the $\frac{1}{4}$ Sec. Cor. between Sec. 4 and 5 T. 35 R. 3E.

Pipe line to extend from Spring in a southeasterly direction approx. 175 feet to Res.

Dam to be built at Spring

Application No. 13352
Permit No. 9580