

LITTLE DADS CREEK

Map to accompany application for permit to appropriate the waters of Little Dad's Creek tributary to Cow Creek in the S.W. 1/4 of Sec. 8 T. 31 S. R. 7 W. W.M. Douglas County, Oregon, by the Southern Pacific Co.

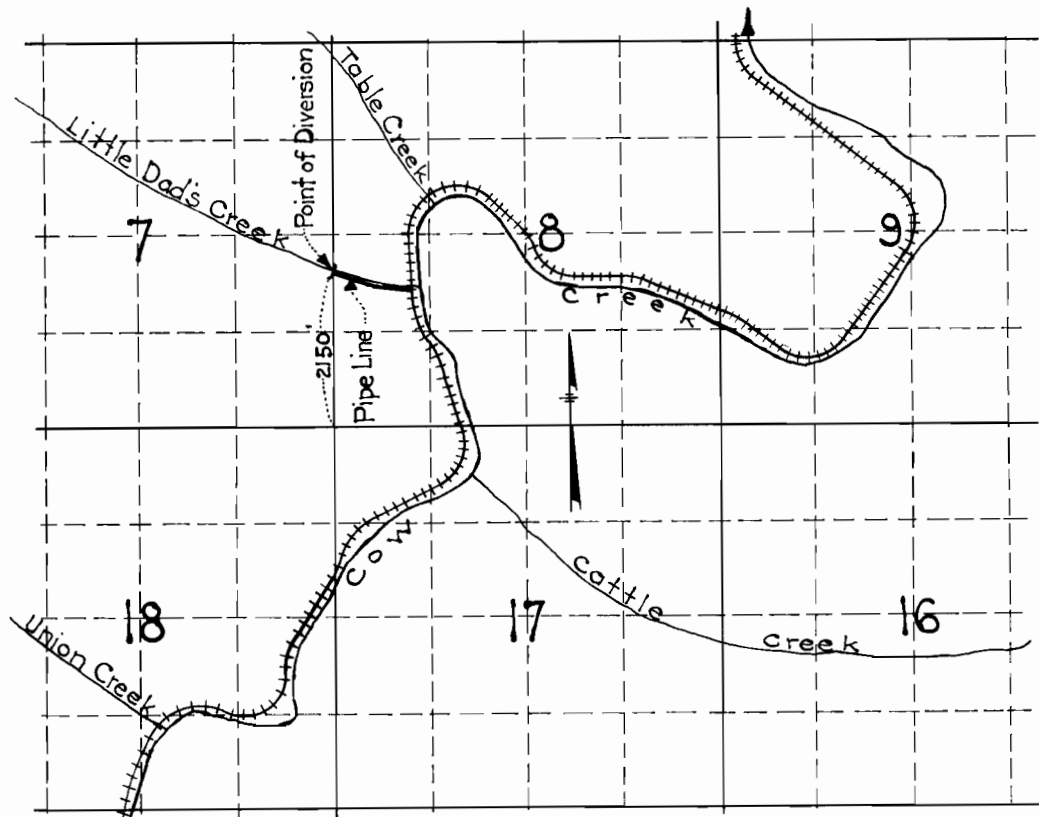

Scale 2" = 1 Mi.

Application No. 13367

Amended No. 9589

I, G. Haselton, of Portland, Oregon, do hereby certify that this map was made from notes taken during an actual survey made under my supervision on September 13, 1929 and that it correctly represents the works described in the accompanying application, together with the location of streams and ditches in the immediate vicinity.

G. Haselton

Registered Engineer No. 140
State of Oregon.