

NE $\frac{1}{4}$ of SE $\frac{1}{4}$

Sec. 23

Tp. 8 N

R. 8 W

23

24

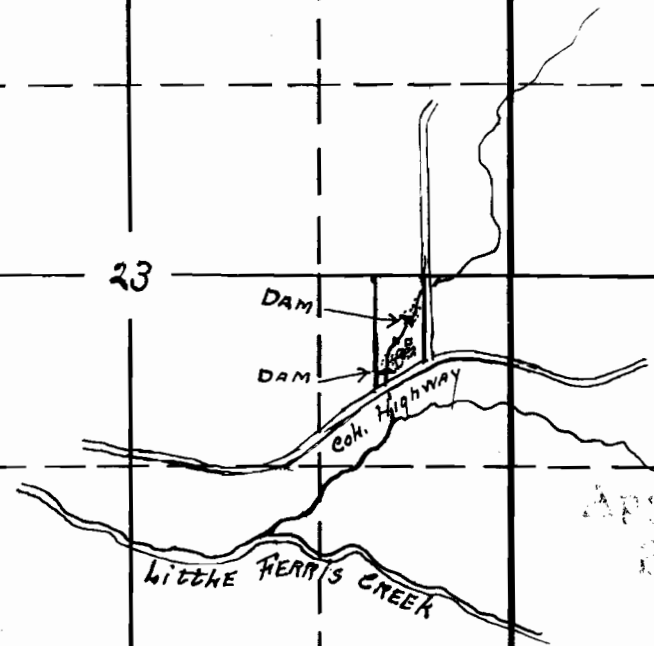

Application No. 13377
Permit No. 9606

DIAGRAM of Applicant's PROPERTY

(SCALE ABOUT 100ft TO INCH.)

5 ACRES in NE 1/4 & SE 1/4 SEC. 23, T. 8. N. R. 8. W

680' to 1/4 COR. bet. SECS 23 & 24

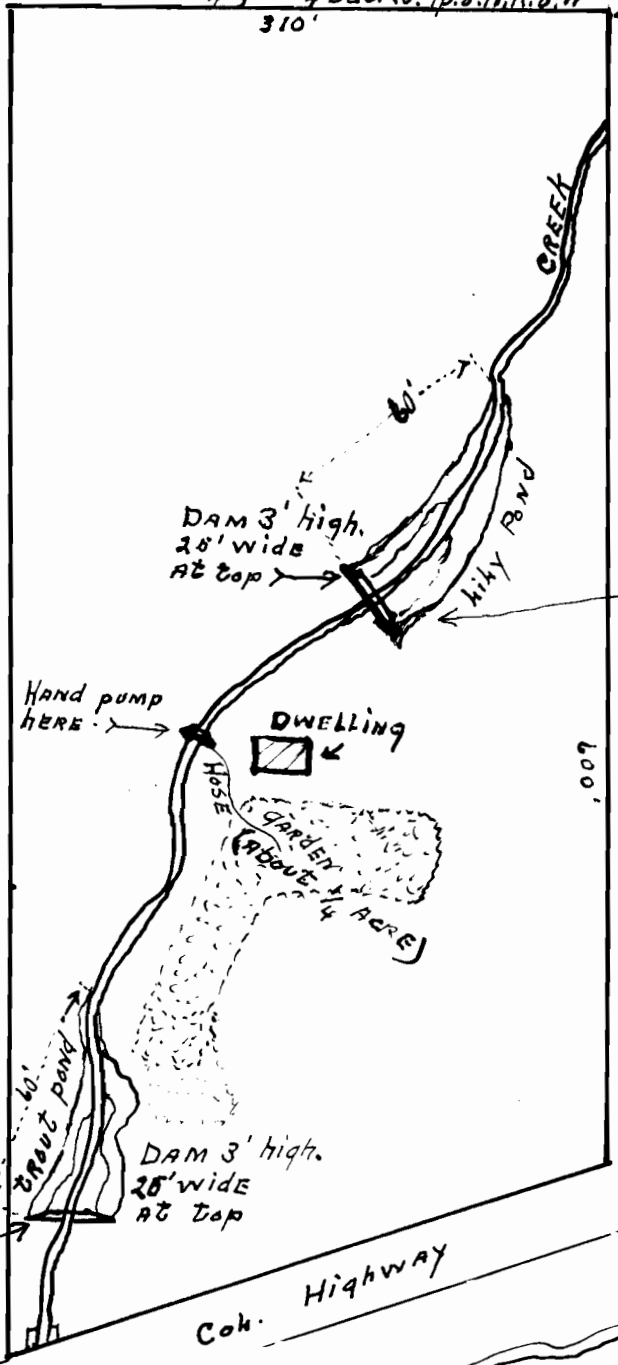
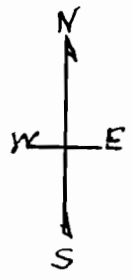

DAM 3' high.
28' wide
at top

WILLY POND

Hand pump
here

DWELLING

GARDEN
(ABOUT 1/4 ACRE)

DAM 3' high.
28' wide
at top

TROUT POND

600'
Road

Coh. Highway

LOCATED 775' W. AND 275' S. of
1/4 COR. BETWEEN SECS. 23 AND 24

LOCATED 950' W. AND
675' S. of 1/4 COR. of
SECS. 23 AND 24

13377
9606

Handwritten notes on the left side of the diagram, including the word 'HOLD' and other illegible scribbles.