

Profile of Pumping Plant  
Accompanying Application  
of  
Roscoe Starr

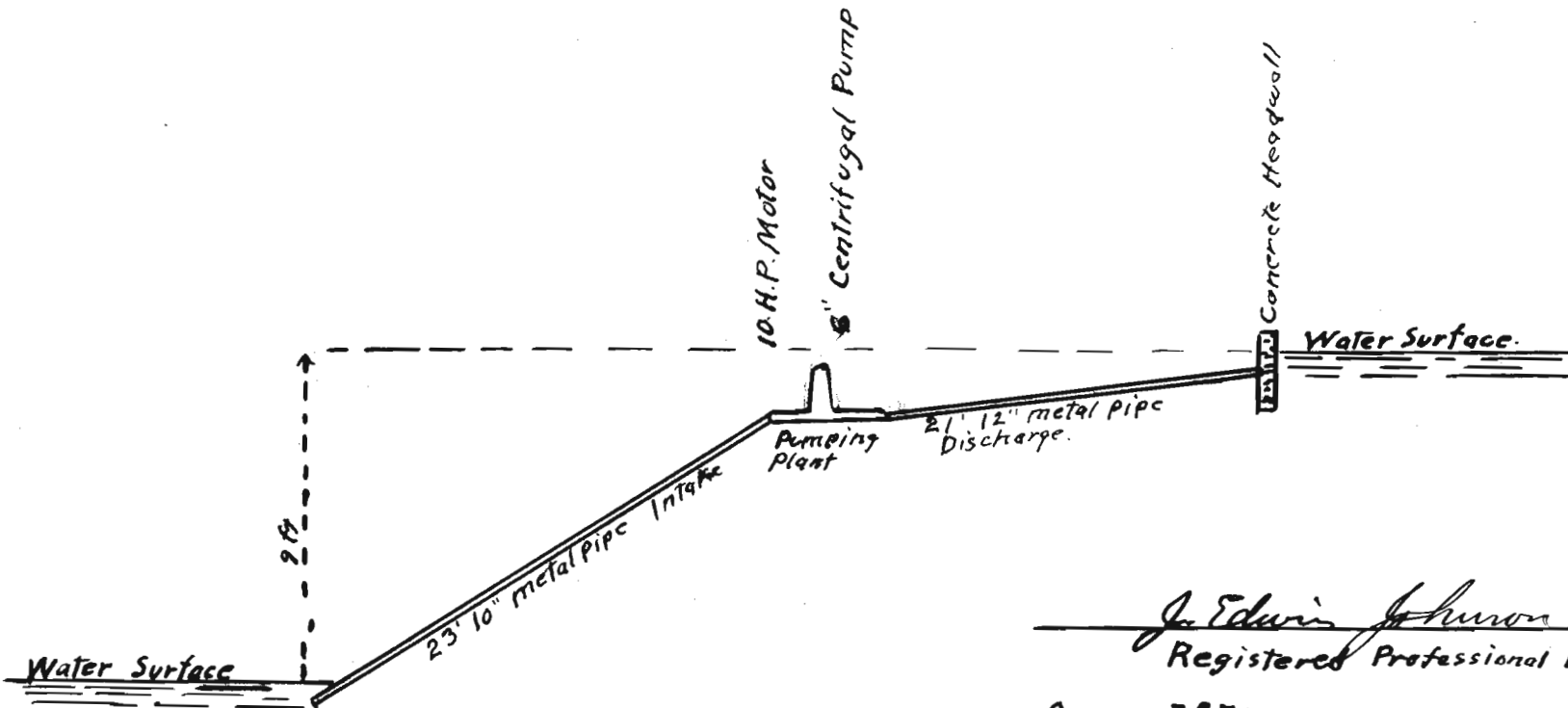

*J. Edwin Johnson*  
Registered Professional Engineer  
Oregon 787.

Application No. 13484  
Permit No. 9683

MAP  
 ACCOMPANYING APPLICATION  
 OF  
 ROSCOE STARR  
 Ontario, Oregon.

Scale, 2" = 1 mile

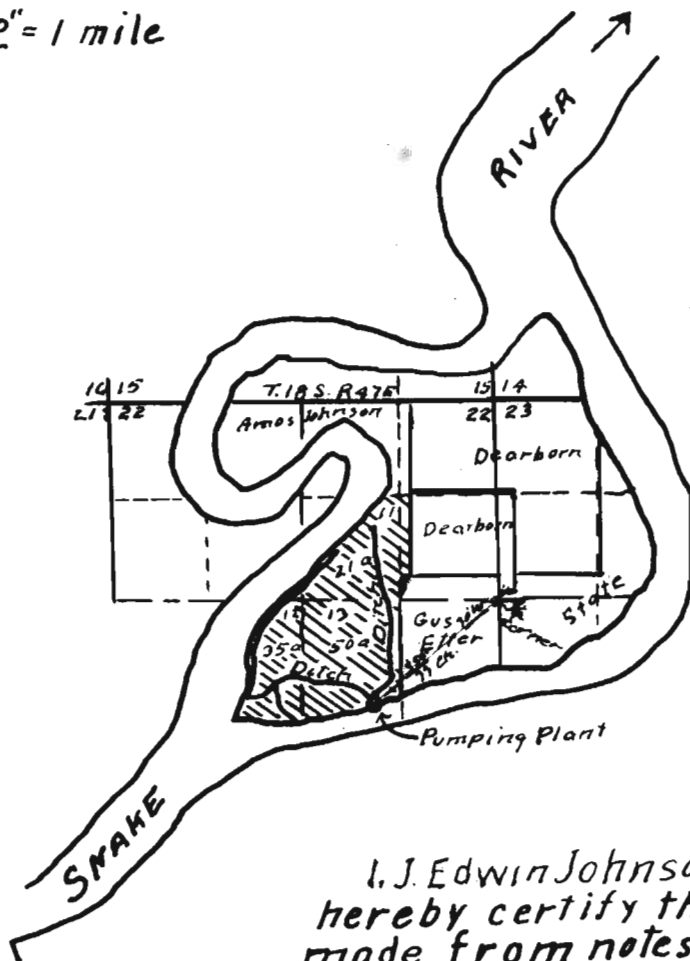

Legend.

Shaded part represents  
 lands described in  
 application

I, J. Edwin Johnson, of Vale, Oregon, do hereby certify that this map was made from notes taken during an actual survey made by me, May 24, 1930, and that it correctly represents the works described in the accompanying application, together with the location of streams and other ditches in the immediate vicinity

*J. Edwin Johnson*  
 Registered Professional Eng.

Oregon No 787.

Dec. 31, 1919

App. No. 13484  
 Perm. No. 9683