

SURVEYORS CERTIFICATE

I, W.E. Anderson of Tillamook, County, Oregon do hereby certify that this map was made from a map made by D.F. Austin in May 1910, and which map is marked Application # 661, Permit # 341. And that the Location of Rivers, pipe Line etc are correct, and according to the accompanying map.

County Surveyor

W.E. Anderson

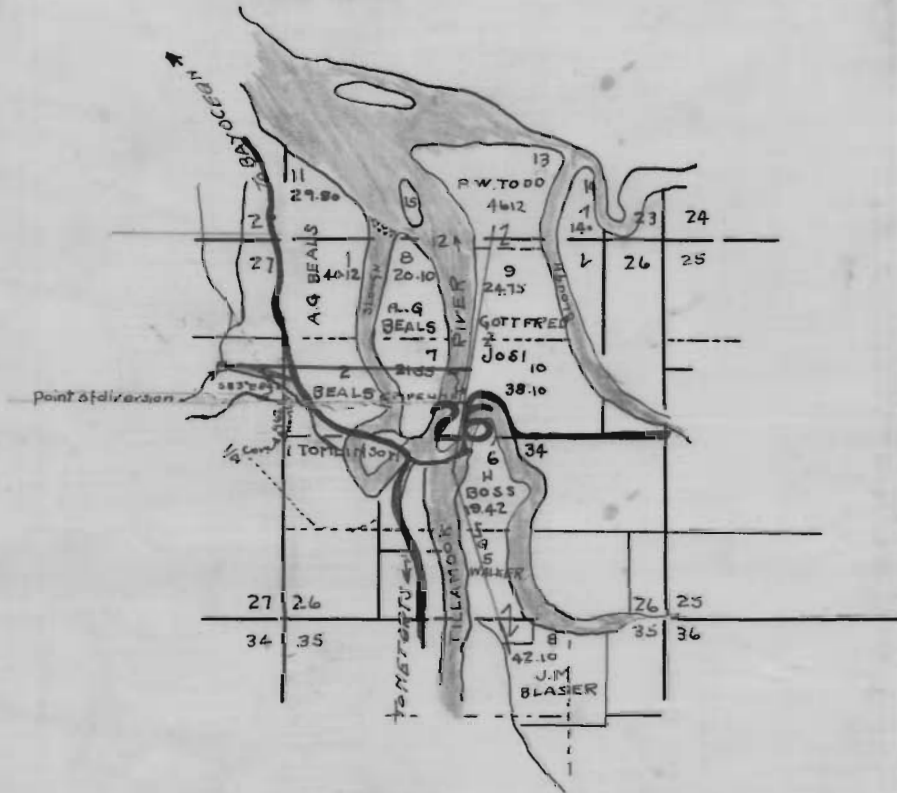

Application No. 13369

Permit No. 9733

WATER RIGHT.

FOR

A.G. BEALS - P.W. TODD - J. JOSI - E. BENSCHIDT - J.M. BLASER - H. BOSS - G. WALKER.

Located in Sec 26-27-35 T. 15. R. 10. W. 11

Scale 2" = 1 Mile.

1930. 1930.