

N.

T 12 S. R 37 E, W.M.

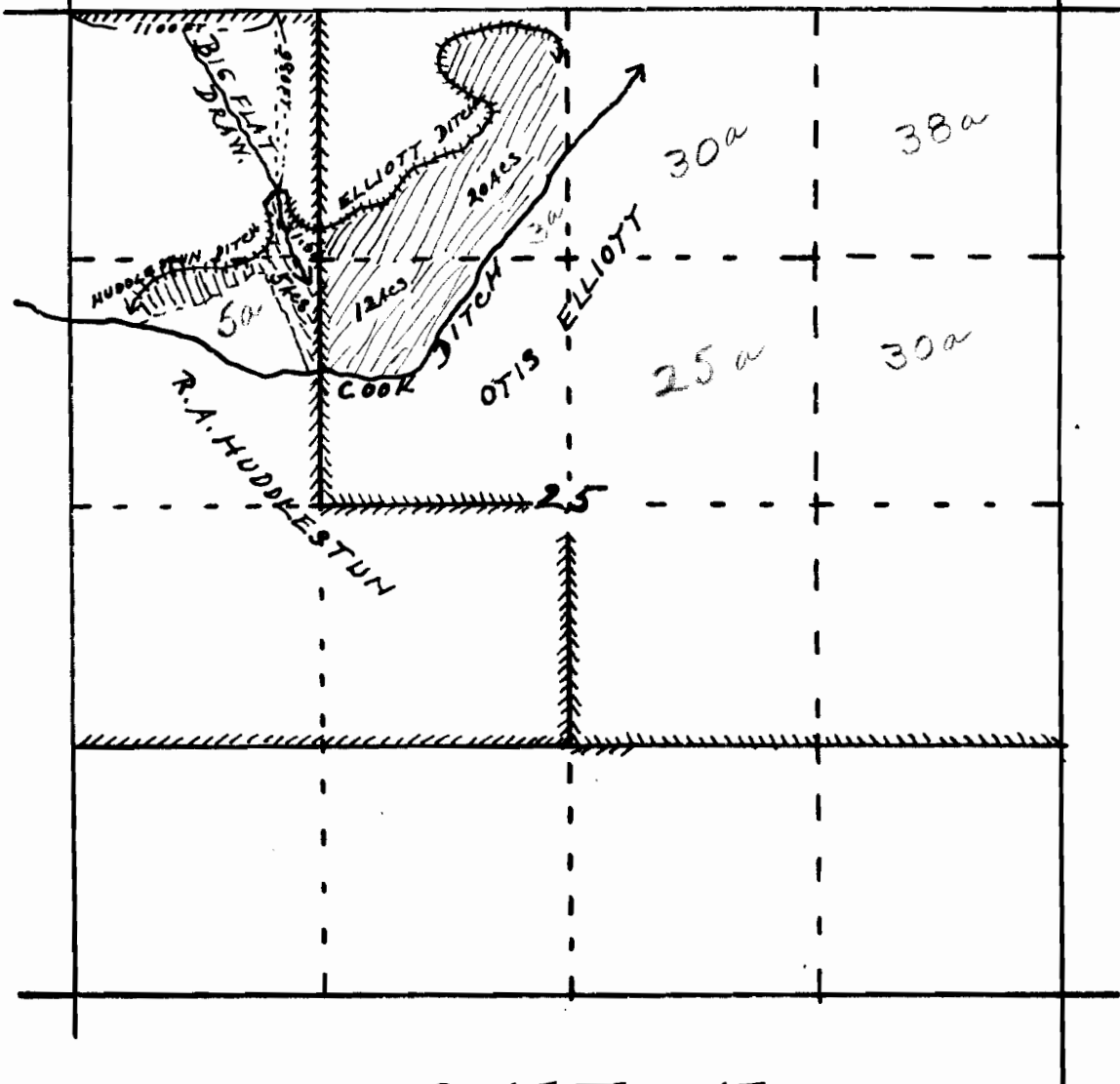

### SKETCH

SHOWING

THE LOCATION OF THE ELLIOTT + HUDDLESTIN DITCHES IN SEC. 25, T 12 S. R 37 E + LANDS TO BE IRRIGATED THEREFROM.

SCALE, ONE INCH = 1000 FT.

SURVEY MADE, JUNE, 19, 1930

*Ira L. Hoffman*  
County Surveyor.

### CERTIFICATE.

I, IRA L. HOFFMAN OF BAKER, OREGON DO HEREBY CERTIFY THAT THIS SKETCH WAS MADE FROM NOTES TAKEN DURING AN ACTUAL SURVEY MADE, JUNE 19, 1930 AND THAT IT CORRECTLY REPRESENTS THE DATA SHOWN THEREON.

*Ira L. Hoffman*  
REG. PROF. ENGINEER.

OREGON N<sup>o</sup> 90, NOV. 8, 1919.

Application No. 13399  
Permit No. 9738

SECTION

TOWNSHIP 125, RANGE 37 E, W. M.

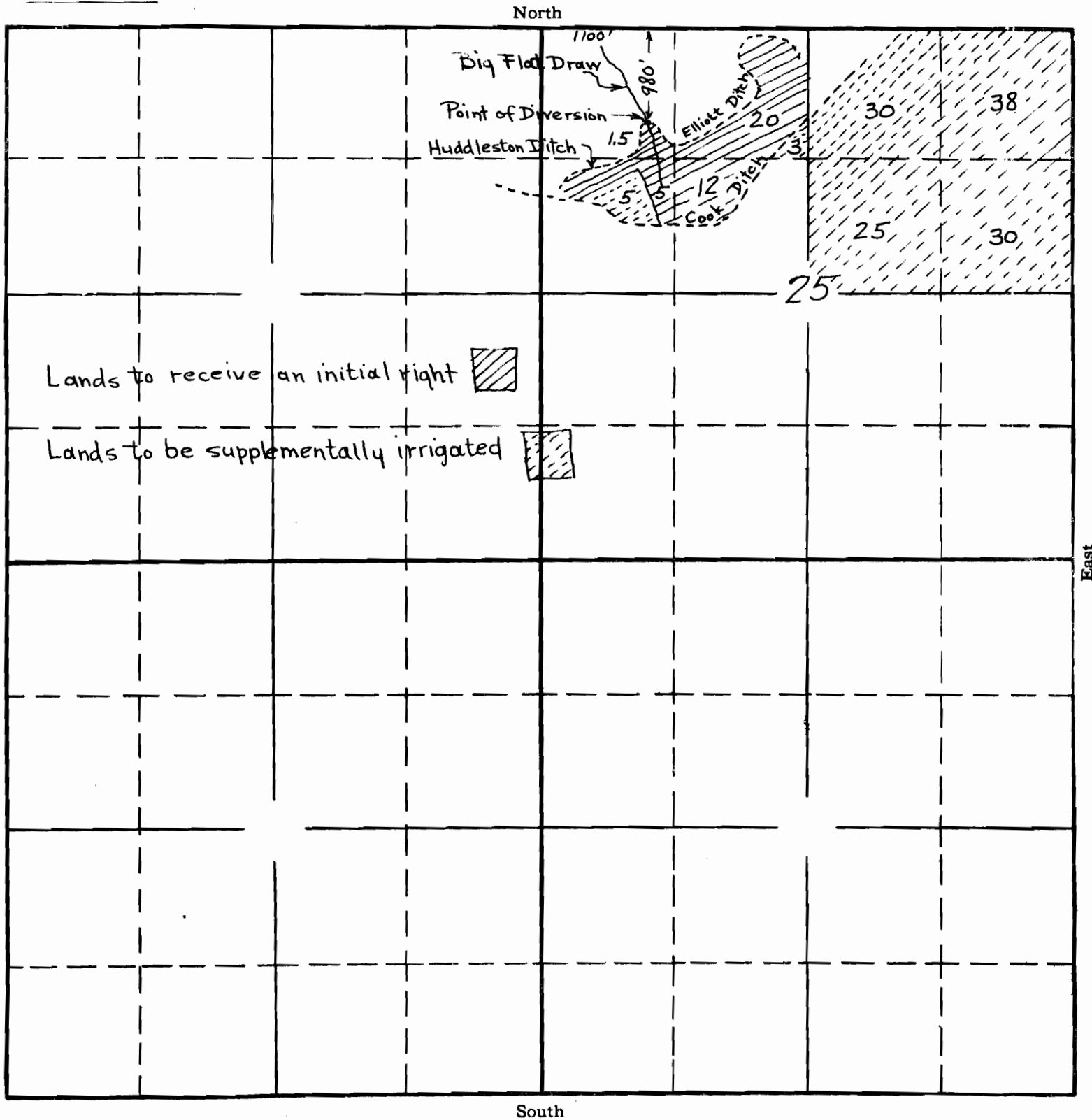



APPLICATION No. 13399  
PERMIT No. 9738

*Official  
Map*

TOWNSHIP 125, RANGE 37E, W. M.

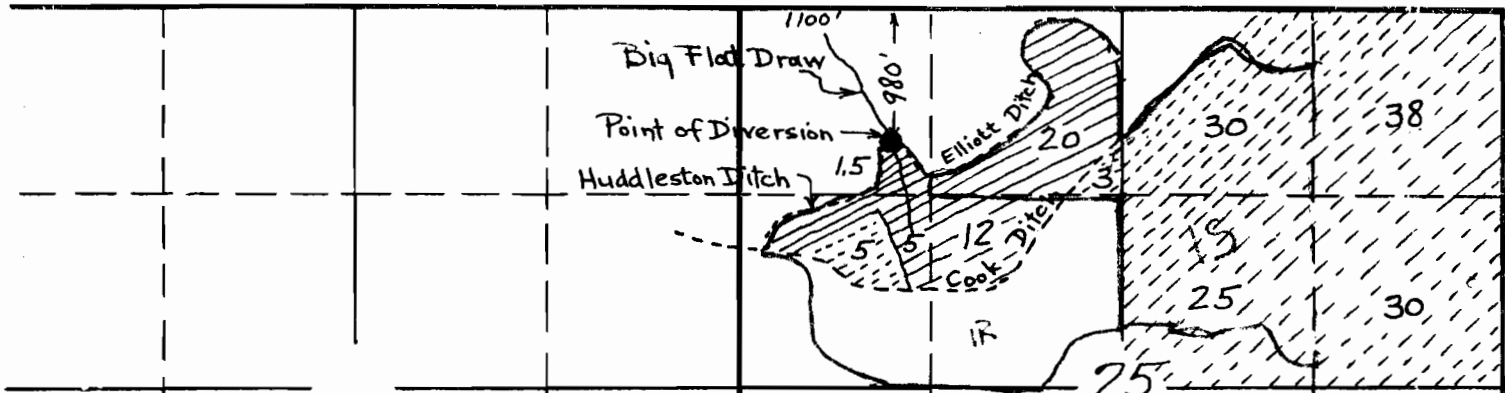
North



Lands to receive an initial right 

Lands to be supplementally irrigated 

*See Decree  
map*

South

East