

MAP

Accompanying final proof of L. H. Wertz of Climax Oregon App. No 13693  
Permit No 9869 to waters of Unnamed Spring and Antelope Creek  
tributary to Little Butte Creek Jackson County Oregon for Domestic  
and Irrigation Purposes

Dec 12, 1930

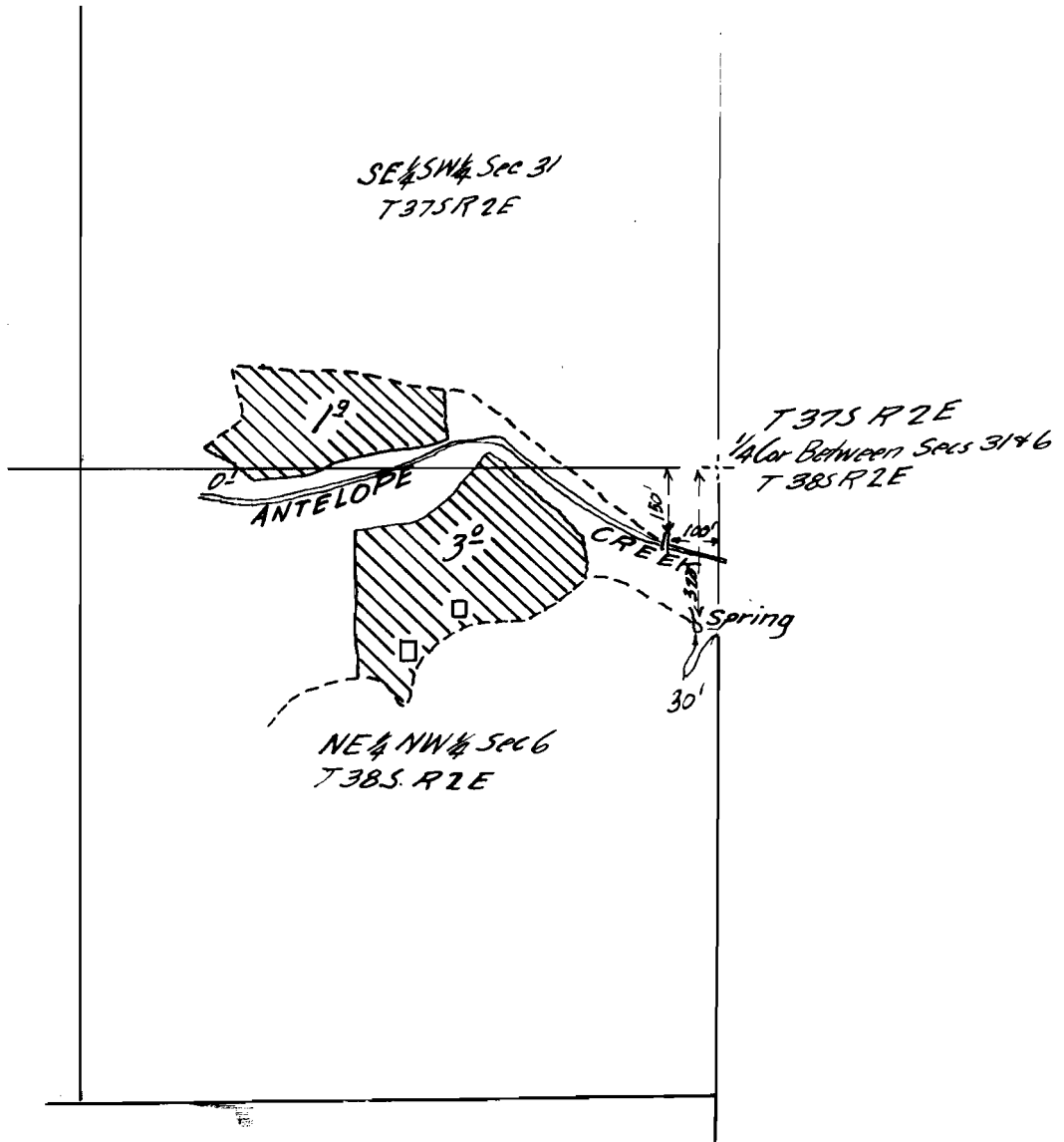

Map made from Plane Table Survey by Chester A. Cummings

SECTION

TOWNSHIP <sup>37</sup>385, RANGE 2E, W. M.

North

31

32

West

East

T. 37 S., R. 2 E., W. M.

T. 38 S., R. 2 E., W. M.

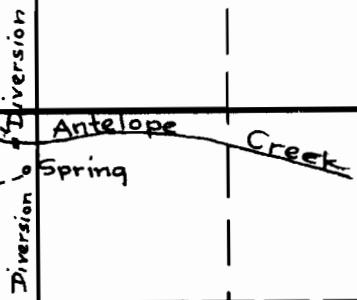

6

5

South

APPLICATION No. 13693  
PERMIT No. 9869