

MAP
SHOWING LOCATION
OF

J. W. FARLEY

Lands and Ditches

By Rhca Luper Dec 20 1911

Scale 2" = 1 mile

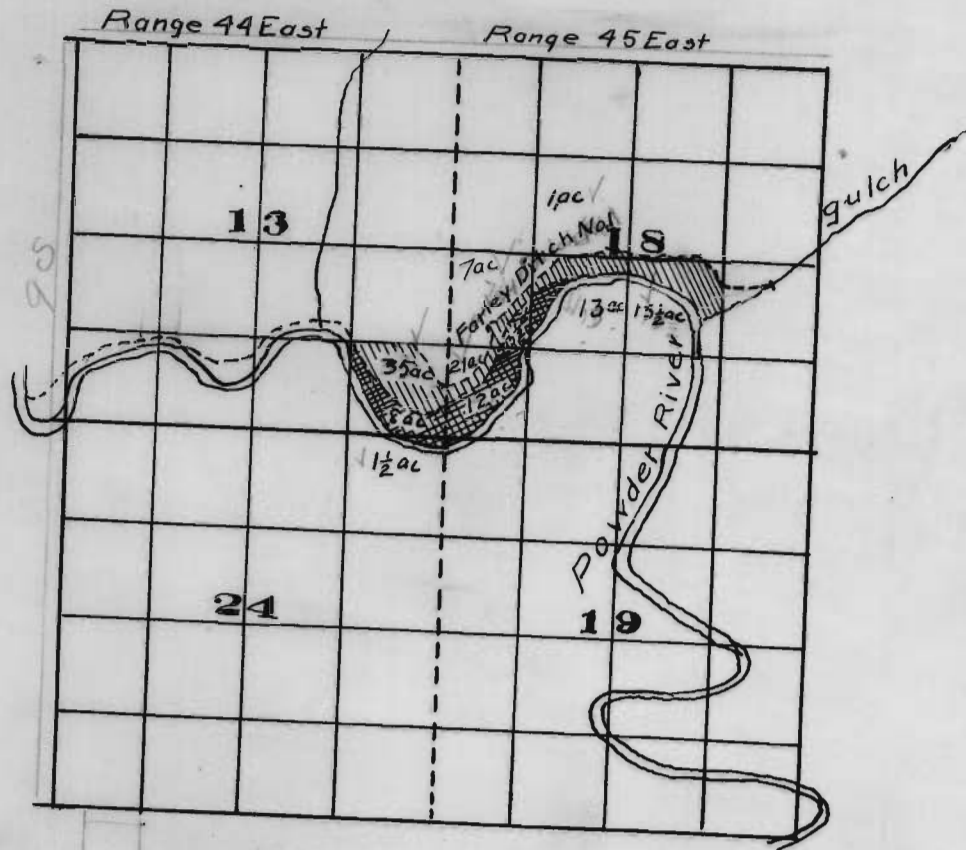

OFFICE OF STATE ENGINEER

RECEIVED

DEC 23 1911

SALEM, OREGON

Application No. 1857
Permit No. 993

Land to be irrigated

Land having partial water-right
from Powder River