

TOWNSHIP 41S, RANGE 13W, W. M.

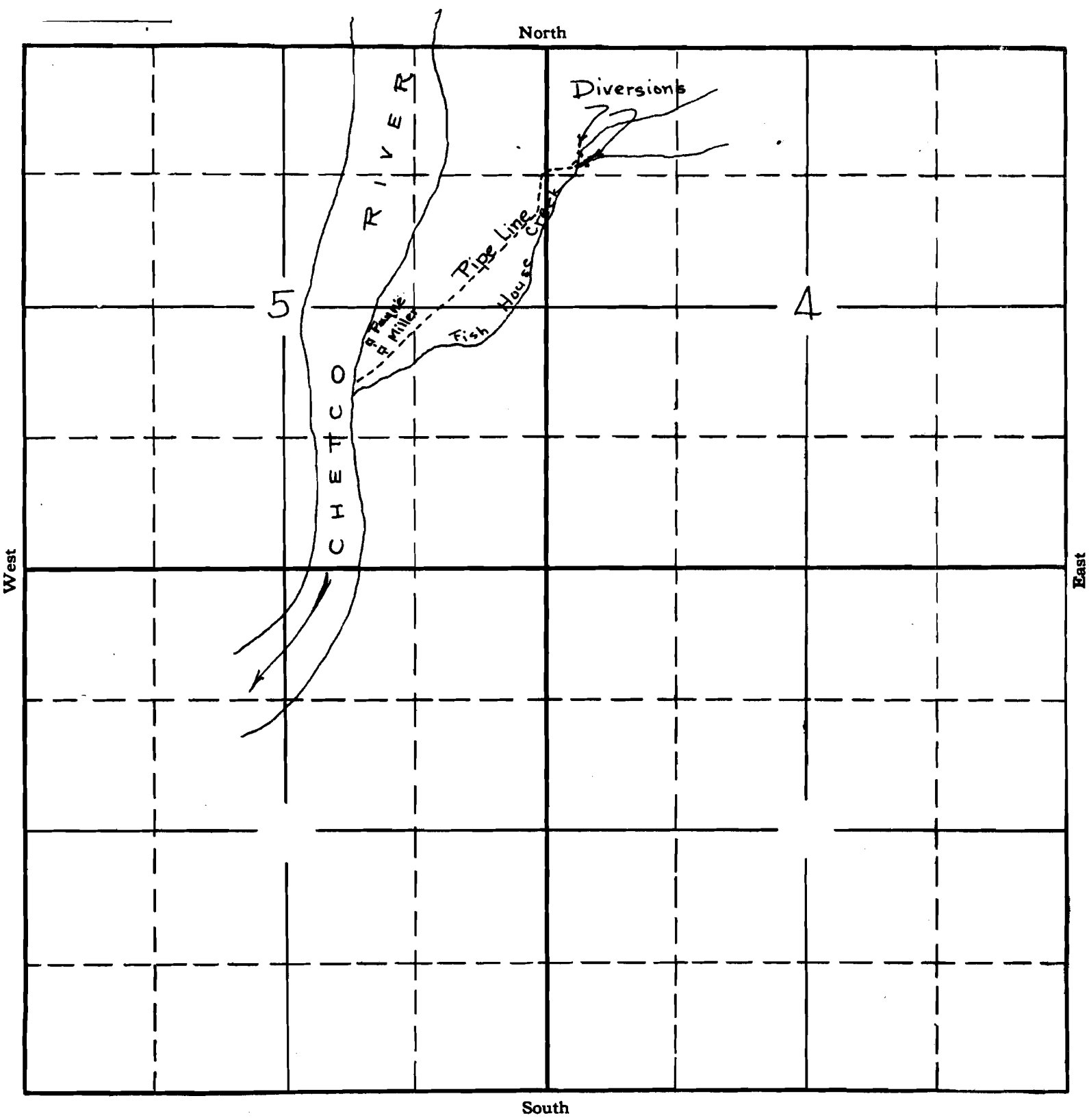

APPLICATION No. 13612
PERMIT No. 9933

T.41S. R.13W. W.M.

4" = 1 mile

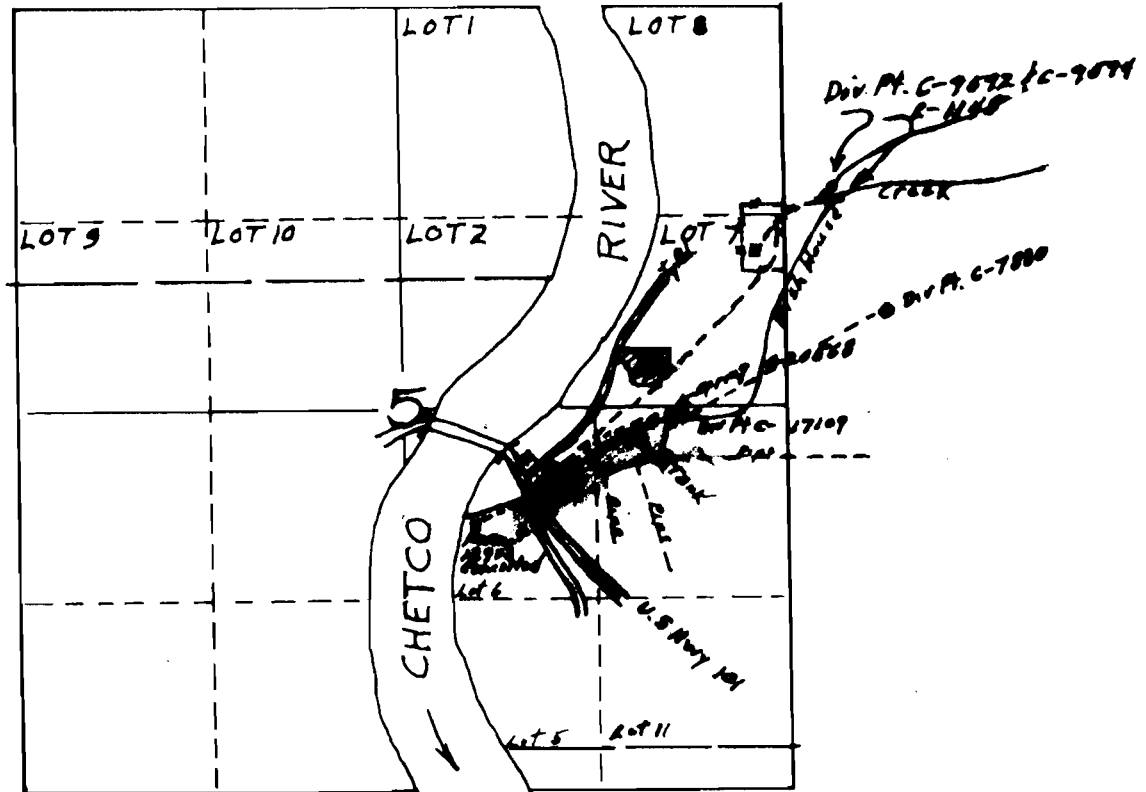

File #	Certificate	Source	Quantity	Use	Priority	Applicant
3354	1145	Fish House Cr.	0.1 cfs	Domestic	12-19-1913	Ernest Stitt
11111	7880	Spring Branch	0.1 cfs.	Domestic	9-22-1926	J.R. Hill
13612	9592	Fish House Cr.	0.02 cfs.	Domestic	8-4-1930	Payne & Miller
13904	9594	Fish Creek ^{E.FK} W.FK	0.02 cfs 0.01 cfs	Domestic	1-6-1931	Fred Kinkey
21233	17109	Fish House Cr.	0.01 cfs.	Irrig. 1/2 Ac.	10-10-1945	Harriet Stitt
27577	20568	A Spring	0.015 cfs	Dam ^{store} & House	8-22-1952	E.E. Hanson
27578	20571	Fish House Cr.	0.019 cfs	Irrig 1 1/2 Ac.	8-22-1952	E.E. Hanson

26905 - Permit 12903 Fish House Cr. 0.010 cfs Dam - 20 Families 12-30-1937 Floyd Clark Councilman 4-7-92

This listing of rights may or may not be complete but is intended to help identify those rights involved in distribution questions in 1963. WNP