

MAP
 TO ACCOMPANY APPLICATION FOR A PERMIT
 TO APPROPRIATE THE UNDERGROUND WATERS
 OF THE STATE OF OREGON

RILEY & SEWELL

APPLICANTS

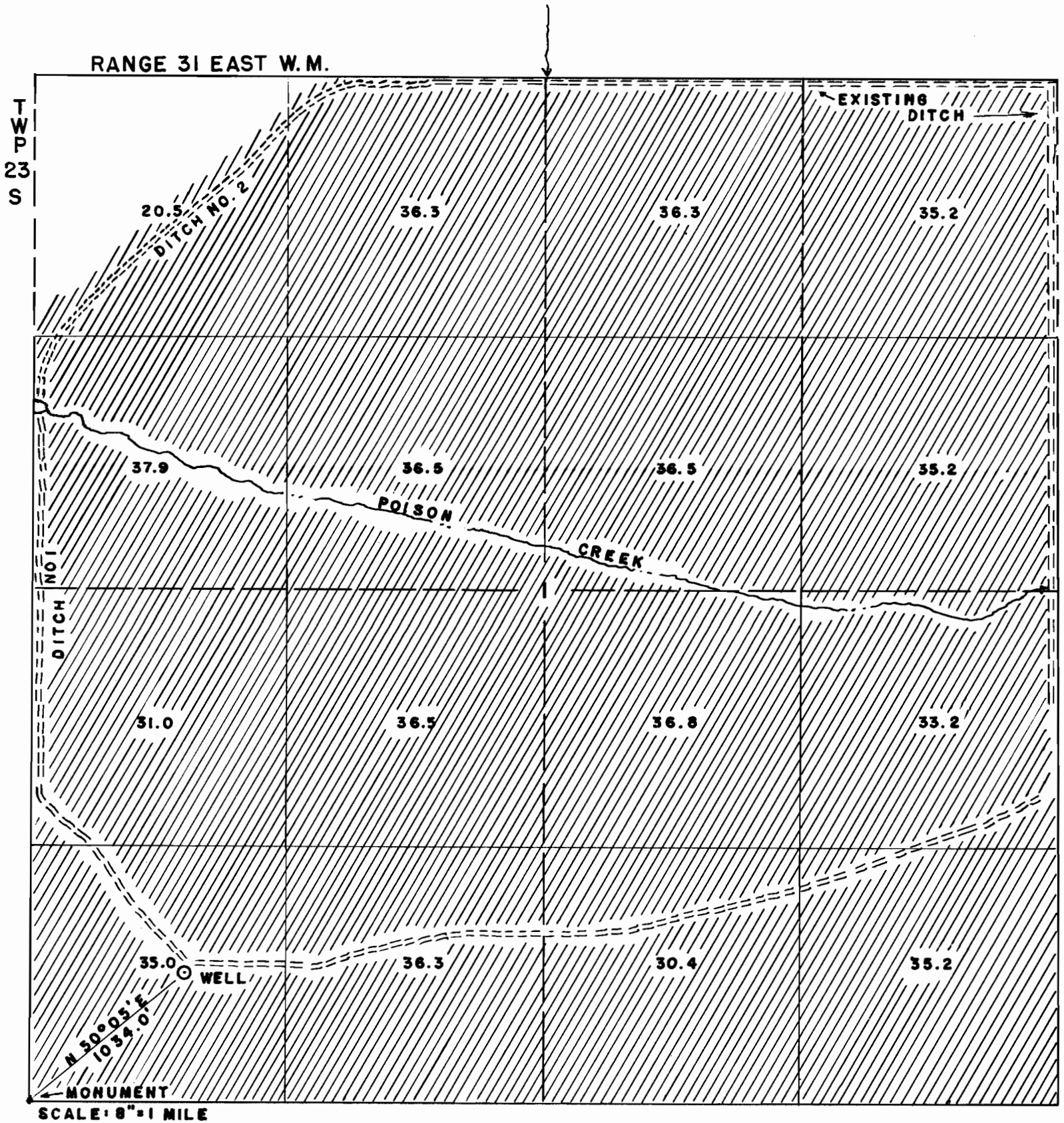

I, Paul R. Revis of Burn, Oregon, do hereby certify that this map was made from notes taken during an actual survey made by me on August 16-18, 1948; that the monument shown on this map consisting of a 1" iron pipe is at the SW Corner of Section 1, Township 23 S., Range 31 East W.M.

Paul R. Revis
 Registered Professional Engineer.

U-285
 U-285

Oregon License No. 2511