

Application for a Permit Ammdement

Permit G-11831 (Application G-12870)

Township 1 South, Range 1 East (W.M.)

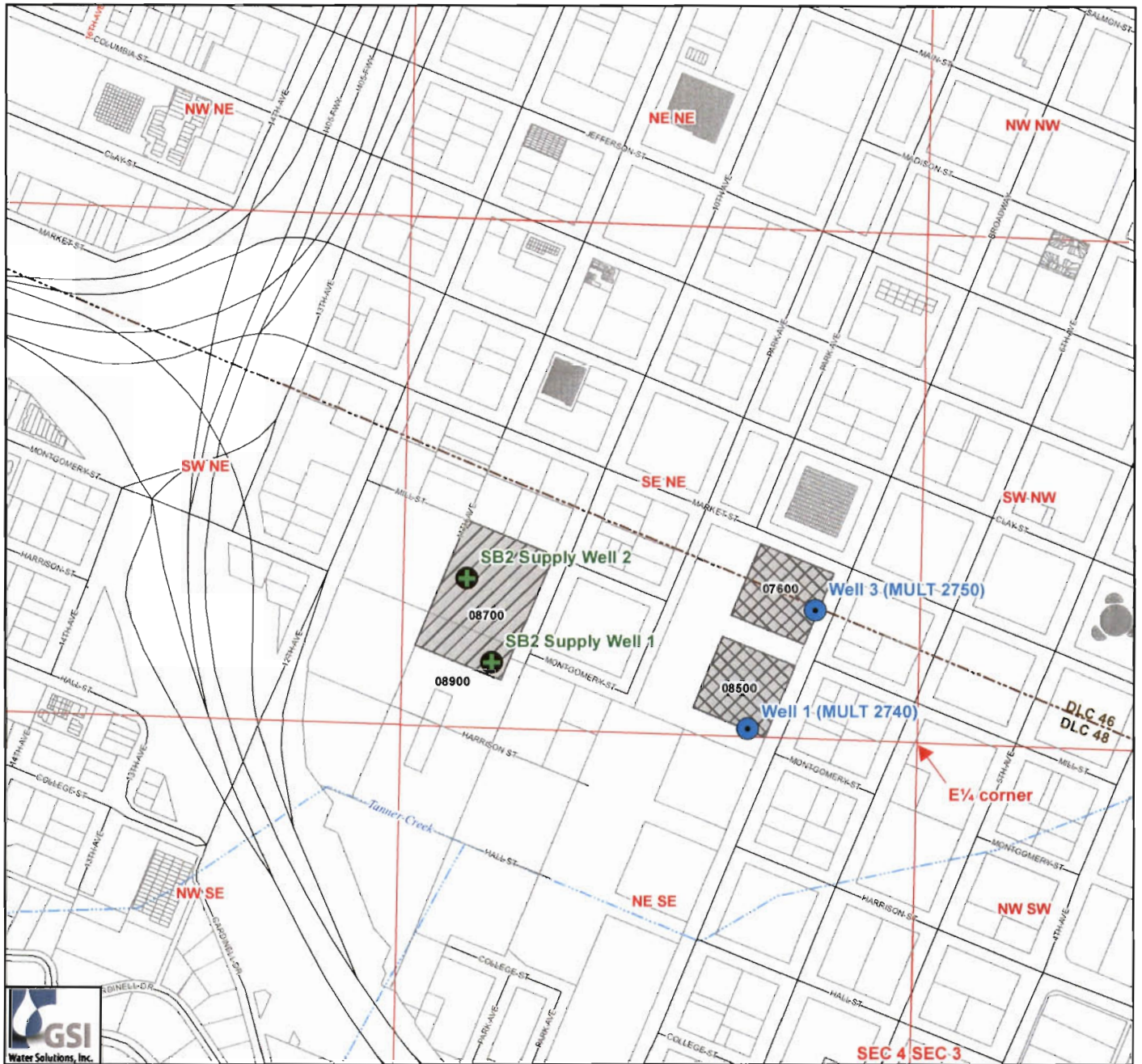

Legend

- Authorized Point of Appropriation (POA)
- Proposed Additional Points of Appropriation (POA)
- Current Place of Use (POU)
- Proposed Place of Use (POU)
- DLC
- Taxlots
- Roads
- Watercourses



0 100 200 400
1 Inch Equals 400 Feet

T 11112

RECEIVED

JUL 26 2010

WATER RESOURCES DEPT
SALEM, OREGON

Map Information

Map Projection: Oregon State Plane North
Map Datum: North American Datum of 1983
Map Date: January 26, 2010
Data Sources: METRO, Multnomah County, OWRD

Note
This map was prepared for the purpose of identifying the location of a water right only and it is not intended to provide legal dimensions or location of property ownership lines.

POA Legal Description

- Authorized POA (Well 1)**
Located 23 feet North and 433 feet West from the East quarter corner of Section 4, Township 1 South, Range 1 East
- Authorized POA (Well 3)**
Located 335 feet North and 268 feet West from the East quarter corner of Section 4, Township 1 South, Range 1 East
- Proposed Additional POA (SB2 Supply Well 1)**
Located 169 feet North and 1,091 feet West from the East quarter corner of Section 4, Township 1 South, Range 1 East
- Proposed Additional POA (SB2 Supply Well 2)**
Located 392 feet North and 1,148 feet West from the East quarter corner of Section 4, Township 1 South, Range 1 East