

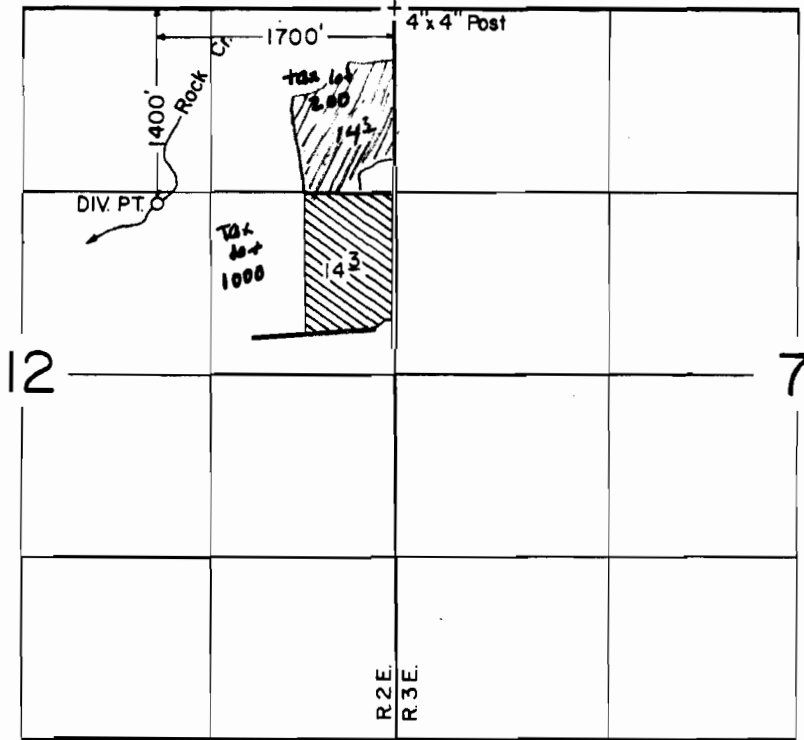

T. 2 S. R. 2 & 3 E., W.M.



SCALE: 1" = 1320'

FINAL PROOF SURVEY
UNDER

Application No. 58832, Permit No. 44666.....
IN NAME OF

.....LEE SCHWEIZER.....

Surveyed AUG. 27, 1986, by T. WARREN.....

RECEIVED

AUG 02 2010

WATER RESOURCES DEPT
SALEM, OREGON

T 11114