



State of Oregon  
Water Resources Department  
725 Summer Street NE, Suite A  
Salem, Oregon 97301-1266  
(503) 986-0900

# Application for Instream Lease

A summary of review criteria and procedures that are generally applicable to these applications is available at [www.wrd.state.or.us/OWRD/PUBS/forms.shtml](http://www.wrd.state.or.us/OWRD/PUBS/forms.shtml).

### Pursuant to ORS 537.348(2) and OAR 690-077

Optional Identification by Lessor/Lessee: \_\_\_\_\_  
Lease Application Number (assigned by WRD): 11-1091

This Lease is between:

**Lessor #1:**

Name Charles Leibelt  
Mailing address 1003  
NE Division ST  
City, State, Zip Code Myrtle Creek, OR 97457  
Telephone number 541.404.2854  
Email address CLeibelt@charter.net

**Lessor #2, 3, etc.**

\_\_\_\_\_

The water right to be leased is located in \_\_\_\_\_ County.

RECEIVED

AUG 06 2010

**Lessee (if different than Oregon Water Resources Department):**

Name \_\_\_\_\_  
Mailing address \_\_\_\_\_  
City, State, Zip Code \_\_\_\_\_  
Telephone number \_\_\_\_\_  
Email address \_\_\_\_\_

OWRD RECEIVED  
AUG 10 2010

**Trustee:**

Oregon Water Resources Department  
725 Summer Street NE, Suite A  
Salem, OR 97301-1266  
(503) 986-0900

### ~I~ Water Right Holder and Water Right Information

- 1.1 Lessor #1 is the water right holder, or authorized agent for water right holder of the property located at: Township 28 S Range 12 W, Section 25, 30 & 31 and Tax Lot number \_\_\_\_\_. If the water right appurtenant to these lands is also appurtenant to lands owned by others who are not included in this application, then Attachment 1 (tax lot map), needs to be included.

- 1.2 Lessor #2 is the (Check one):  
 Not applicable  
 Official representative of \_\_\_\_\_, the irrigation district which conveys water to the subject water rights.  
 Another party with an interest in the subject water rights representing \_\_\_\_\_.

- 1.3 For the water right(s) being leased, list all water rights appurtenant to the same lands. Indicate if there are any supplemental or overlying rights.

Certificate No. \_\_\_\_\_

- 1.4 Are some or all of the lands being leased part of a Conservation Reserve Enhancement Program.  Yes  No

**1.5 Water Rights Proposed to be Leased Instream.**

The first right to be leased identified in Section 1.3 is further described as follows:

Certificate No.: 66576

Priority date: 1/18/1974 Type of use: Irrigation

Legal Season of Use: \_\_\_\_\_

Is the entire water right certificate being leased?  Yes  No

**If no**, list the acres of the subject water right by legal description of township, range, section, and ¼ ¼ which will be dried up as part of this lease, and include a map (Attachment 2) showing the lands which will not receive water.

Place of use: T \_\_\_\_, R \_\_\_\_, Section \_\_, ¼ ¼ - \_\_\_\_\_ acres to be leased

Enter additional places of use here, using format above:

\_\_\_\_\_

Page \_\_\_\_\_ (Identify page number of certificate, if certificate is greater than 10 pages.)

Number of acres being leased, if for irrigation: 192.4

Acre-feet of storage, if applicable: \_\_\_\_\_

Maximum rate associated with the right to be leased (cfs): 2.4

(Use additional lines if there is more than one rate associated with the water right.)

Maximum duty associated with the right to be leased (ac-ft): 481

(Use additional lines if there is more than one duty associated with the water right.)

Conditions or other limitations, if any: \_\_\_\_\_

If you need to enter another leased right, please use the additional water rights form.

**1.6 Validity of rights.** Lessor(s) attests (mark one) that:

- the water has been used over the past five years according to the terms and conditions of the water right certificate or as an instream water right or  
 the water has not been used over the past five years according to the terms and conditions of the water right certificate, however the water right is not subject to forfeiture under ORS 540.610(2)(  )(include necessary supporting documentation as Attachment 3).

RECEIVED  
AUG 06 2010  
WATER RIGHTS DIVISION  
BUREAU OF LAND MANAGEMENT

**~II~ Instream Water Right Information**

**2.1 Public use.** This lease will increase streamflows that will benefit:

- Conservation, maintenance and enhancement of aquatic and fish life, wildlife, and fish and wildlife habitat
- Pollution abatement
- Recreation and scenic attraction

**2.2 Instream use created by lease.** The instream use to be created is described as follows:

Coquille River

Tributary to Pacific Ocean in the South Coast Basin.

Describe the point of diversion (POD) and any associated reach(es) of the instream use being created. If possible list the reach by river mile. If no reach is identified, and there is only one POD listed on the certificate, the lease may be processed to be protected at the POD. (If more than one POD is listed on the certificate, then the POD and any associated reach(es) must be identified): From the POD to the Mouth of Coquille River

Maximum volume in acre-feet: 481

Rate in cfs: 2.4

(Use the section below to indicate a more restrictive period of use than allowed by the water right.)

730947  
AUG 06 2010

**Conditions to prevent injury, if any:**

- None
- The instream flow will be allocated on a daily average basis up to the described rate from \_\_\_\_ through \_\_\_\_.
- Other (describe): \_\_\_\_\_

1787-2501-0132-47  
JUL 27 2010

If you need to enter more instream uses, please use the additional water rights form.

**2.3 Term of lease.** This lease shall terminate on October 31, 2014.

**2.4 Flow protection.** The Trustee will regulate use of water from the source, subject to prior appropriation and the agency enforcement guidance, to assure the water is delivered to the point of diversion, and through the reach past junior downstream users, so long as flow is sufficient to meet the demand under priority date of the new instream use (see Section 2.2). As part of regulation activities the watermaster or a designee has access to the point of diversion and place of use for the water rights involved in this lease. No party is required to continuously measure the flow of the waterway described in Section 2.2.

**~III~ Other Information**

**3.1 Accuracy.** The Undersigned Lessor(s) and Lessee(s) declare that, to the best of their knowledge and belief, the information contained in this application is true, correct and complete. If after the lease order is signed, any information is determined to be false, the lease order may be modified or terminated. The lease only exercises the water rights being leased, for the term of the lease. It shall not be construed to overcome any claim that the water right may otherwise be subject to forfeiture for nonuse pursuant to ORS 540.610 during the period of time prior to the execution of the lease.

- 3.2 Lease.** Lessor(s) and Lessee(s) agree to lease the water rights listed in Section(s) 1.5 for instream use for the term of this lease through Lessee to the Trustee, the Oregon Water Resources Department, pursuant to the provisions of ORS 537.348(2) and OAR 690-077.
- 3.3 Precedent.** If a right which has been leased is later proposed to be leased again or transferred to an instream use under ORS 537.348 and OAR 690-077 a new injury review shall be required, and a prior lease shall not set a precedent for the amount of water to be leased or transferred instream.
- 3.4 Suspension of original use.** During the period of the lease, the water right holder agrees to suspend use of water allowed under the subject water rights and under any water right that is supplemental to the subject water rights.
- 3.5 Termination provision.**
- For multiyear leases, the Lessor(s) shall have the option of terminating the lease each year with written notice to the Department. The lease may be terminated at any time during the calendar year. However, if the termination request is received less than 30-days prior to the period of allowed instream use or after the period of allowed use has begun for the water right(s) being leased, water may not be used under the right(s) leased until the following calendar year, unless the Director determines that enlargement would not occur. The Department may also require:
    - Written notice to the Department with original signatures;
    - Consent by all parties to the lease; and/or
    - Written notice to the Watermaster's office.
  - For multiyear leases, the lessor shall not have the option of terminating the lease, without consent by all parties to the lease.
- 3.6 Modification to prevent injury.** Allocation of water to the instream use described in Section 2.2 during the term of this lease is not reasonably expected to cause injury to other rights to use water from the same source. If injury is found after this lease is signed, the lease may be modified or terminated to prevent injury.
- 3.7 Fees.** Pursuant to ORS 536.050, the following fee is included:
- \$400 for an application with four or more landowners or four or more water rights.
  - \$250 for all other applications.

Lessor #1: Charles J. Seibelt Date: 5 Aug. 2010

For additional Lessors, type in space for signature and date

Lessee: \_\_\_\_\_ Date: \_\_\_\_\_

REGISTERED  
AUG 06 2010  
WATER RESOURCES DEPARTMENT  
ASST. DIR. OF WATER

Other Attachments as Needed:

Attachment 1: Tax Lot Map. (See instructions.)

Attachment 2: Detailed map illustrating lands under subject rights to be leased; required if only part of a right is being leased instream. (See instructions.)

Attachment 3: Supporting documentation indicating why a right is valid and not subject to forfeiture even though the right has not been exercised for five or more consecutive years (required if the second box in Section 1.6 is checked).

Attachment 4: Split Season Instream Use Form

RECEIVED

AUG 06 2010

WATER RESOURCES DEPT  
3000 N. GAVIN

# T. 28S., R.12 &13 W., W.M.

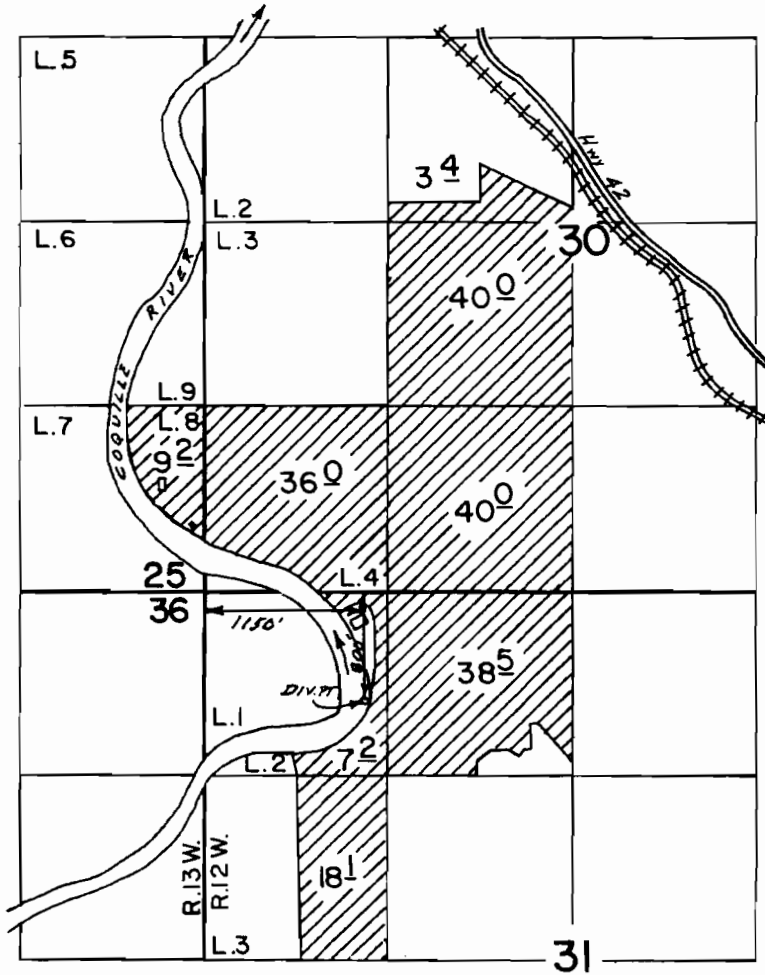

Scale 1"=1320'

## FINAL PROOF SURVEY UNDER

Application No. 51616... Permit No. 38931.....  
IN NAME OF

CHARLES J. & MABEL V. LEIBELT

Surveyed Oct. 10, 1983, by L.E. CASHION

COPIED

AUG 08 2010

REGISTERED SURVEYOR  
MAY 1982

STATE OF OREGON  
COUNTY OF COOS  
CERTIFICATE OF WATER RIGHT

THIS CERTIFICATE ISSUED TO

CHARLES J. AND MABEL V. LEIBELT  
BOX 55  
NORWAY, OR 97460

confirms the right to use the waters of THE COQUILLE RIVER, a tributary of PACIFIC OCEAN, for IRRIGATING 192.4 ACRES.

This right was perfected under Permit 38931. The date of priority is JANUARY 18, 1974. This right is limited to 2.4 CUBIC FEET PER SECOND or its equivalent in case of rotation, measured at the point of diversion from the source.

The point of diversion is located as follows:

LOT 2 (NW 1/4 NW 1/4), SECTION 31, T 28 S, R 12 W, W.M.; 800 FEET SOUTH AND 1150 FEET EAST FROM THE NORTHWEST CORNER OF SECTION 31.

The amount of water used for irrigation together with the amount secured under any other right existing for the same lands, is limited to a diversion of ONE-EIGHTIETH of one cubic foot per second (or its equivalent) and 2.5 acre-feet for each acre irrigated during the irrigation season of each year.

The use shall conform to such reasonable rotation system as may be ordered by the proper state officer.

A description of the place of use to which this right is appurtenant is as follows:

LOT 8 (SE 1/4 SE 1/4)	9.2 ACRES
SECTION 25	
TOWNSHIP 28 SOUTH, RANGE 13 WEST, W.M.	
SE 1/4 NW 1/4	3.4 ACRES
NE 1/4 SW 1/4	40.0 ACRES
LOT 4 (SW 1/4 SW 1/4)	36.0 ACRES
SE 1/4 SW 1/4	40.0 ACRES
SECTION 30	
NE 1/4 NW 1/4	38.5 ACRES
LOT 2 (NW 1/4 NW 1/4)	7.2 ACRES
LOT 3 (SW 1/4 NW 1/4)	18.1 ACRES
SECTION 31	
TOWNSHIP 28 SOUTH, RANGE 12 WEST, W.M.	

The right to the use of the water for the above purpose is restricted to beneficial use on the lands or place of use described. The use confirmed herein may be made only at times when sufficient water is available to satisfy all prior rights, including rights for maintaining instream flows.

WITNESS the signature of the Water Resources Director, affixed AUGUST 12, 1991.

/s/ WILLIAM H. YOUNG

William H. Young

Recorded in State Record of Water Right Certificates numbered 66576.

51616.LMJ

RECORDED

AUG 06 2001

WATER RESOURCES DEPT  
3/17/01